

①

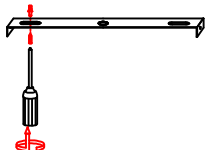

Product Name: Wall Lamp

Item No.:39457

Light Source: 3000K

Installation Steps :

1. Install the ceiling-mount plate on the ceiling by using screws as drawing ① showing.
2. Connect the electronic wire as drawing ② showing.
3. Install the ceiling pan with the wall-mount plate on the ceiling by using screws as drawing ③ showing.

②

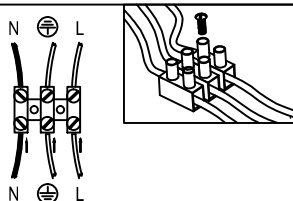

③

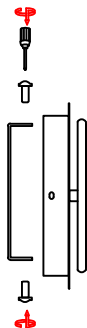

④

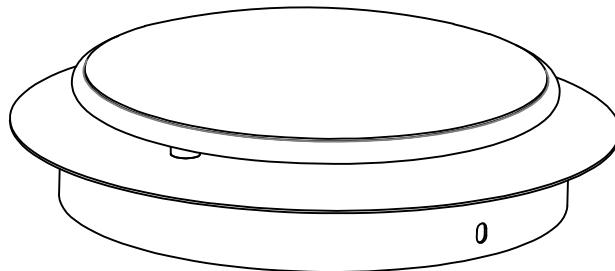
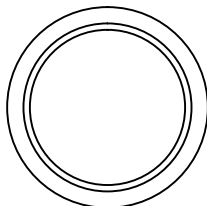

Cautions:

1. The electronic wire should be changed if it is damaged.
2. The installation and maintain must be done by professional worker.