

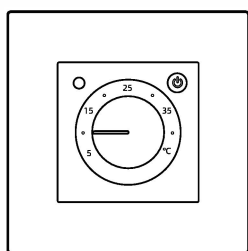

## Electronic Heating Thermostat Grand Meyer MST-9 (MST-9i, MST-9n)



### Installation Instructions



Please scan the QR code to access the product manual, videos, and other related information.

This electronic thermostat is designed for installation in a standard wall box. It allows for adjustable temperature settings ranging from 5°C to +45°C. The illuminated LED indicates that the heating is active. This thermostat is recommended for controlling electric heating devices. The thermostat can be installed into a wall faceplate with an inner dimension of 46 x 46 mm or 56 x 56 mm thru adapter which includes in the kit.

### Technical Data

Voltage	AC 230V ±10%, 50–60Hz
Power Consumption	4 W MAX
Setting Range	5–45 °C
Ambient Temperature	–5–50 °C
Protection level	IP20
Housing Material	Flame-retardant PC
Switching Deviation	±1 °C
Temperature Sensor	Sensor lead wire length: 3m

### Dimension

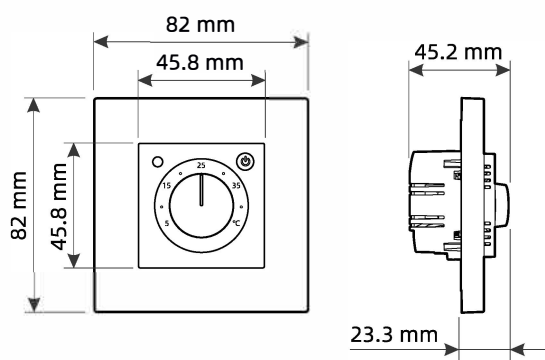

### Operation Manual

- 1 Power on/off
- 2 Temperature Setting: From +5°C to +45°C
- 3
  - When the device is turned on, the indicator light turns green.
  - When heating is activated, the indicator light turns red.

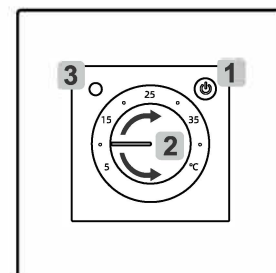

### Temperature Setting

The thermostat operates within a temperature range of 5°C to 45°C.

To adjust temperature:

- Clockwise rotation: Increases set temperature
- Counterclockwise rotation: Decreases set temperature

### Mounting of Floor Sensor

The temperature sensor is to be installed in the middle between the loops of the heating cable, at a distance of 40–50 cm from the edge of the heating circuit, near the location of the thermostat installation.

Use a separate cable suitable for power current applications. Do not use conductors from a multi-conductor cable that is also supplying power to the heating cable. This may cause voltage interference that could disrupt thermostat function.

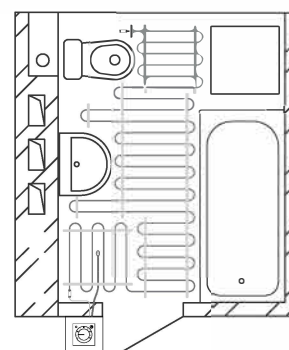

### Temperature and Value of Floor Sensor

Temperature (°C)	Value (Ω)
5	22265
10	18074
20	12117
30	8302
40	5809



## Device Installation

### ⚠ Notice:

This instruction and connection diagram do not replace the professional training of the installer. We recommend using the services of qualified specialists for the installation of the thermostat and heating system. Electrical connections and the connection of the device to the power supply should be performed by a qualified electrician. All installation and connection work should be carried out with the power supply turned off.

1. Remove the casing away from the panel.

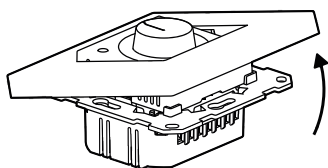

2. Please connect the wires to the corresponding terminals according to the following wiring diagram (recommended strip length 5~7 mm), then tighten the screws to secure.

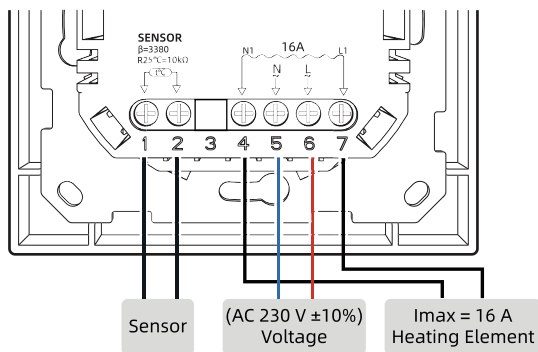

**Important:** An external temperature sensor must be connected for proper device operation. The indicator LED will flash green if no sensor is detected.

3. Once the wiring is done, use two screws to attach the back cover to the wall box.

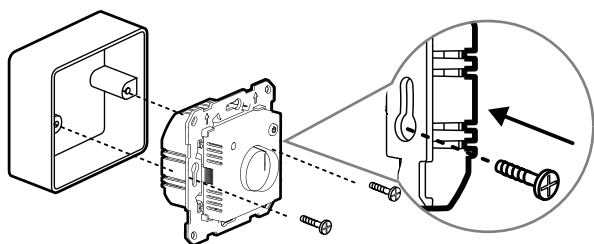

4. Confirm the position of the device buckle.

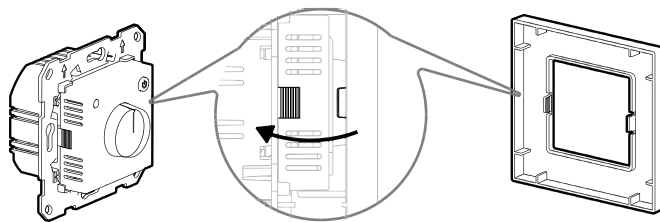

5. Align the casing frame with the panel clips, snap the panel into place, and complete the installation.

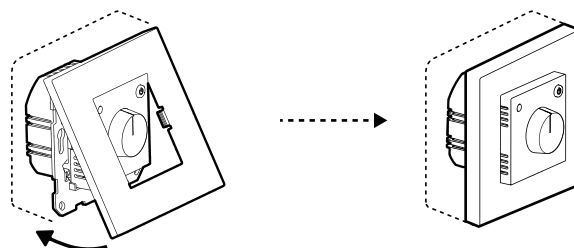

## Disposal of Obsolete Equipment



Devices with this marking must not be disposed of with regular waste. They should be collected separately and disposed of in accordance with local regulations.

## Warranty Obligations

The warranty period is 24 months from the date of sale. During the warranty period, the buyer has the right to repair or replace the product if any faults are discovered that have occurred through the fault of the manufacturer and provided that the instructions for installation and operation are followed. Warranty obligations do not apply to temperature controllers that have mechanical damage, as well as if the defect has arisen as a result of improper installation, connection and operation of this device.