



Meaningful Innovation.

WEEE Number: 80133970

INSTRUCTION MANUAL

WALL LAMP FITTING

TECHNICAL DATA

MODEL	VT-81040
SKU	24088
MAX WATTS	60W
IP RATING	IP44
HOLDER	E27 [Bulb not included]
BODY TYPE	Aluminium + Glass
UNIT COLOR	Matt Black
INPUT VOLTAGE	AC:220-240V, 50/60Hz
DIMENSION	135x100x230mm



02 YEAR
WARRANTY*

INTRODUCTION & WARRANTY

Thank you for selecting and buying V-TAC product. V-TAC will serve you the best. Please read these instructions carefully before starting the installation and keep this manual handy for future reference. If you have any another query, please contact our dealer or local vendor from whom you have purchased the product. They are trained and ready to serve you at the best. The warranty is valid for 2 years from the date of purchase. The warranty does not apply to damage caused by incorrect installation or abnormal wear and tear. The company gives no warranty against damage to any surface due to incorrect removal and installation of the product. This product is warranted for manufacturing defects only.



This marking indicates that this product should not be disposed of with other household wastes.

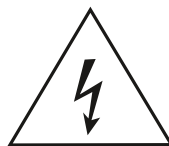

Caution, risk of electric shock.

WARNING

- Please make sure to turn off the power before starting the installation.
- Installation must be performed by a qualified electrician.
- Proper grounding should be ensured throughout the installation.
- User should prepare necessary accessories and spare parts (Not Provided)
- For Indoor Use only

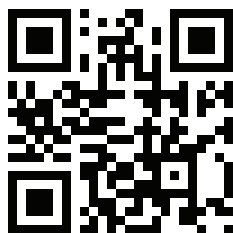

MULTI-LANGUAGE MANUAL QR CODE

Please scan the QR code to access the manual in multiple languages.



Points de collecte sur www.quefairedemesdechets.fr
Privilégiez la réparation ou le don de votre appareil !

INSTALLATION DIAGRAM

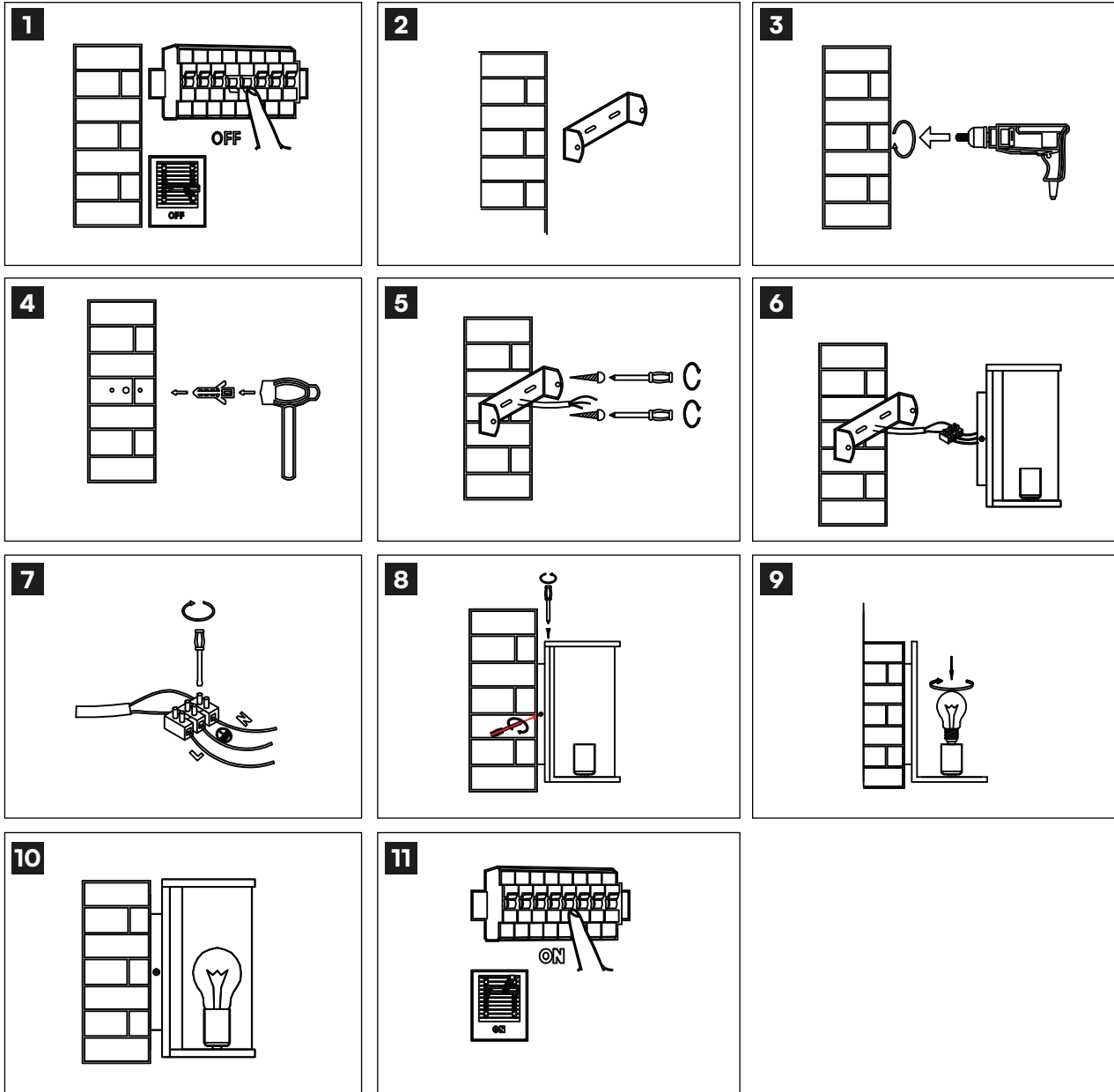

INSTALLATION INSTRUCTIONS

1. Turn off the power.
2. Align and prepare the mounting bracket.
3. Mark and drill holes using the bracket as a guide.
4. Insert provided wall anchors into the drilled holes.
Secure the bracket using screws.
5. Connect the wires correctly, brown (L) to brown, blue (N) to blue, and green/yellow (\oplus) to green/yellow.
6. Attach the fixture to the mounting bracket.
7. Install the correct light bulb.
8. Turn on the power and test the light.



V-TAC WEST EUROPE LTD. IN CASE OF ANY QUERY/ISSUE WITH THE PRODUCT, PLEASE REACH OUT TO US AT: SUPPORT@V-TAC.EU
FOR MORE PRODUCTS RANGE, INQUIRY PLEASE CONTACT OUR DISTRIBUTOR OR NEAREST DEALERS.
V-TAC WEST EUROPE LTD. GROUND FLOOR, 71 LOWER BAGGOT STREET, DUBLIN 02, IRELAND D02 P593

V-TAC UK LTD. IN CASE OF ANY QUERY/ISSUE WITH THE PRODUCT PLEASE REACH OUT TO US AT
SUPPORT@VTACEXPORTS.COM V-TAC, 5A TUNGSTEN PARK, DOWNS ROAD, WITNEY, OXFORDSHIRE, OX29 0AX