

AIYAPLAY

IN250700397V01_UK_FR_DE_ES_IT

370-449V00

PEDAL GO-KART / KART À PÉDALES / PEDAL-GOKART / KARTING DE PÉDALES / GO-KART A PEDALI

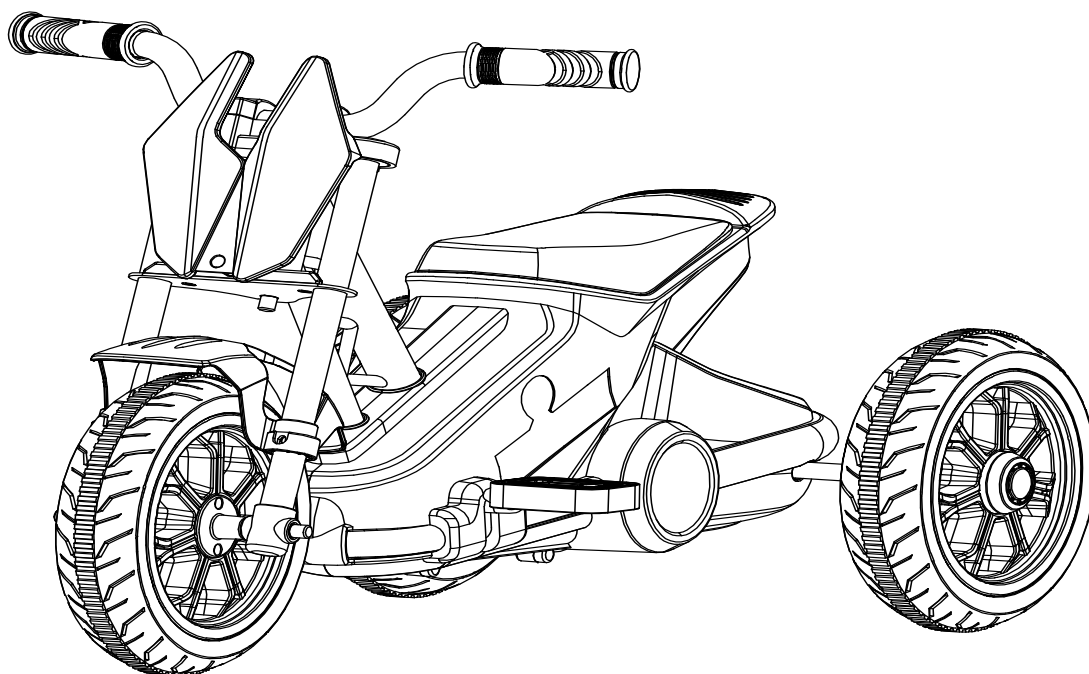

EN: WARNING: Not suitable for children under 1 years old; Max weight: 30 kg.

DE: ACHTUNG: Nicht geeignet für Kinder unter 1 Jahren; Max. Gewicht: 30 kg.

FR: ATTENTION: Ne convient pas aux enfants de moins de 1 ans; Poids maximum : 30 kg.

ES: ADVERTENCIA: No apto para niños menores de 1 años; Peso máximo: 30 kg.

PT: ADVERTÊNCIA: Não é adequado para crianças menores de 1 anos; Peso máximo: 30 kg.

IT: AVVERTENZA: Non adatto a bambini sotto i 1 anni; Peso massimo: 30 kg.

EN_IMPORTANT, RETAIN FOR FUTURE REFERENCE: READ CAREFULLY.

**FR_IMPORTANT : A LIRE ATTENTIVEMEN ET A CONSERVER POUR VOUS Y REFERER
ULTERIEUREMENT**

ES_IMPORTANTE, LEA Y GUARDE PARA FUTURAS REFERENCIAS.

DE_WICHTIG! SORGFÄLTIG LESEN UND FÜR SPÄTER NACHSCHLAGEN AUFBEWAHREN.

**IT_IMPORTANTE! CONSERVARE IL PRESENTE MANUALE PER FUTURO RIFERIMENTO E
LEggerlo ATTENTAMENTE.**

Parts List (included)

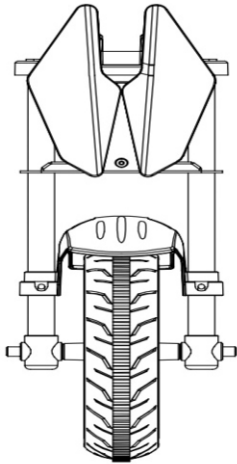

1. Head end *1

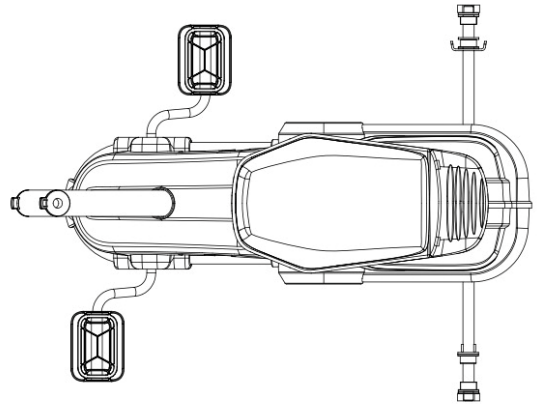

2. Back frame *1

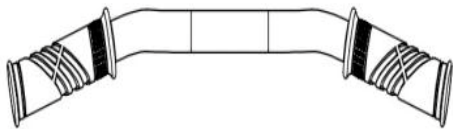

3. Handle *1

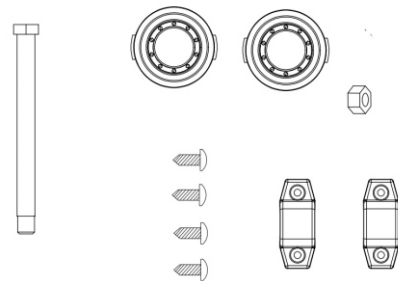

4. Bag of screw *1

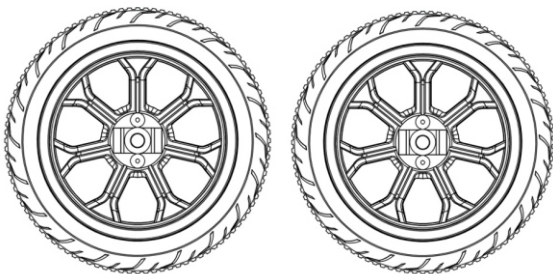

5. Wheel *2

Page 1

PEDAL GO-KART

Operating Instructions
and Assembly Manual

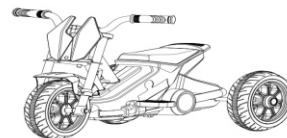

Execution Standard: EN71-1, -2, -3

Please read this manual carefully before use

Caution: For correct and safe operation of this product,
be sure to read this instruction manual carefully before use.
Please retain this user manual for future reference.

6. Manual

Assembly Instructions:

1. Fix the wheel at the top of the shaft, as pictures

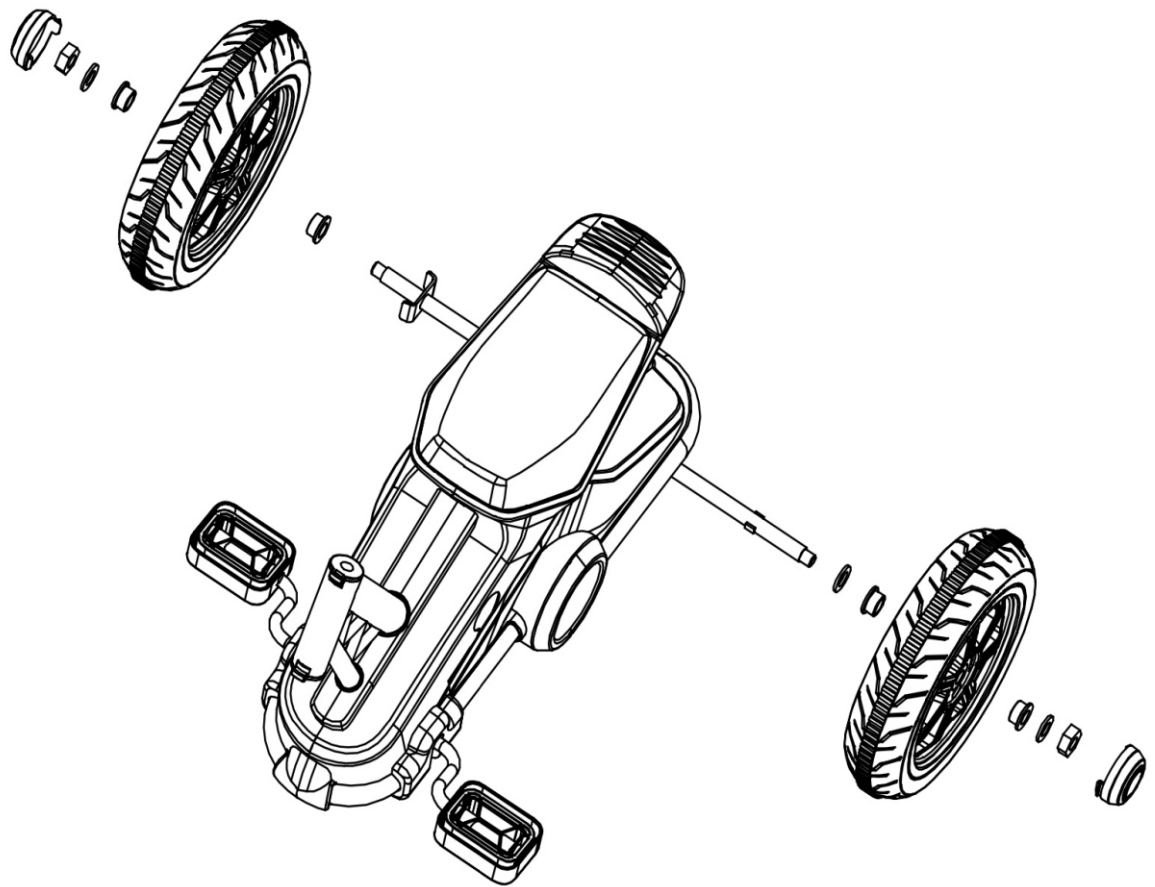

2. use the screw to link the head end and back frame, tighten with the nut

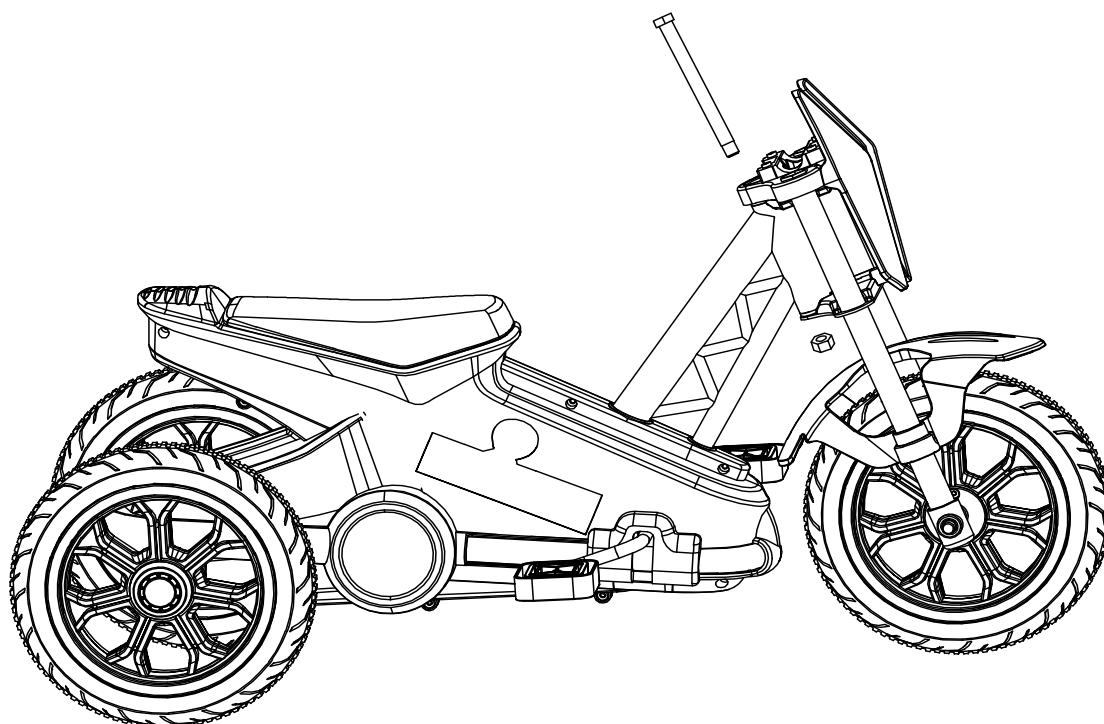
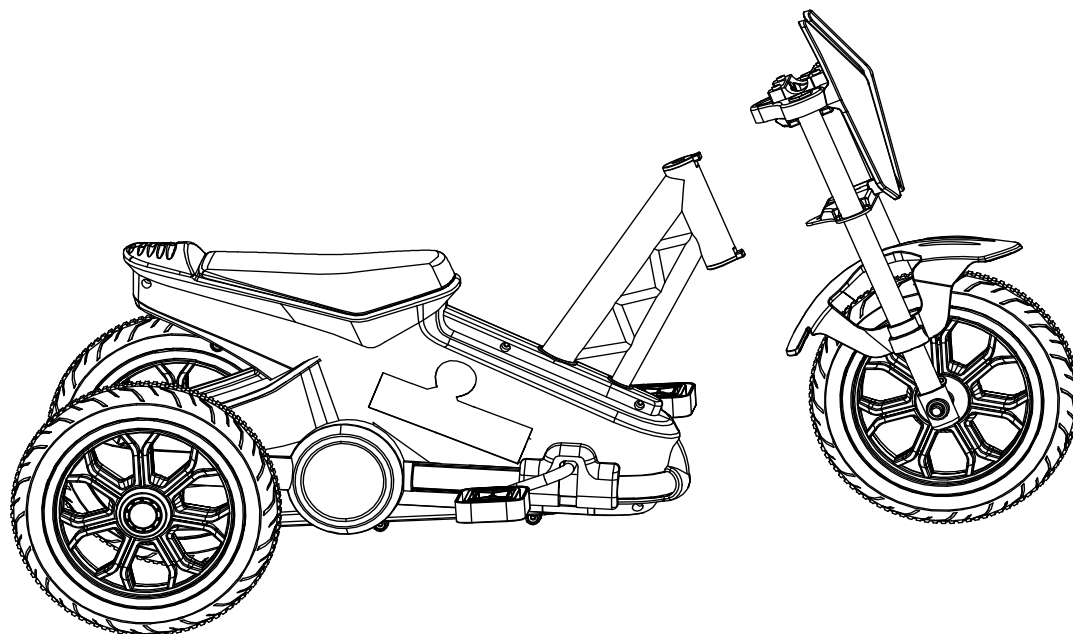

3. Fix the handle to the frame of the Vehicle.
tighten with M4*12 screw,ensure to use fixed plastic parts again where appropriate.

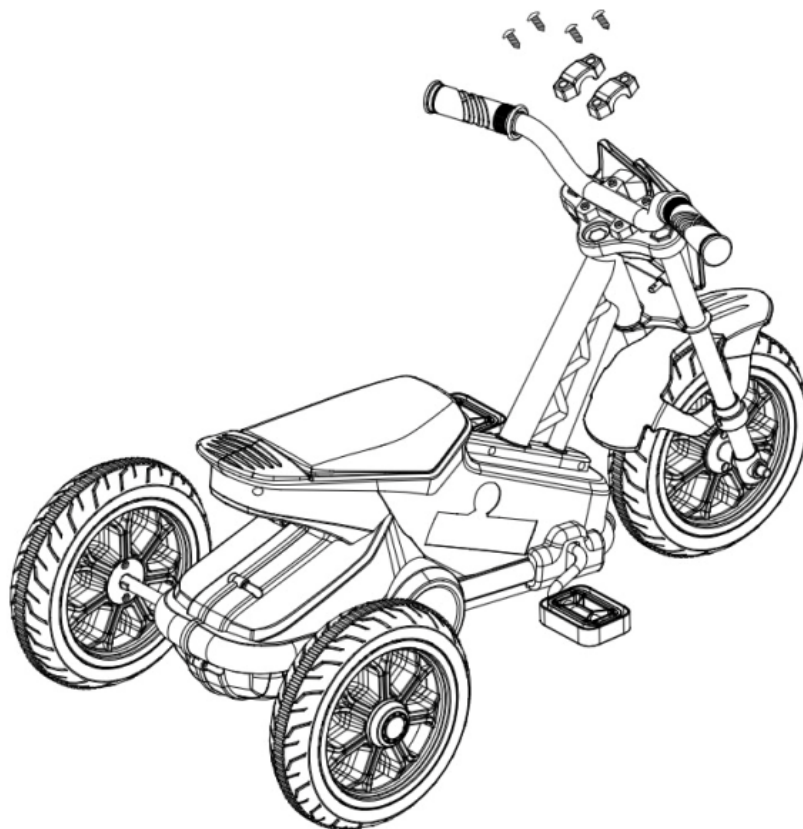
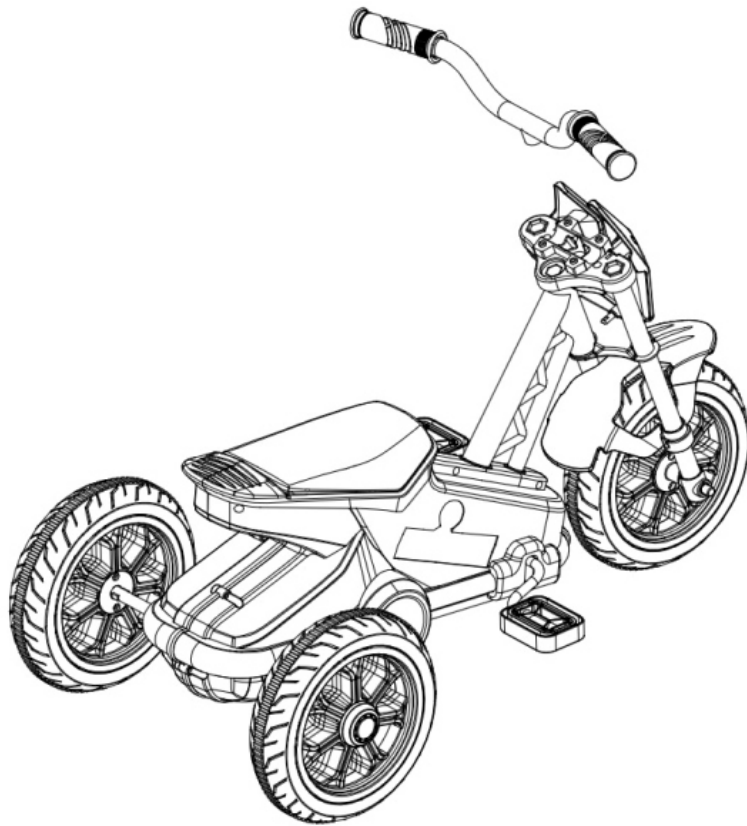

4. Ensure all nuts and bolts are securely tightened before use.

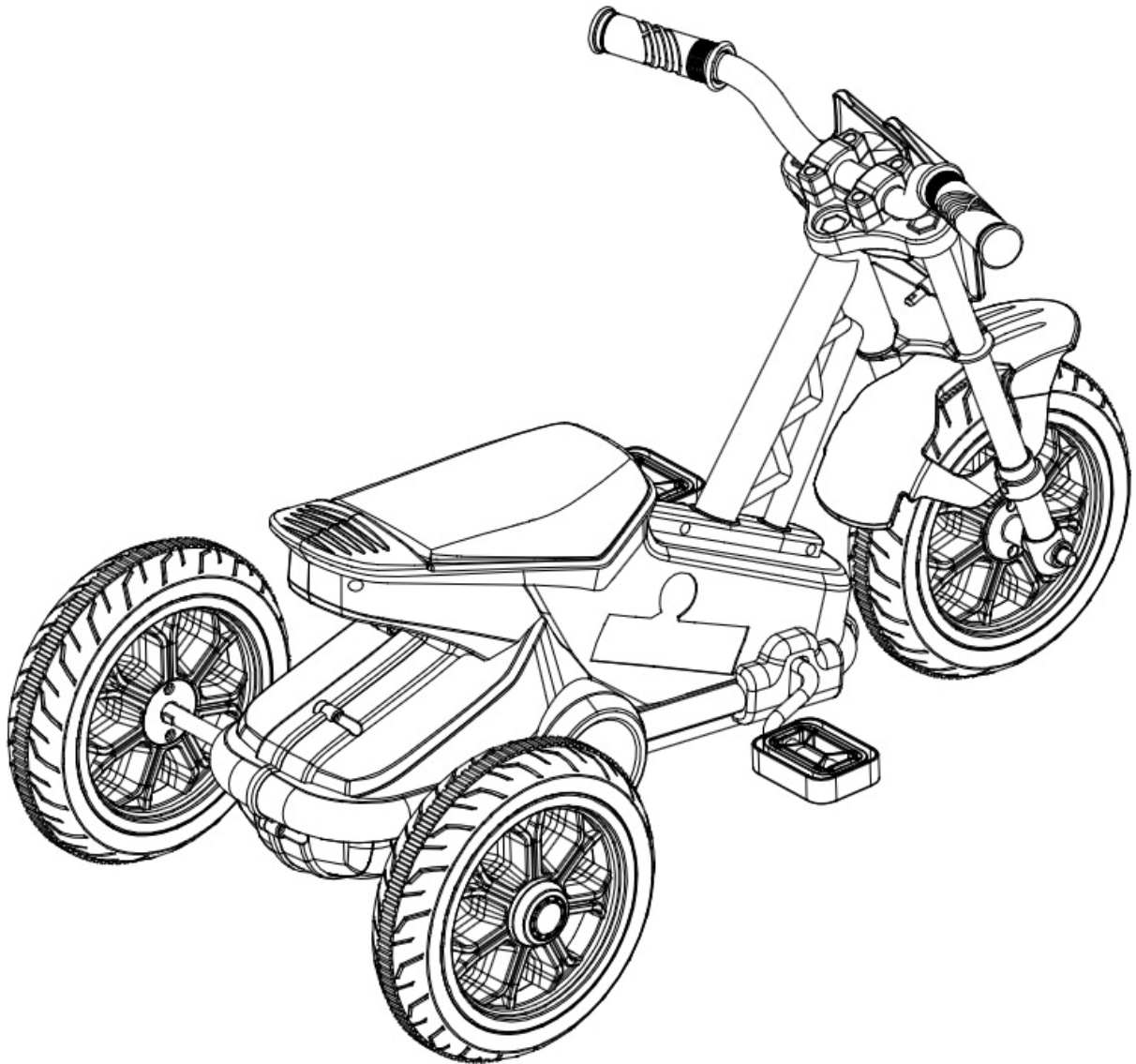

WARNINGS:

Not suitable for children under 1 years of age

Maximum capacity of 30kgs

Adult supervision required at all item

This product should not be operated on public roads, highways or bicycle paths

Read 'Safe operation' section before use

Always inspect and maintain product prior to use

SAFE OPERATION:

This product must be assembled by an adult and checked by an adult before use

Ensure nuts and bolts remain securely fastened before use

Lubricate the chain often

The toy should be used with caution since skill is required to avoid falls or collisions causing injury to the user or third parties.

Do not store in direct sunlight

Material of products:

A、 PP B、 IRON

Liste des pièces (incluses)

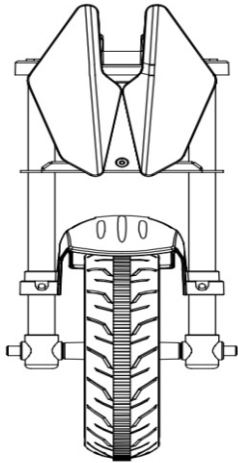

1. Extrémité de tête *1

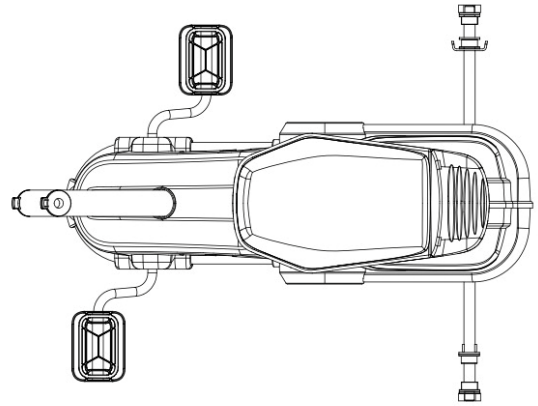

2. Cadre arrière*1

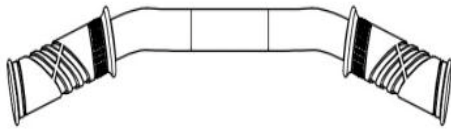

3. Poignée*1

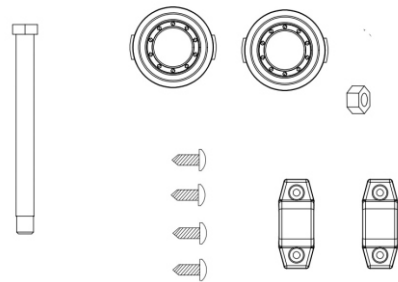

4. Sachet de vis*1

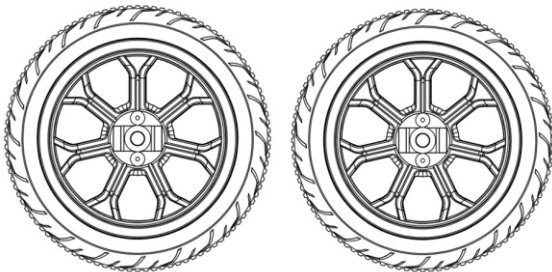

5. Roues*2

Page 1

PEDAL GO-KART

Operating Instructions
and Assembly Manual

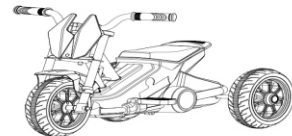

Execution Standard: EN71-1, -2, -3

Please read this manual carefully before use

Caution: For correct and safe operation of this product,
be sure to read this instruction manual carefully before use.
Please retain this user manual for future reference.

6. Manuel

Instructions d'assemblage :

1. Fixez la roue en haut de l'arbre, comme indiqué sur les images

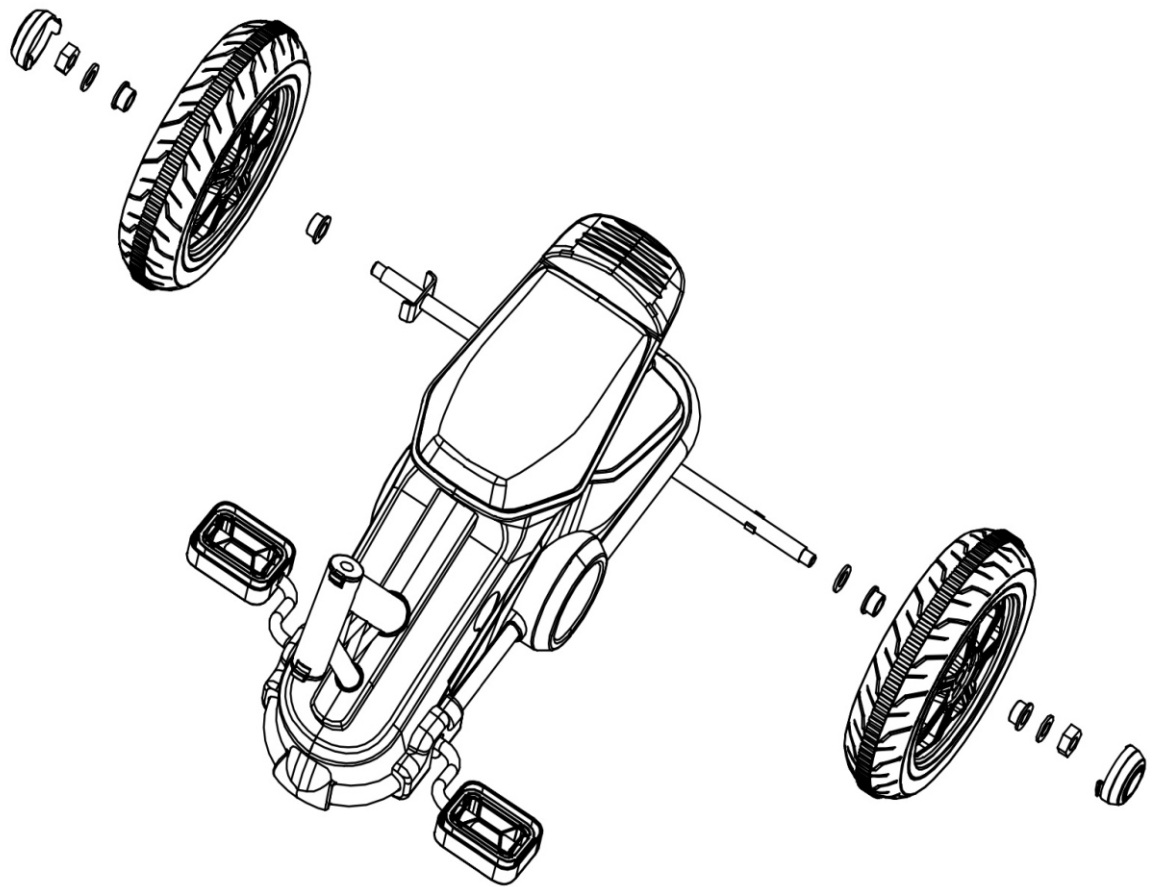

2. Utilisez la vis pour relier l'extrémité avant et le cadre arrière, serrez avec l'écrou.

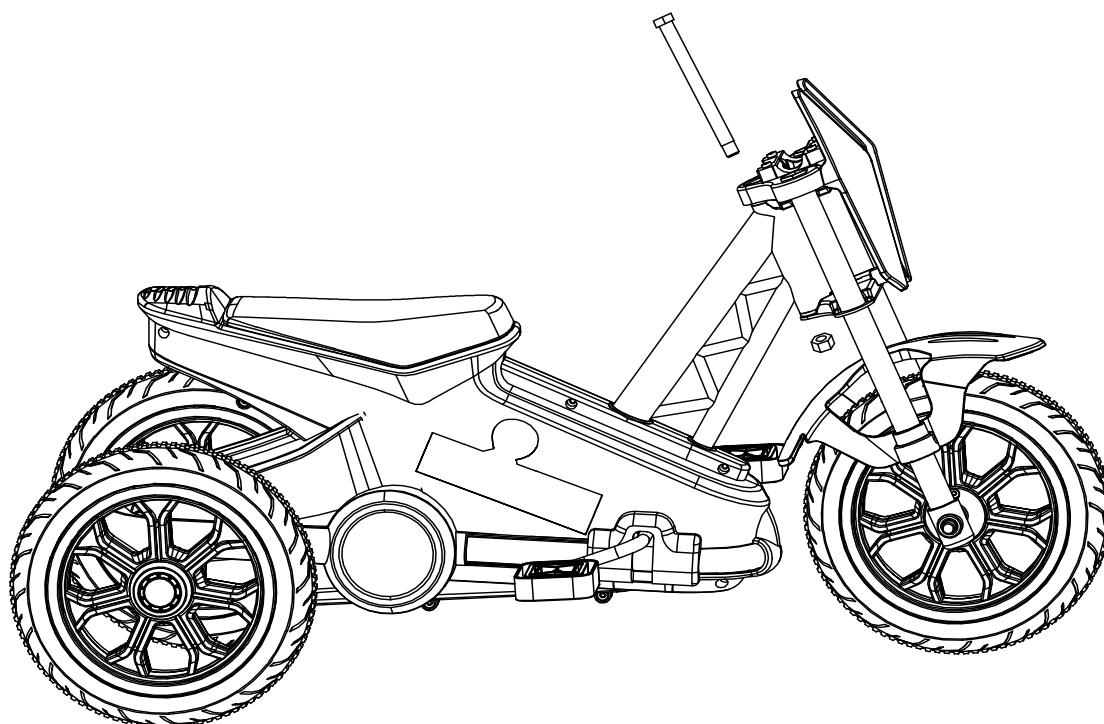
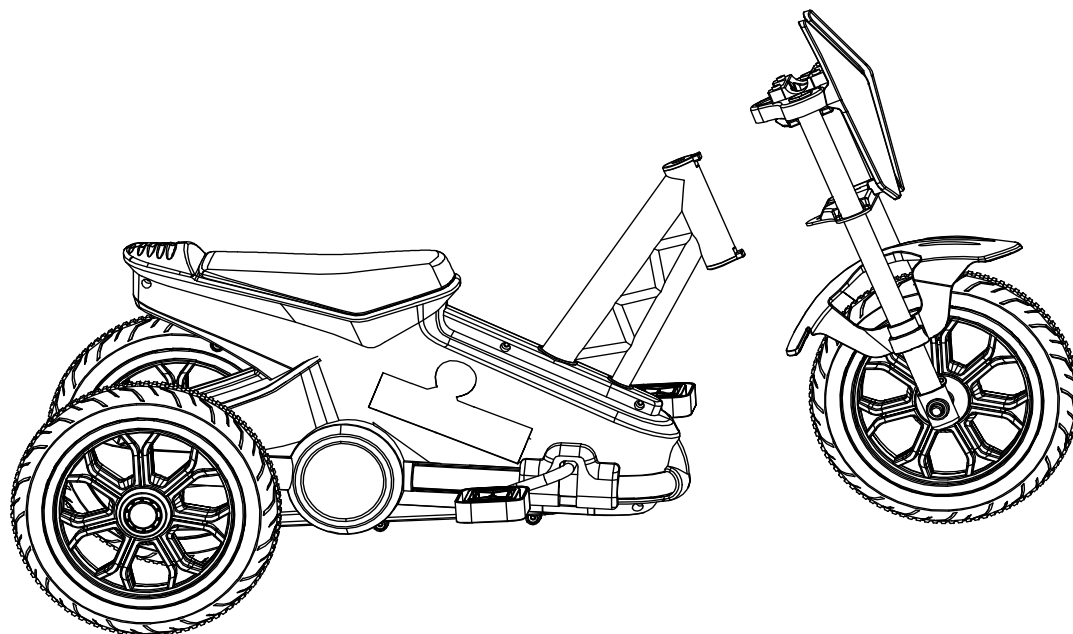

3. Fixez la poignée au cadre du véhicule. Serrez avec une vis M4*12, en veillant à réutiliser les pièces en plastique de fixation si nécessaire.

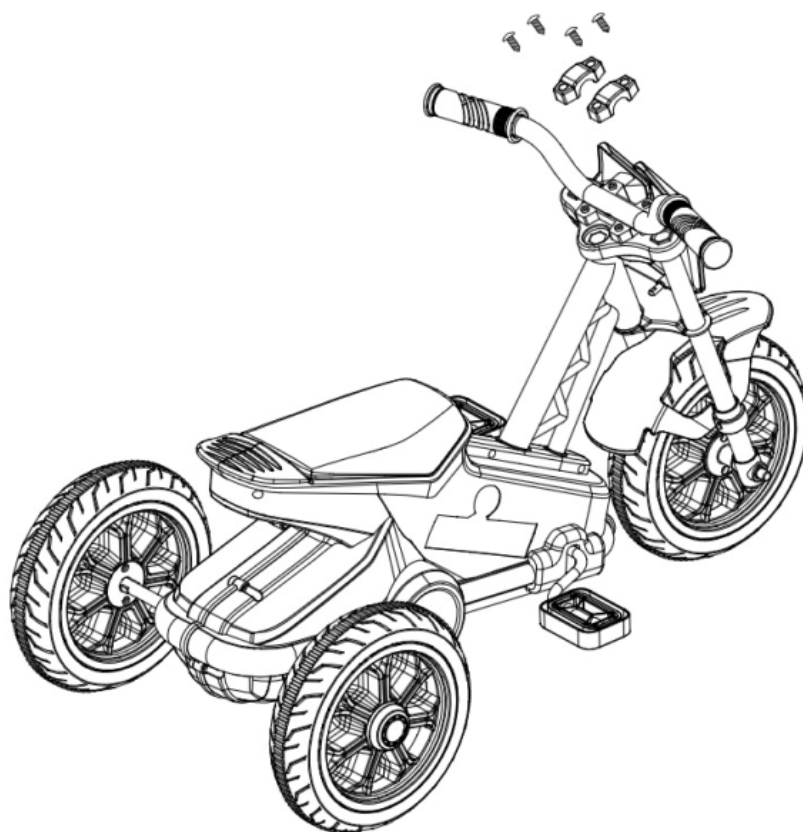
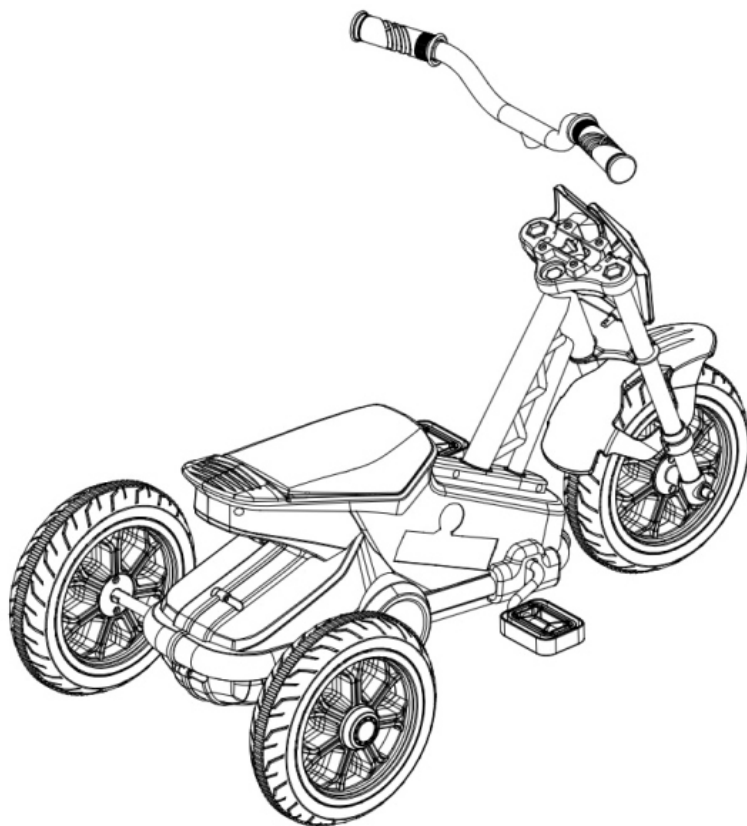

4. Vérifiez que tous les écrous et boulons sont bien serrés avant utilisation.

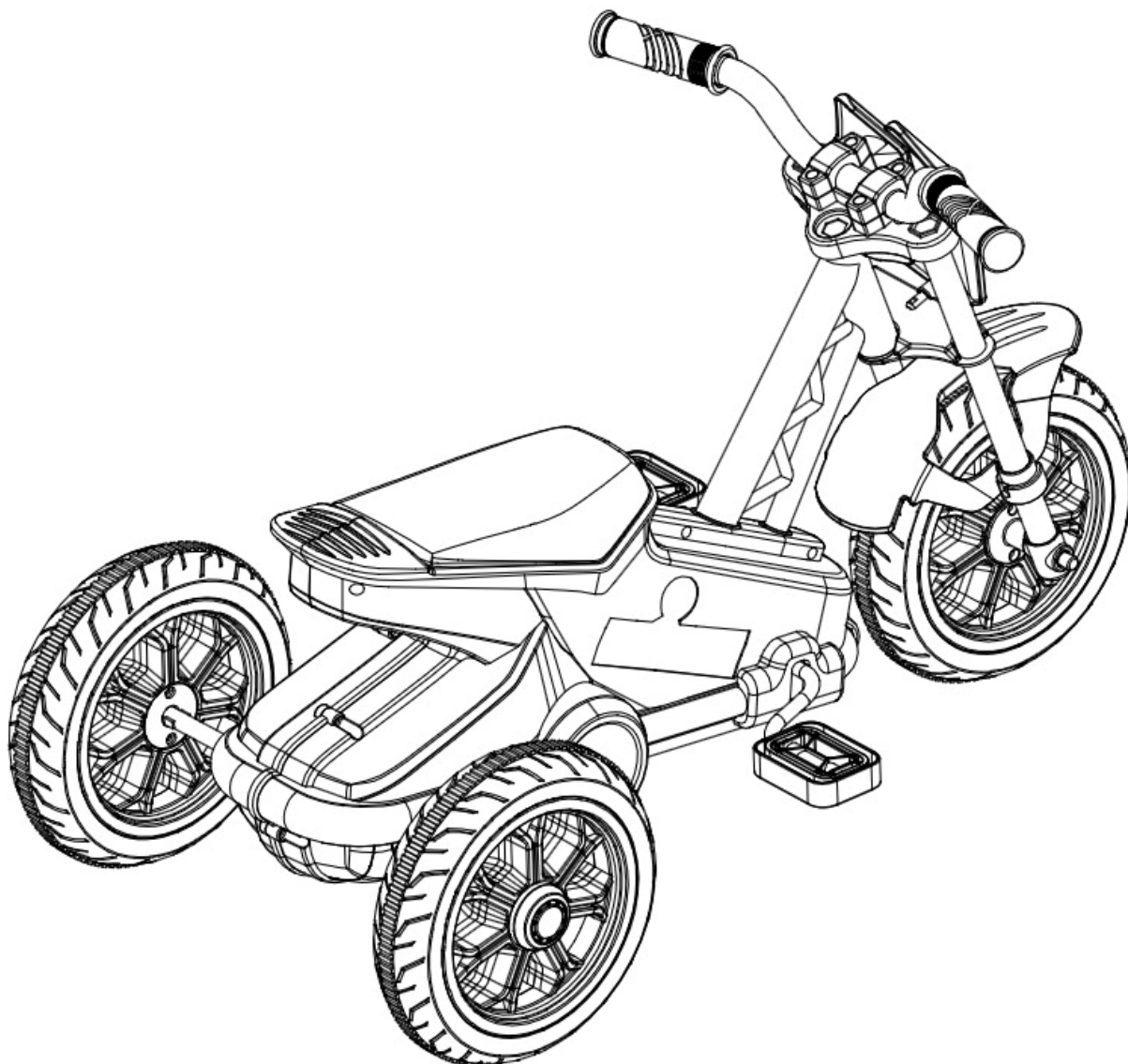

ATTENTION:

Non adapté aux enfants de moins de 1 ans

Capacité maximale de 30 kg

Une surveillance adulte est requise en permanence

Ce produit ne doit pas être utilisé sur les routes publiques, les autoroutes ou les pistes cyclables

Lire la section 'Utilisation en toute sécurité' avant emploi

Toujours inspecter et entretenir le produit avant utilisation

SÉCURITÉ D'UTILISATION :

Ce produit doit être assemblé par un adulte et vérifié par un adulte avant utilisation

Vérifiez que les écrous et boulons restent bien serrés avant utilisation

Graissez souvent la chaîne

Ce jouet doit être utilisé avec prudence car il nécessite de l'habileté pour éviter les chutes ou collisions pouvant causer des blessures à l'utilisateur ou à des tiers.

Ne pas stocker en exposition directe au soleil

Matériau des produits :

A、(PP) B、(IRON)

Teileliste (im Lieferumfang enthalten):

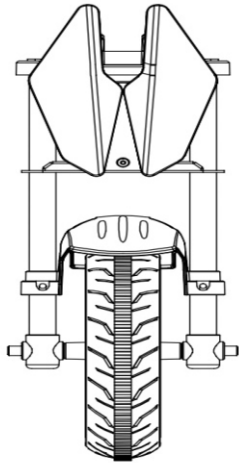

1. Kopffende *1

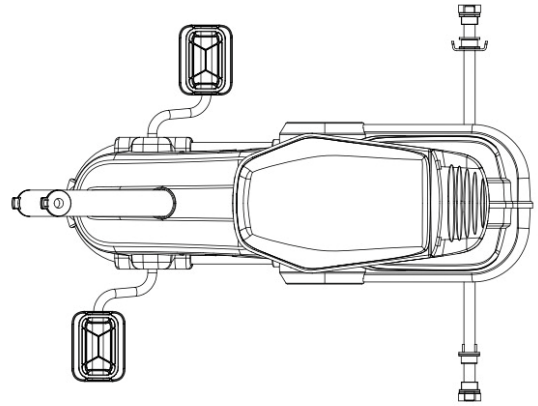

2. Rückrahmen *1

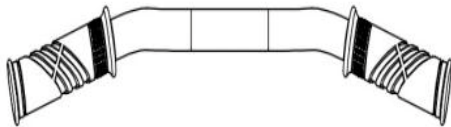

3. Griff*1

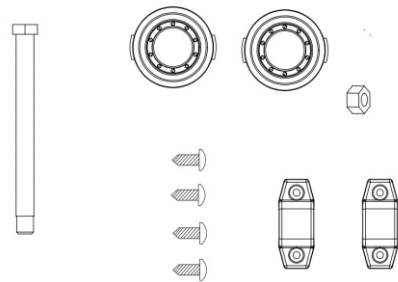

4. Tüte Schrauben *1

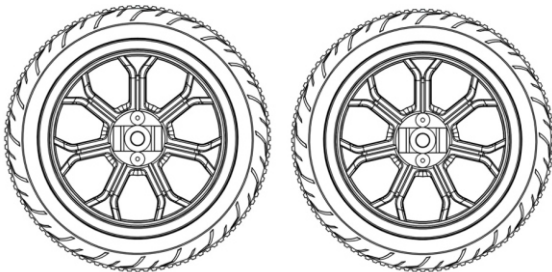

5. Räder*2

Page 1

PEDAL GO-KART

Operating Instructions
and Assembly Manual

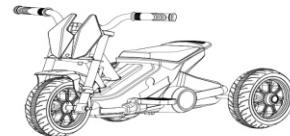

Execution Standard: EN71-1, -2, -3

Please read this manual carefully before use

Caution: For correct and safe operation of this product,
be sure to read this instruction manual carefully before use.
Please retain this user manual for future reference.

6. Anleitung

Montageanleitung:

1. Befestigen Sie das Rad oben an der Welle, wie auf den Bildern dargestellt

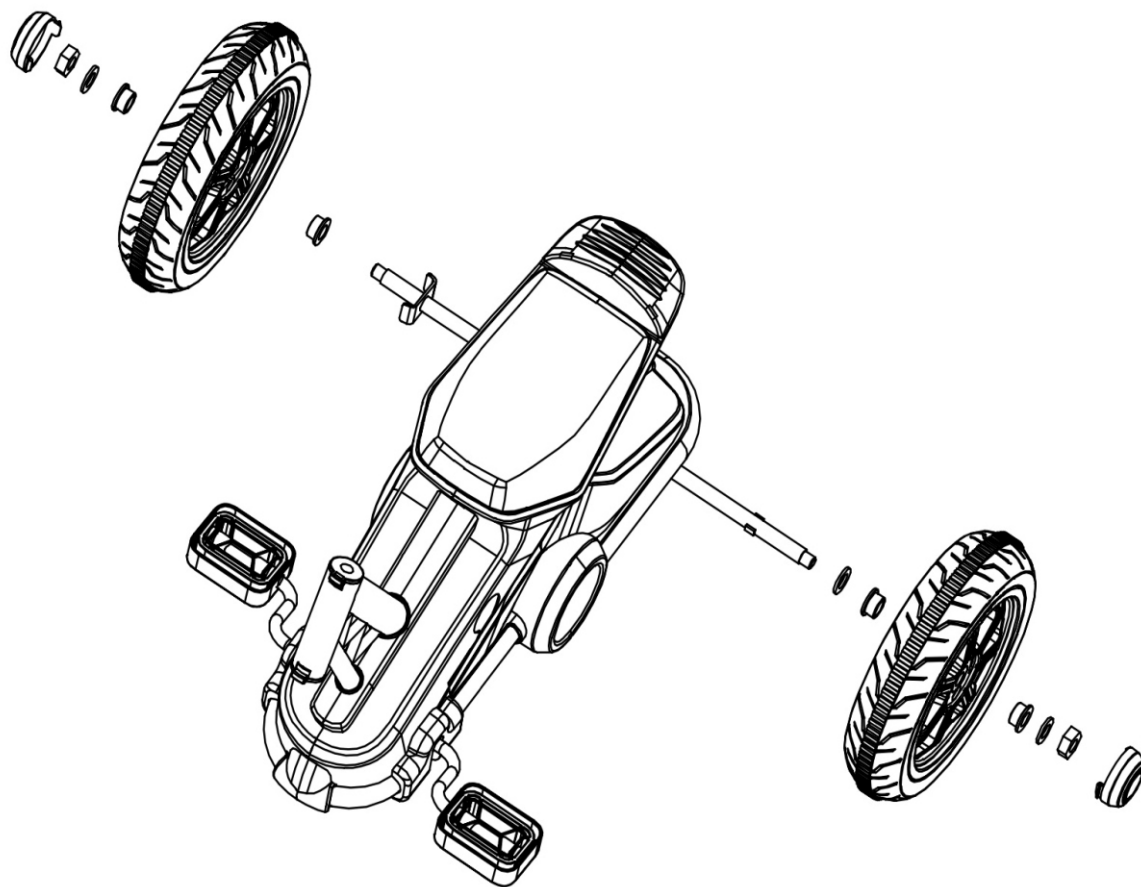

2. Verwenden Sie die Schraube, um das Kopfende und den hinteren Rahmen zu verbinden, und ziehen Sie sie mit der Mutter fest.

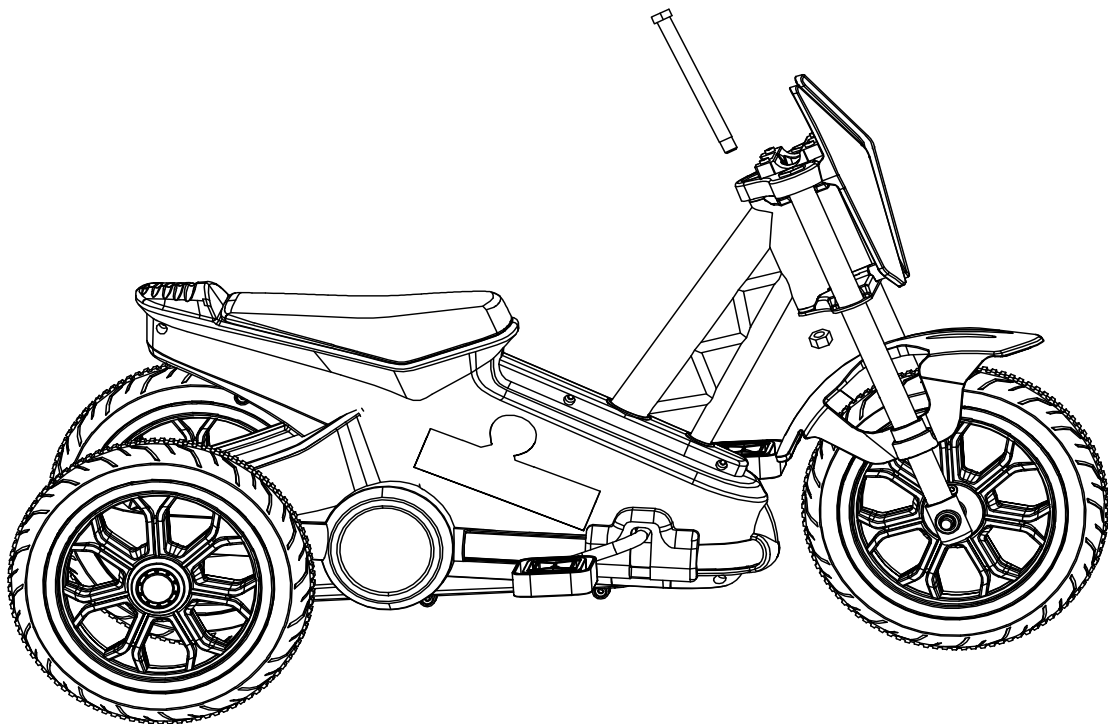
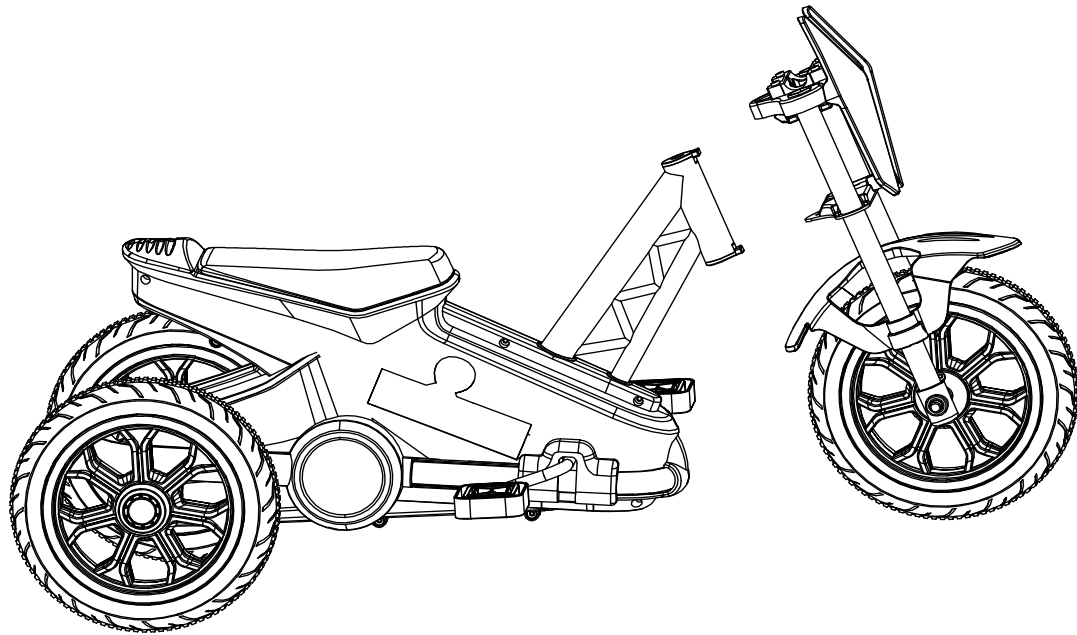

3. Befestigen Sie den Griff am Rahmen des Fahrzeugs. Ziehen Sie ihn mit einer M4*12-Schraube fest und verwenden Sie gegebenenfalls wieder die festen Kunststoffteile.

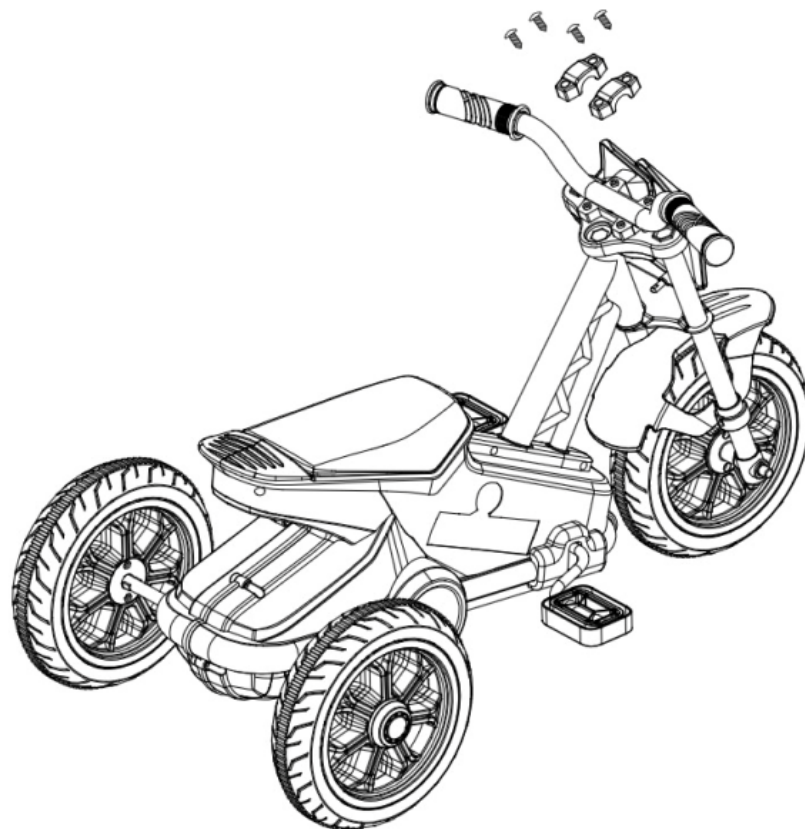
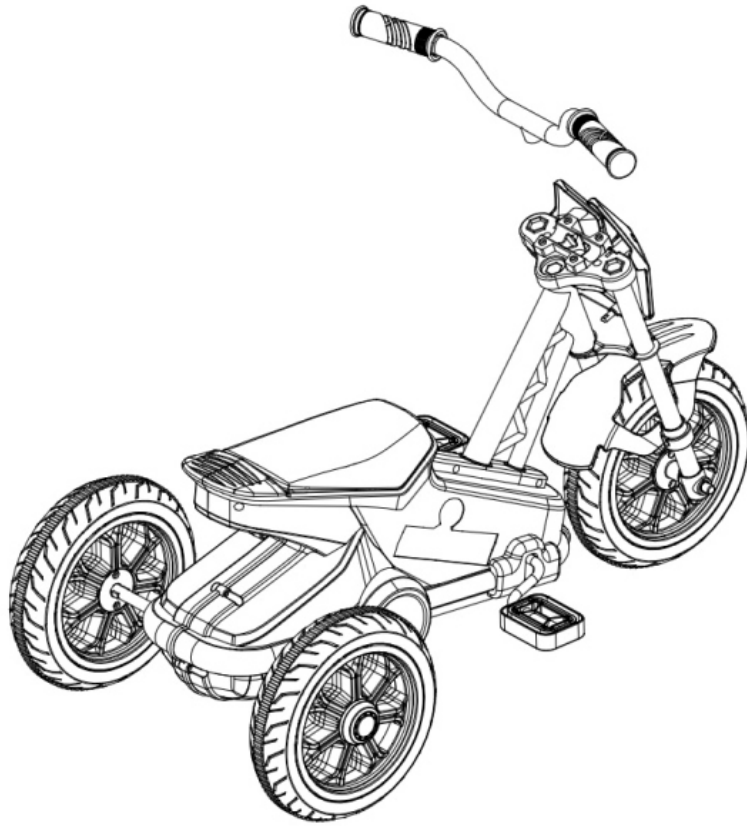

4. Stellen Sie sicher, dass alle Muttern und Schrauben vor der Verwendung fest angezogen sind.

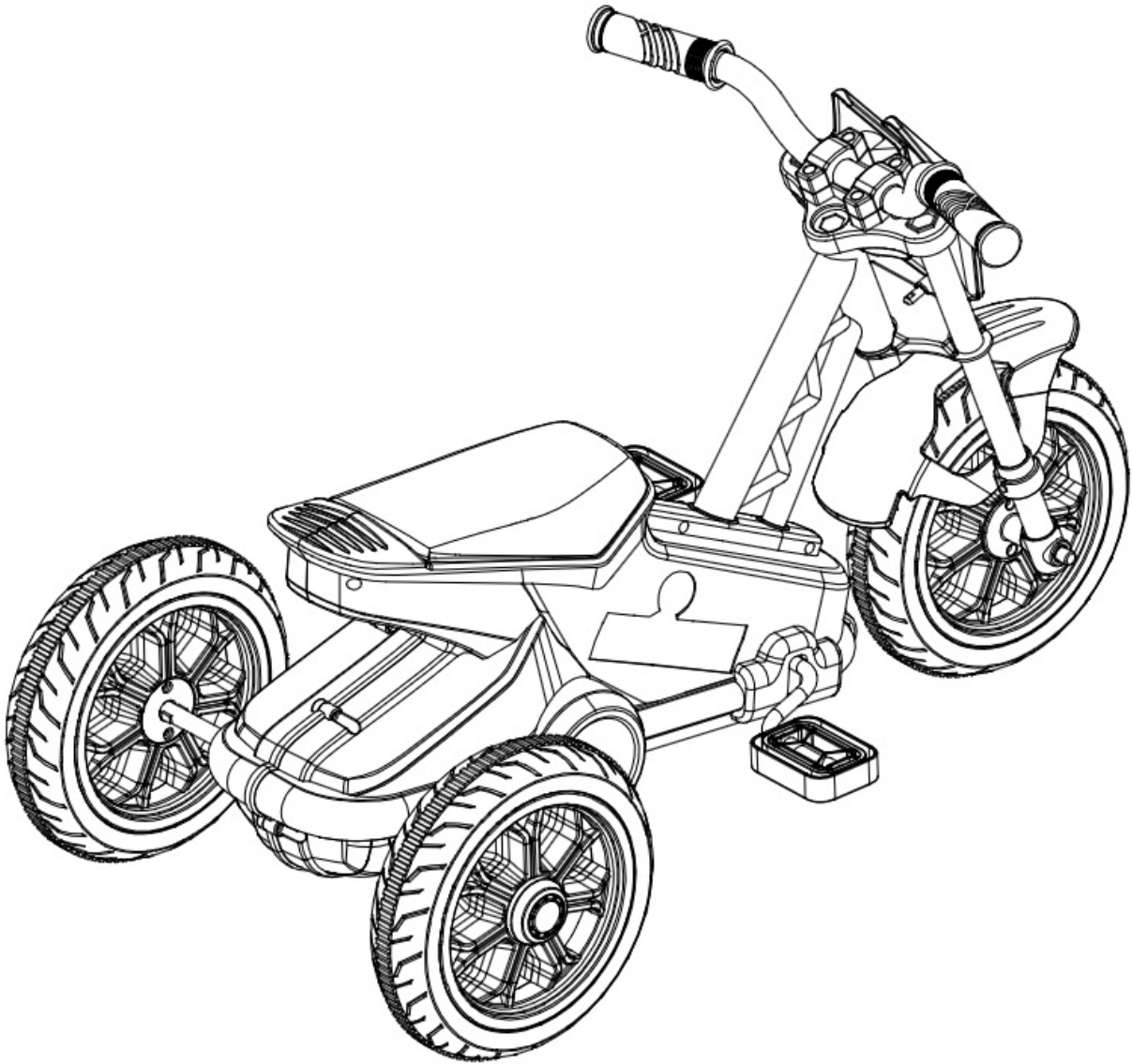

ACHTUNG:

Nicht geeignet für Kinder unter 1 Jahren

Maximale Tragfähigkeit von 30 kg

Erwachsenenaufsicht ist stets erforderlich

Dieses Produkt sollte nicht auf öffentlichen Straßen, Autobahnen oder Fahrradwegen betrieben werden

Lesen Sie vor der Verwendung den Abschnitt "Sichere Bedienung"

Überprüfen und warten Sie das Produkt immer vor der Verwendung

SICHERER BETRIEB:

Dieses Produkt muss von einem Erwachsenen zusammengebaut und vor der Verwendung von einem Erwachsenen überprüft werden

Stellen Sie sicher, dass Schrauben und Muttern vor der Verwendung fest angezogen sind

Schmieren Sie die Kette regelmäßig

Das Spielzeug sollte mit Vorsicht verwendet werden, da Geschick erforderlich ist, um Stürze oder Kollisionen zu vermeiden, die zu Verletzungen des Benutzers oder Dritter führen können.

Nicht in direktem Sonnenlicht lagern

Material der Produkte:

A、(PP) B、(IRON)

Lista de piezas (incluidas)

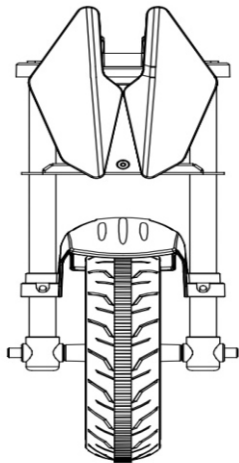

1. Extremo de la cabeza*1

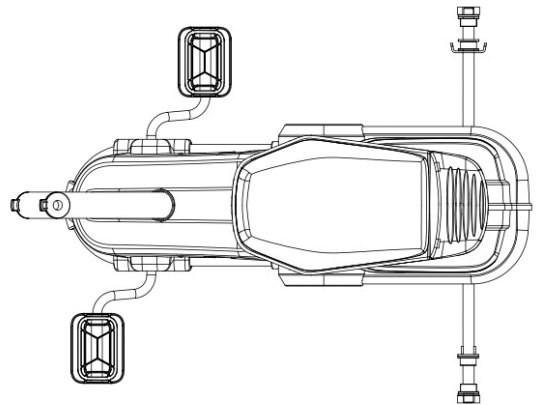

2. Marco trasero *1

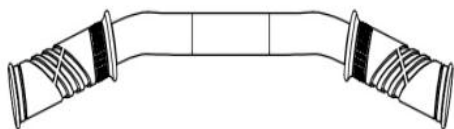

3. Mango *1

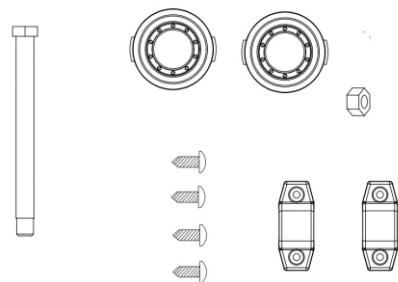

4. Bolsa de tornillos *1

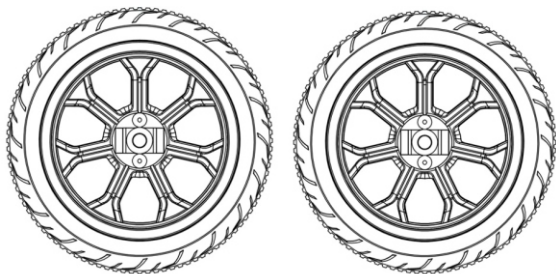

5. Ruedas *2

Page 1

PEDAL GO-KART

Operating Instructions
and Assembly Manual

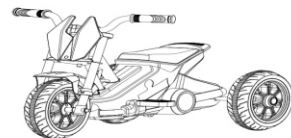

Execution Standard: EN71-1, -2, -3

Please read this manual carefully before use

Caution: For correct and safe operation of this product,
be sure to read this instruction manual carefully before use.
Please retain this user manual for future reference.

6. Manual

Instrucciones de montaje:

1. Fije la rueda en la parte superior del eje, como se muestra en las imágenes

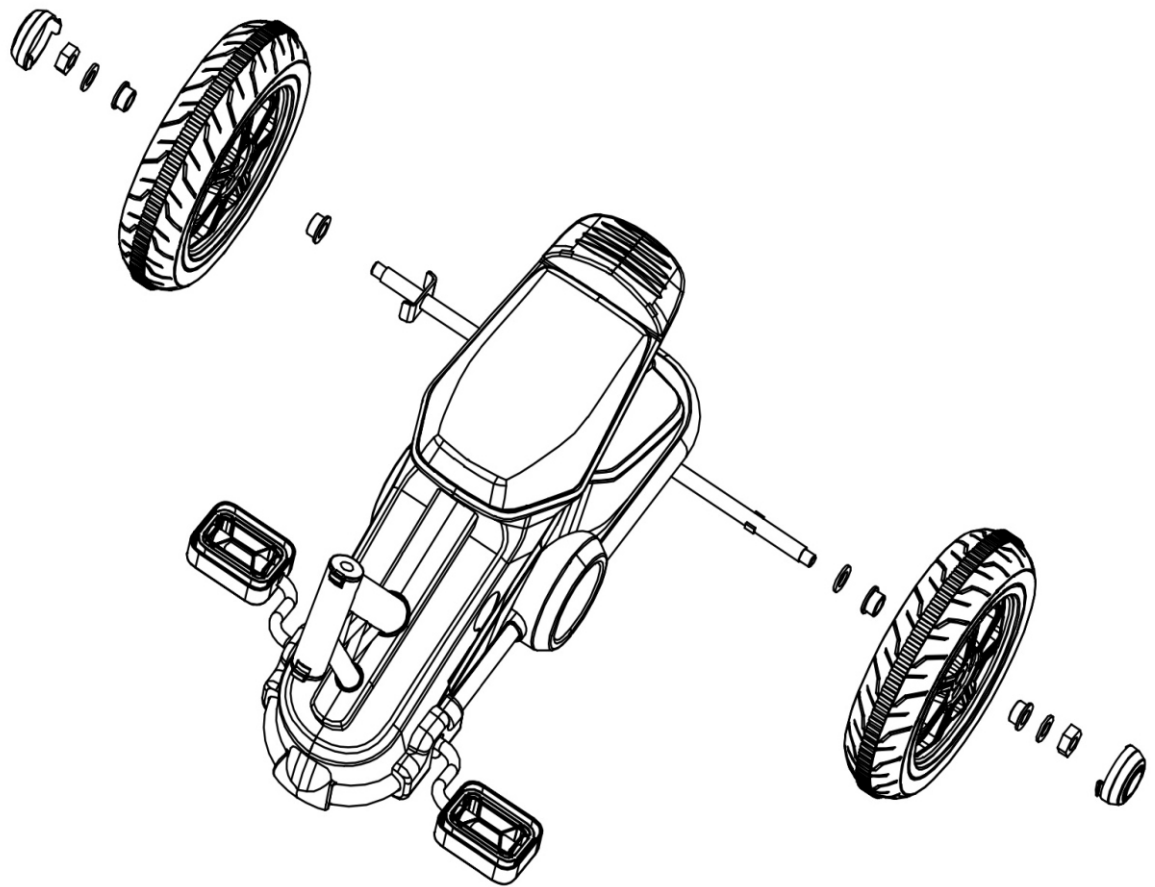

2. utilice el tornillo para unir el extremo del cabezal y el marco trasero, apriete con la tuerca.

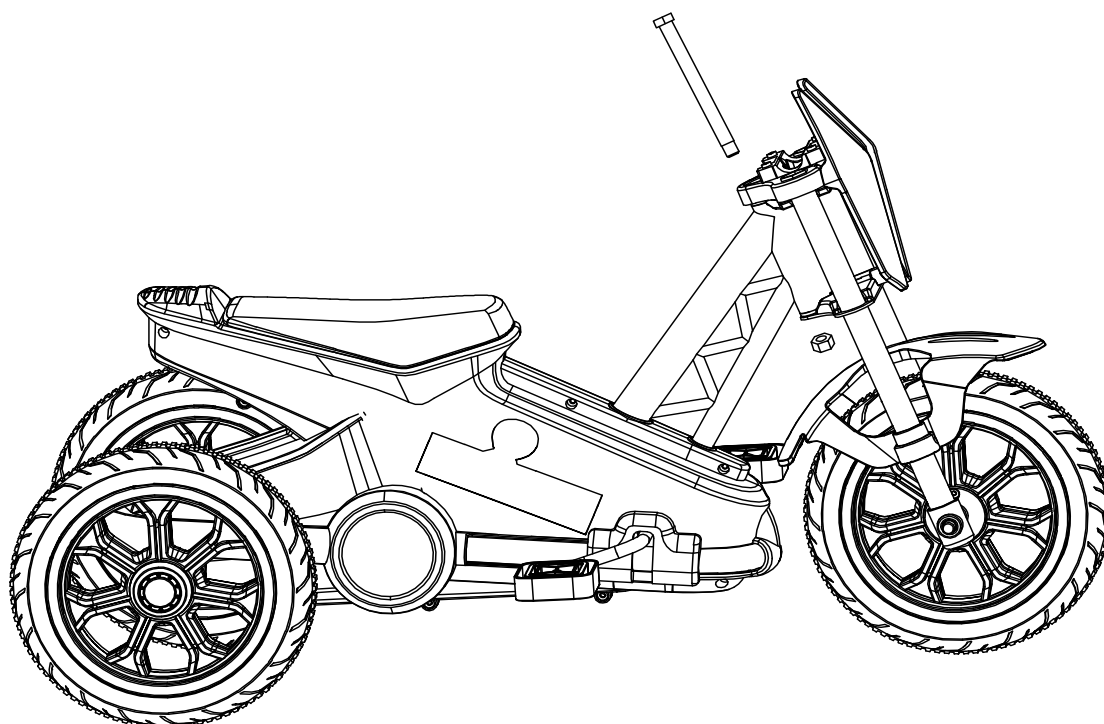
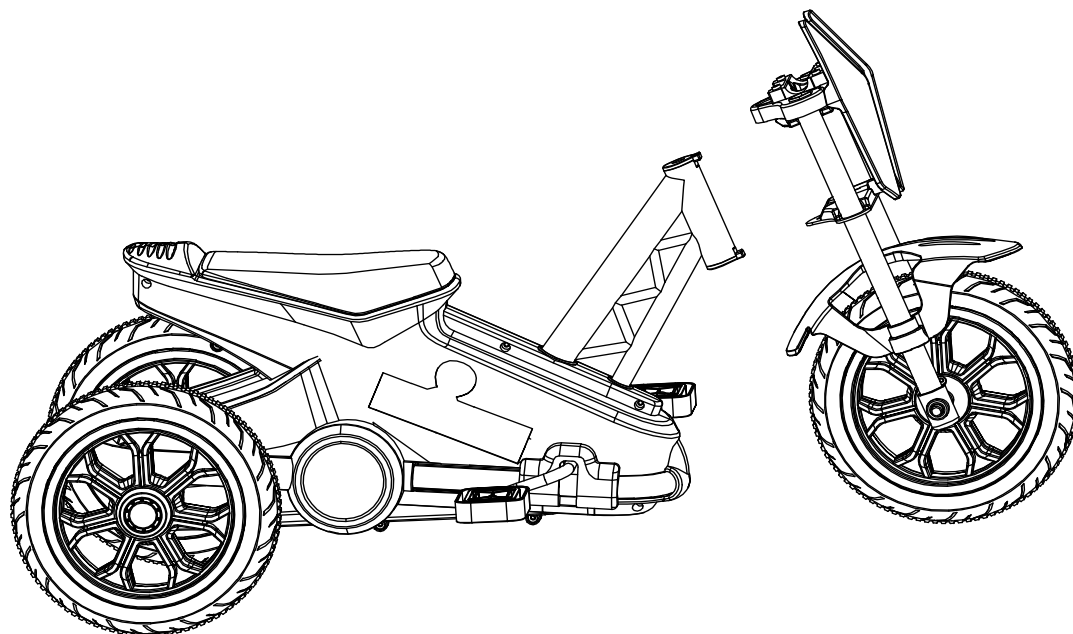

3. Fije el mango al marco del vehículo. Apriete con tornillo M4*12, asegúrese de utilizar nuevamente las piezas de plástico fijas donde corresponda.

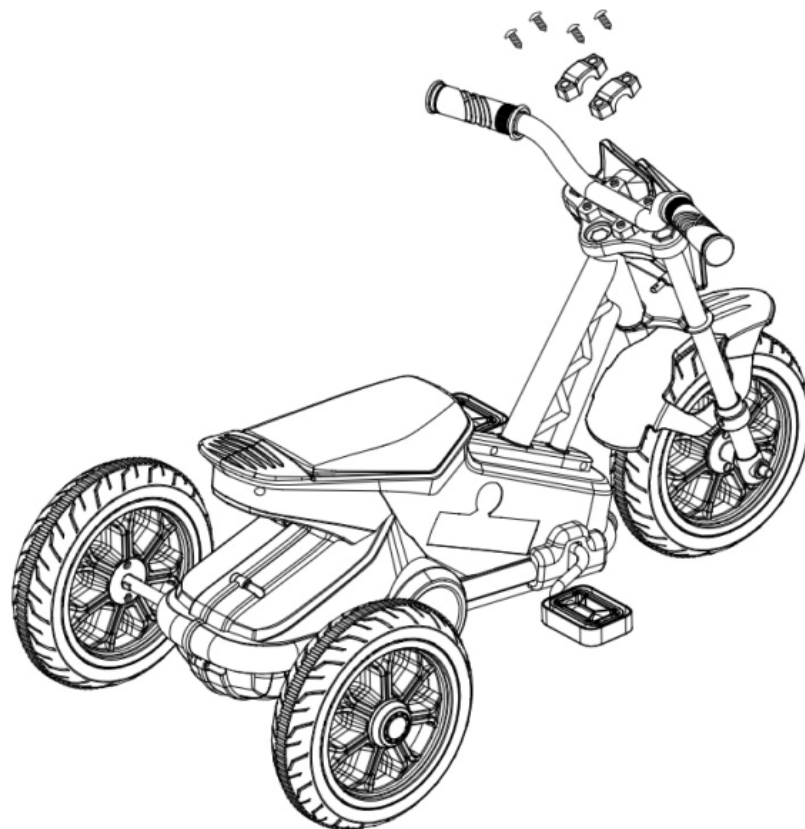
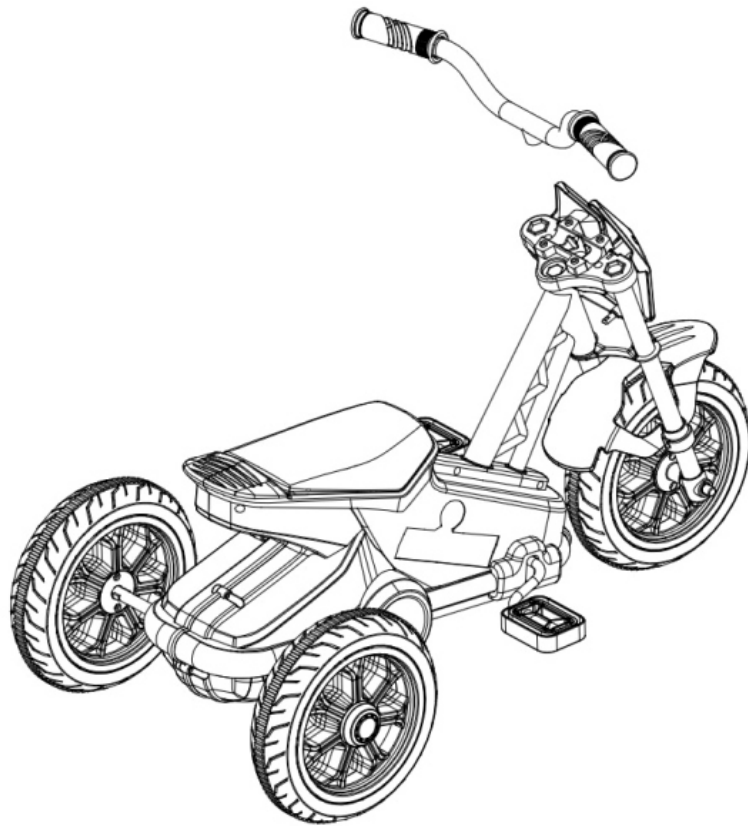

4. Asegúrese de que todas las tuercas y tornillos estén bien apretados antes de usar.

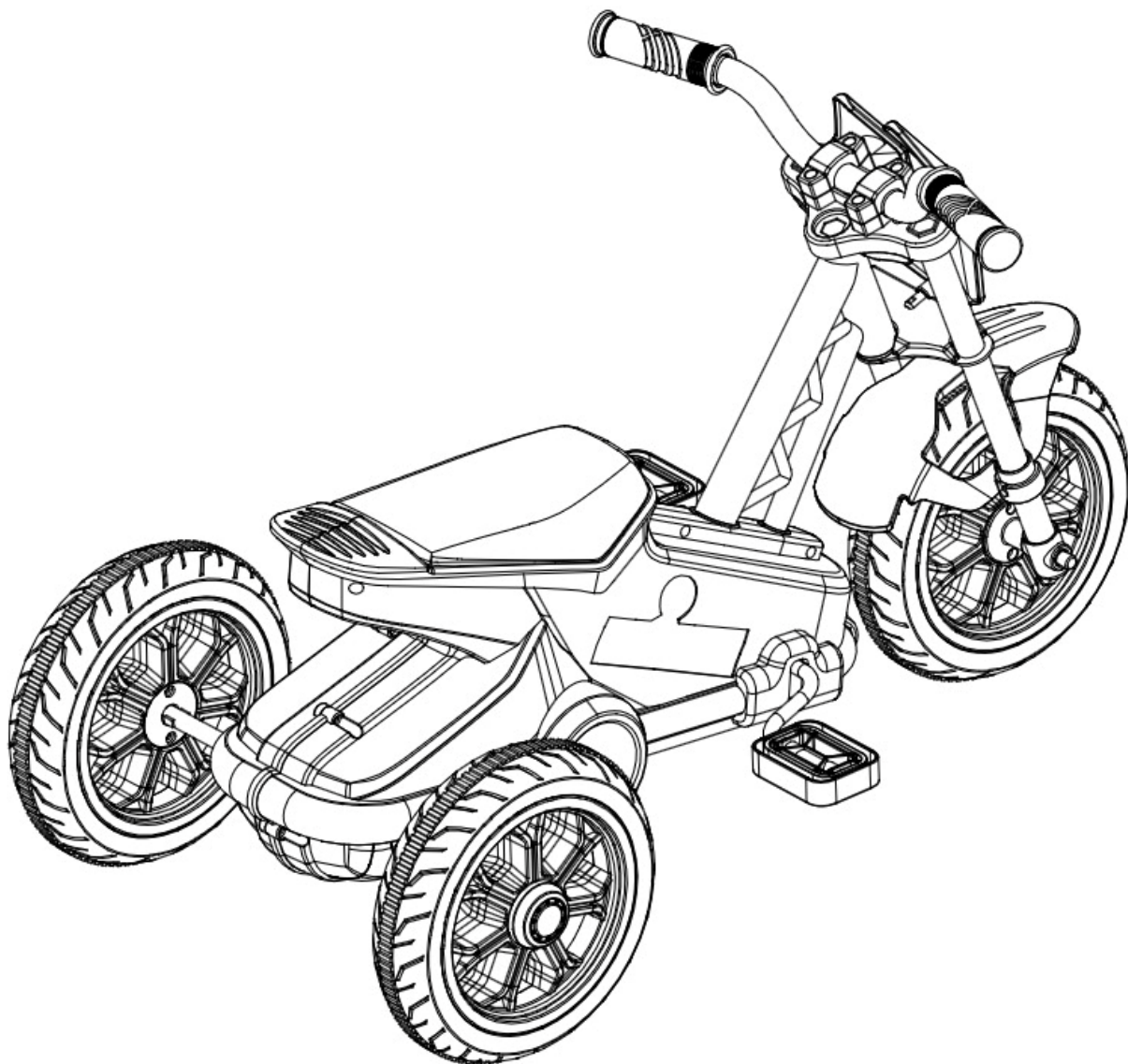

ADVERTENCIAS:

No apto para niños menores de 1 años

Capacidad máxima de 30 kg

Se requiere supervisión de un adulto en todo momento

Este producto no debe operarse en vías públicas, carreteras o carriles para bicicletas

Lea la sección 'Operación segura' antes de usar

Inspeccione y mantenga siempre el producto antes de usarlo

OPERACIÓN SEGURA:

Este producto debe ser ensamblado por un adulto y revisado por un adulto antes de su uso

Asegúrese de que las tuercas y tornillos permanezcan bien apretados antes de usar

Lubrique la cadena con frecuencia

El juguete debe utilizarse con precaución, ya que se requiere habilidad para evitar caídas o colisiones que puedan causar lesiones al usuario o a terceros.

No almacenar bajo la luz solar directa

Material de los productos:

A、(PP) B、(IRON)

Elenco dei componenti (inclusi):

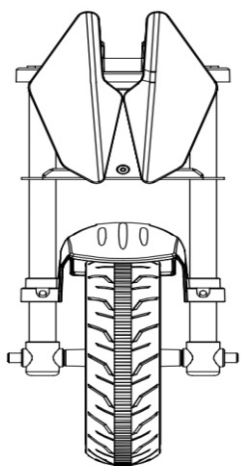

1. Estremità della testa *1

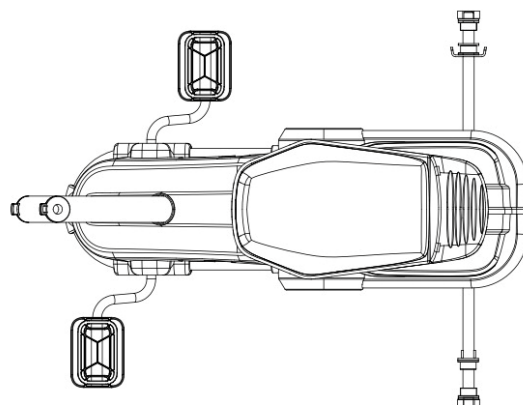

2. Telaio posteriore *1

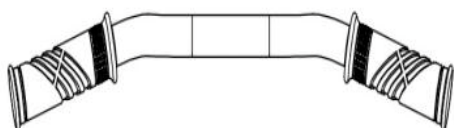

3. Manico *1

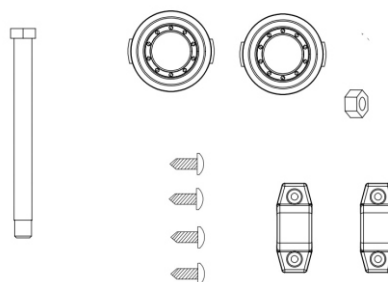

4. Sacchetto di viti *1

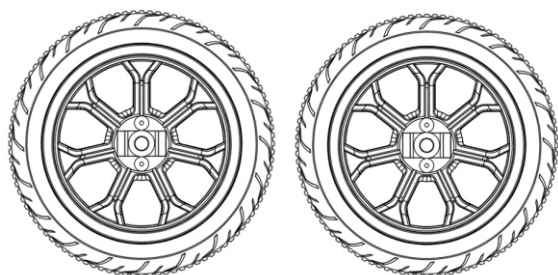

5. Ruote *2

Page1

PEDAL GO-KART

Operating Instructions
and Assembly Manual

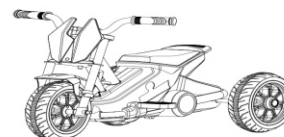

Execution Standard: EN71-1, -2, -3

Please read this manual carefully before use

Caution: For correct and safe operation of this product,
be sure to read this instruction manual carefully before use.
Please retain this user manual for future reference.

6. Manuale

Istruzioni di montaggio:

1. Fissare la ruota nella parte superiore dell'albero, come mostrato nelle immagini

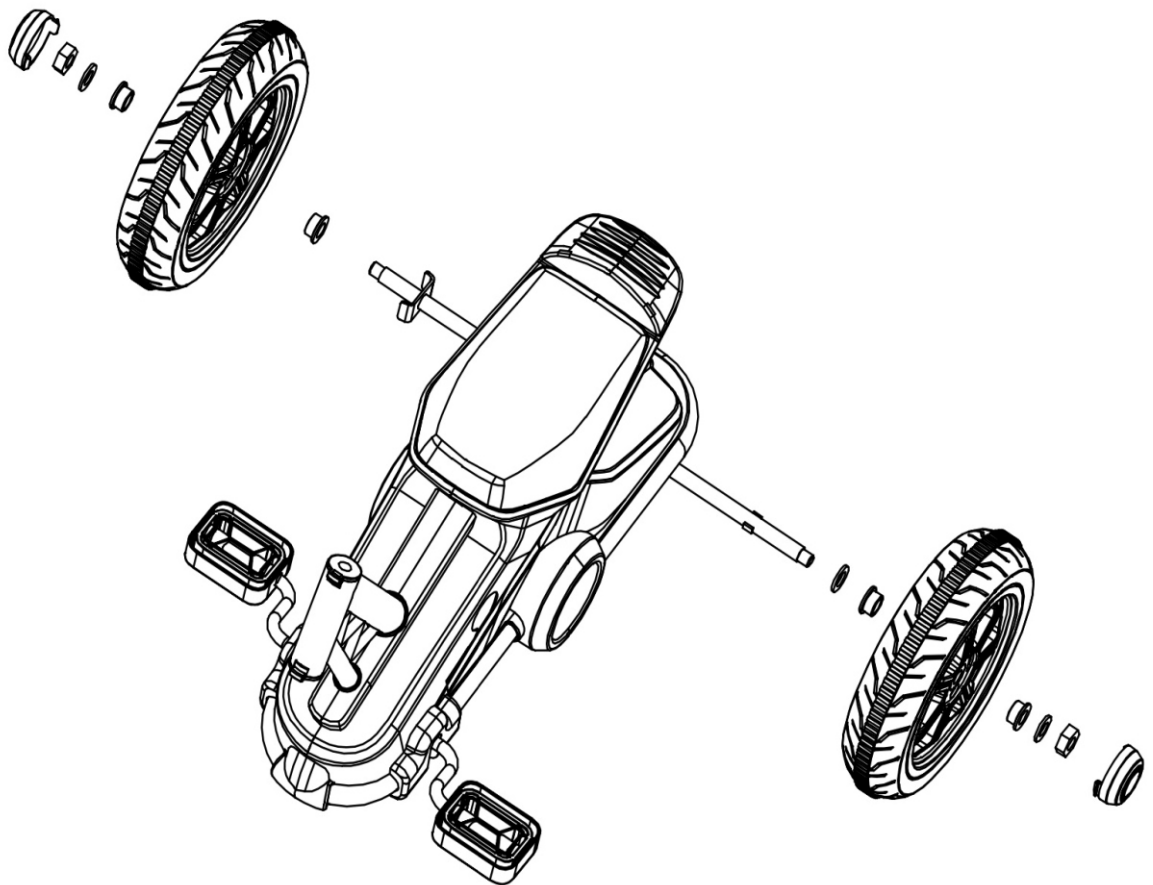

2. utilizzare la vite per collegare l'estremità anteriore e il telaio posteriore, serrando con il dado.

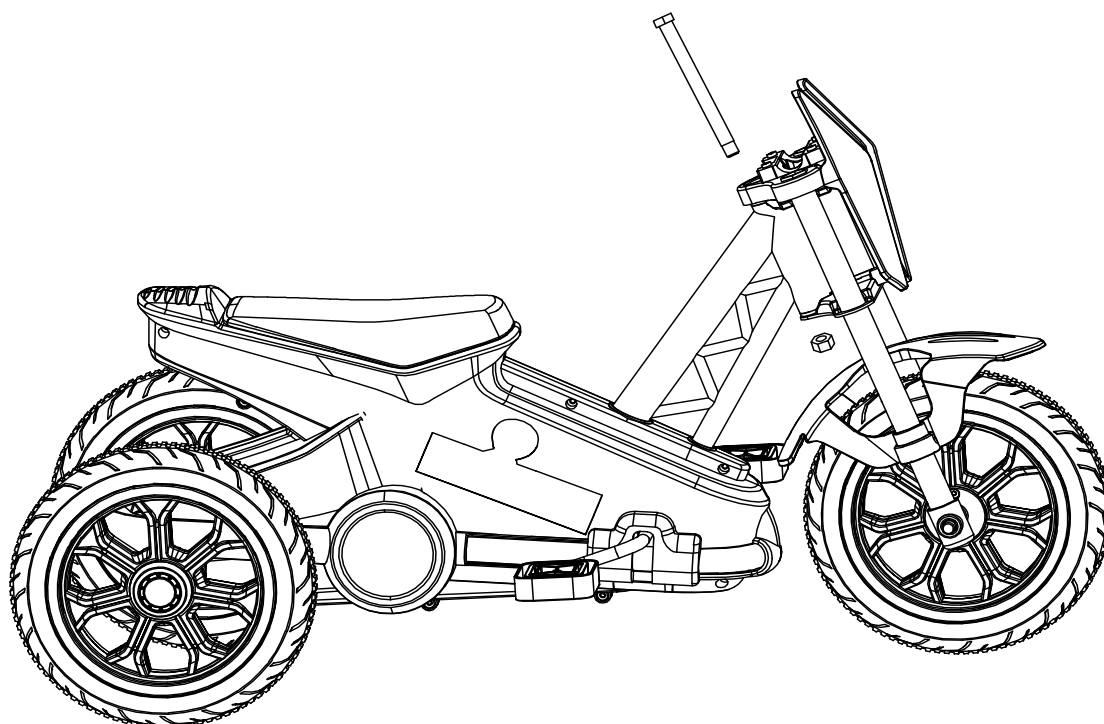
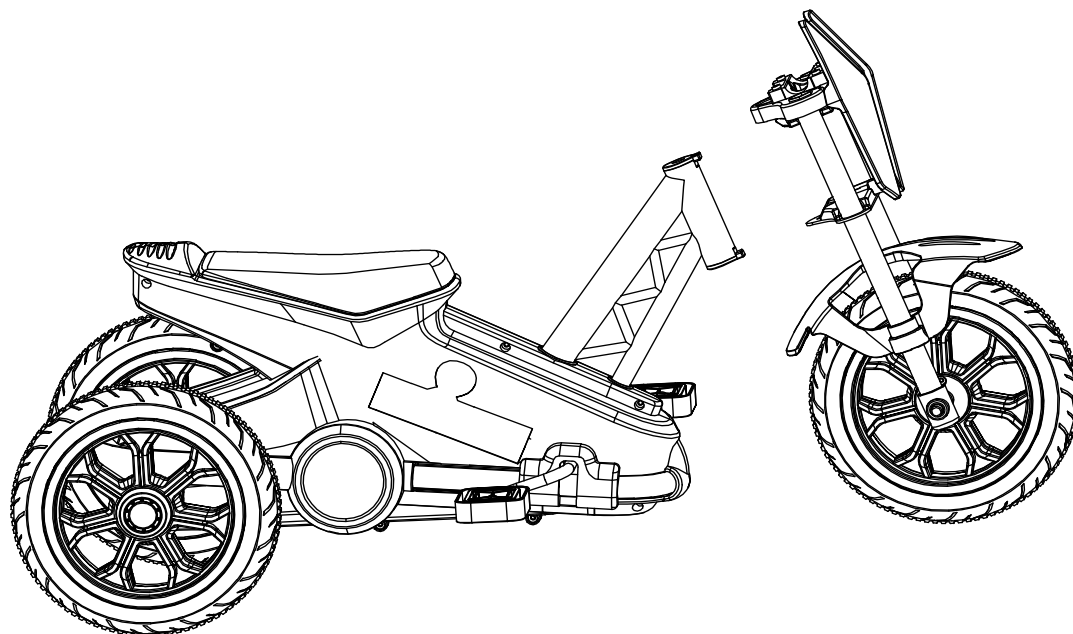

3. Fissare la maniglia al telaio del veicolo. Serrare con vite M4*12, assicurandosi di utilizzare nuovamente le parti in plastica fissa dove appropriato.

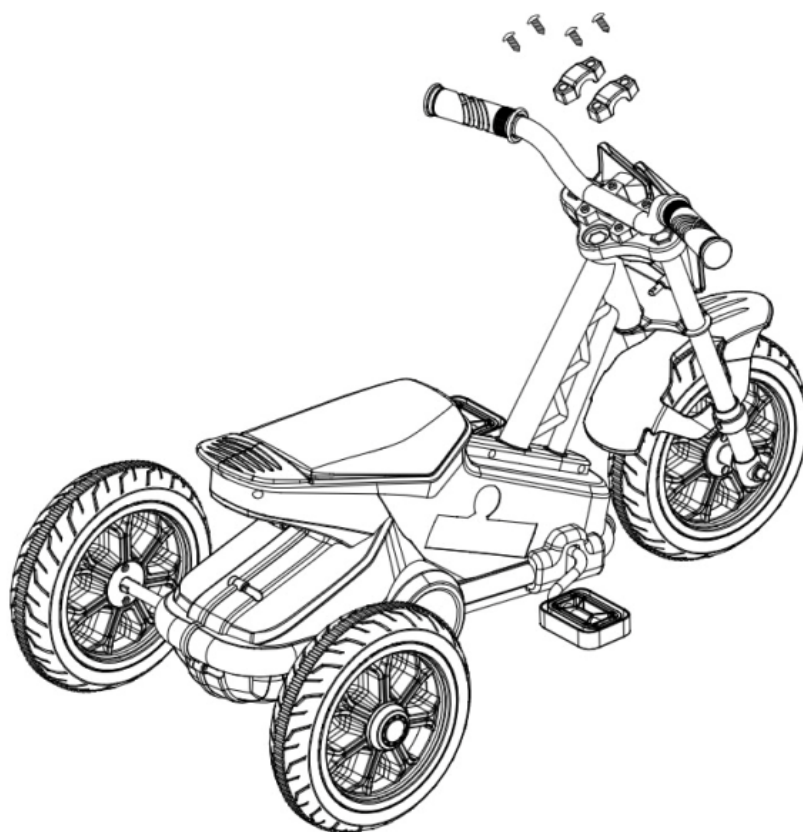
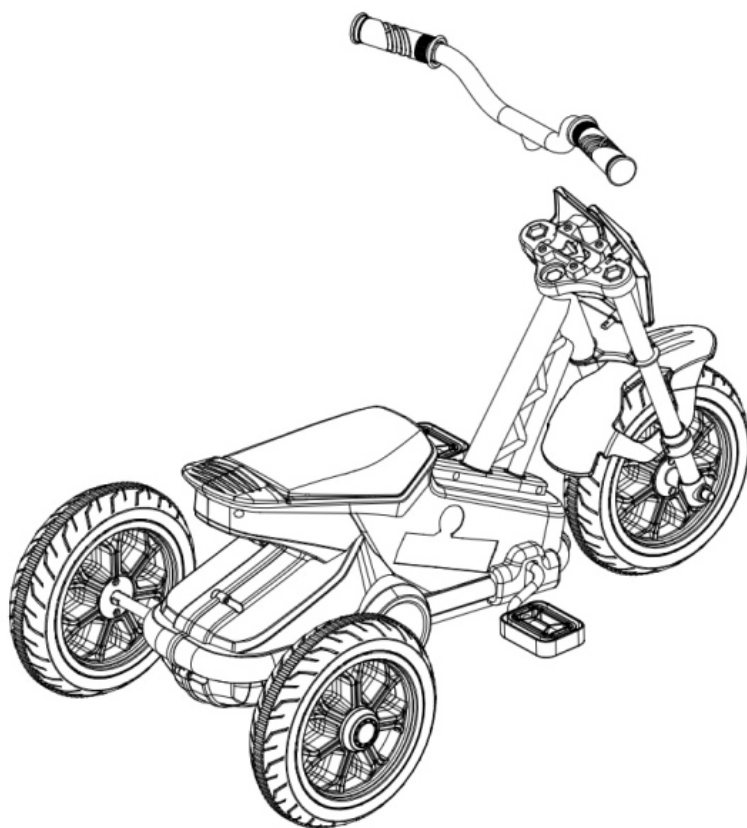

4. Assicurarsi che tutti i dadi e i bulloni siano ben serrati prima dell'uso.

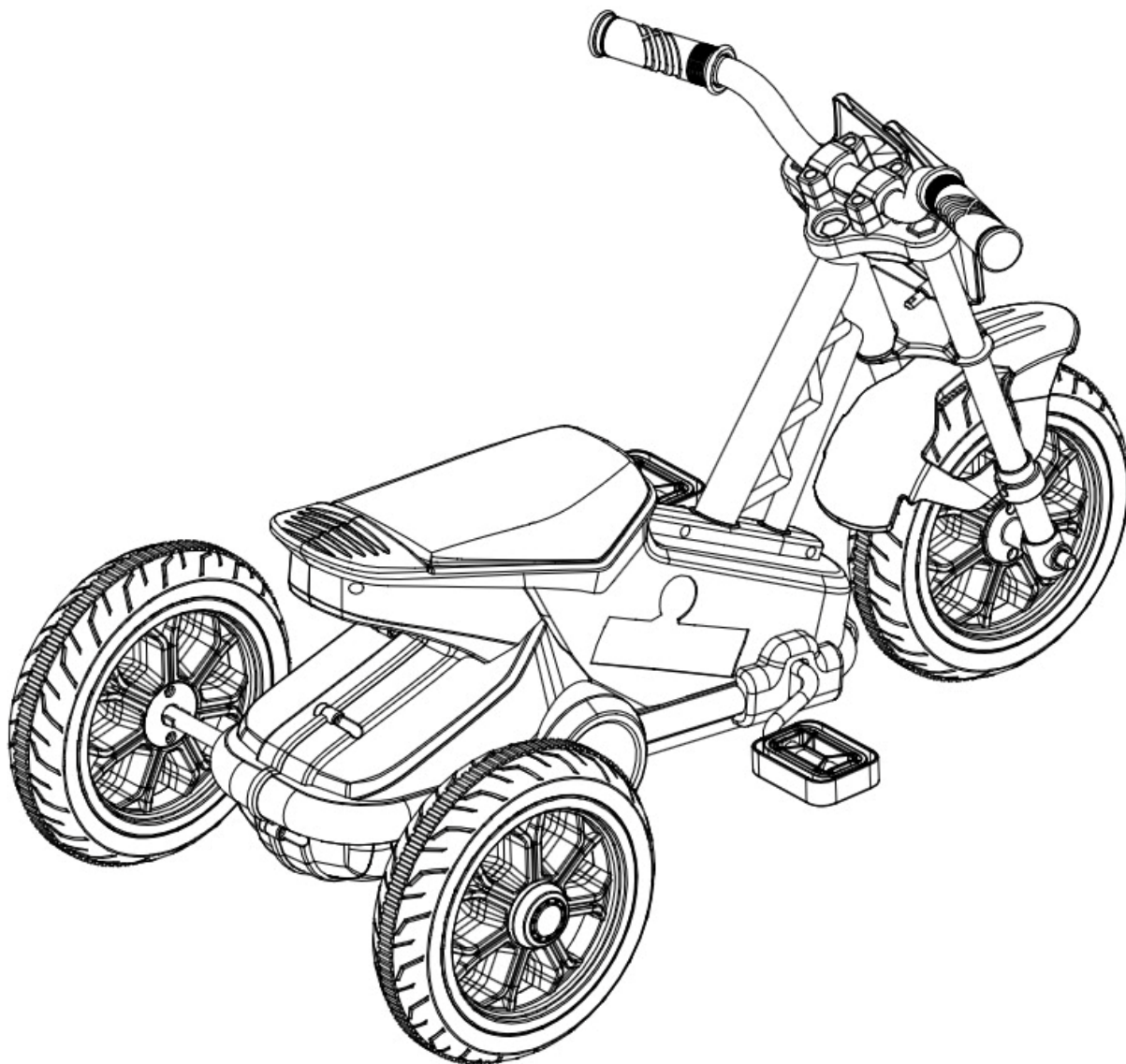

AVVERTENZE:

Non adatto a bambini di età inferiore a 1 anni

Capacità massima di 30 kg

È necessaria la supervisione di un adulto in ogni momento

Questo prodotto non deve essere utilizzato su strade pubbliche, autostrade o piste ciclabili

Leggere la sezione "Funzionamento sicuro" prima dell'uso

Ispezionare e mantenere sempre il prodotto prima dell'uso

SICUREZZA OPERATIVA:

Questo prodotto deve essere montato da un adulto e controllato da un adulto prima dell'uso

Assicurarsi che dadi e bulloni rimangano saldamente fissati prima dell'uso

Lubrificare spesso la catena

Il giocattolo deve essere usato con cautela poiché è necessaria abilità per evitare cadute o collisioni che potrebbero causare lesioni all'utente o a terzi.

Non conservare alla luce diretta del sole

Materiale dei prodotti:

A、(PP) B、(IRON)

UK

If you have any questions, please contact our customer care centre.

Our contact details are below:



0044-800-240-4004



enquiries@mhstar.co.uk

IMPORTER ADDRESS:

MH STAR UK LTD
Unit 27, Perivale Park,
Horsenden lane South
Perivale, UB6 7RH
MADE IN CHINA

ES

Si tiene alguna pregunta, comuníquese con nuestro Centro de Atención al Cliente. Nuestros datos de contacto son los siguientes:



0034-931294512



atencioncliente@aosom.es

Importador/Fabricante/REP:

Spanish Aosom, S.L.
C/ Roc Gros, nº 15. 08550, Els Hostalets de Balenyà, Spain.
B66295775
atencioncliente@aosom.es
TEL: 931294512
HECHO EN CHINA

FR

Si vous avez la moindre question, veuillez contacter notre centre d'assistance à la clientèle.

Nos coordonnées sont les suivantes:



0033-1-84166106



aosom@mhfrance.fr

Importé par/Fabricant/REP:

MH France
2, rue Maurice Hartmann
92130 Issy-les-Moulineaux
France
Fabriqué en Chine



Adresses sur quefairedemesdechets.fr

DE

Wenn Sie Fragen haben, wenden Sie sich bitte an unser Kundendienstzentrum.

Unsere Kontaktdaten stehen unten:



0049-0(40)-87408465



service@aosom.de

Importeur/Hersteller/REP:

MH Handel GmbH
Wendenstraße 309
D-20537 Hamburg
Germany
IN CHINA HERGESTELLT

IT

In caso di dubbio, si prega di contattare il nostro centro assistenza clienti. I nostri dettagli di contatto sono di seguito:



0039-0249471447



clienti@aosom.it

IMPORTATO DA/Produttore/REP:

AOSOM Italy srl
Centro Direzionale Milanofiori
Strada 1 Palazzo F1
20057 Assago (MI)
P.I.: 08567220960
FATTO IN CINA

