



Meaningful Innovation.

WEEE Number: 80133970

INSTRUCTION MANUAL

SOLAR LED STREET LIGHT WITH SENSOR

TECHNICAL DATA

MODEL	VT-ST20CCT
SKU	24099
POWER/LUMEN	20W / 3000LM
BEAM ANGLE	140° x70°
LEDs	SMD2835 x 96PCS
SOLAR PANEL	12.5W, Mono Crystalline Silicon
DETECTION ANGLE/AREA	120°/ 3-8Mtrs
DIMENSION	232x492.5x58MM
INSTALLATION HEIGHT	3-5Mtr
LIFESPAN	35,000hrs
BODY TYPE	ABS+PC



IP65
RATING

03 **YEAR**
WARRANTY*

BATTERY SPECIFICATIONS

BATTERY	Lithium, 18650/7.4V/5400mAh, Replaceable
CHARGING TIME	6-7Hrs
WORKING TIME	Mode A: 60Hr Max. Mode B: 45Hr

INTRODUCTION & WARRANTY

Thank you for selecting and buying V-TAC product. V-TAC will serve you the best. Please read these instructions carefully before starting the installation and keep this manual handy for future reference. If you have any another query, please contact our dealer or local vendor from whom you have purchased the product. They are trained and ready to serve you at the best. The warranty is valid for 3 years from the date of purchase. The warranty does not apply to damage caused by incorrect installation or abnormal wear and tear. The company gives no warranty against damage to any surface due to incorrect removal and installation of the product. The products are suitable for 10-12 Hours Daily operation. Usage of product for 24 Hours a day would void the warranty. This product is warranted for manufacturing defects only.

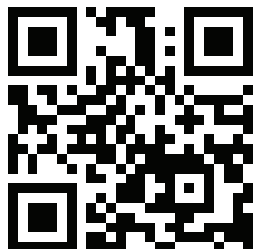

MULTI-LANGUAGE MANUAL QR CODE

Please scan the QR code
to access the manual in
multiple languages.



Points de collecte sur www.quefairedemesdechets.fr
Privilégiez la réparation ou le don de votre appareil !

RoHS



UK
CA



IN CASE OF ANY QUERY/ISSUE WITH THE PRODUCT, PLEASE REACH OUT TO US AT: SUPPORT@V-TAC.EU
FOR MORE PRODUCTS RANGE, INQUIRY PLEASE CONTACT OUR DISTRIBUTOR OR NEAREST DEALERS.
V-TAC EUROPE LTD. BULGARIA, PLOVDIV 4000, BUL.L.KARAVELOW 9B

WARNING

1. Installation must be performed by a qualified electrician
2. Once finishing the installation, remember to press the button on lamp to turn on the power.



This marking indicates that this product should not be disposed of with other household wastes.

NOTICE

1. This is a solar-powered lamp. Install it in a location that receives sufficient sunlight.
2. The lamp charges during the daytime and lights up automatically at night.
3. It will continue to charge even when turned off.
4. Lighting duration depends on sunlight exposure and the selected operating mode.
5. Equipped with overcharge and over-discharge protection for enhanced safety and durability.
6. The lamp includes a built-in, replaceable battery.
7. Do not disassemble the lamp unless performed by a qualified professional.
8. Do not dispose of the battery with household waste, as it may cause an explosion hazard.

WORKING MODE

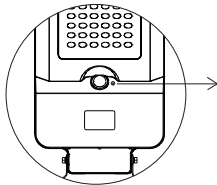

On / Off
Select Work Mode
Switch CCT

Switch CCT

- * In Mode A or Mode B, long press the button for 3 seconds to switch lighting color.
- * The CCT Switch includes a memory function.

MODE A: SENSOR MODE

Press the button 1st time, the lamp turns on to Mode A:

Lamp automatically lights up at night, and it will turn to full brightness when motion is detected in the range $\leq 8\text{mtrs}$, then dim to 5% brightness after 20 seconds of no motion.

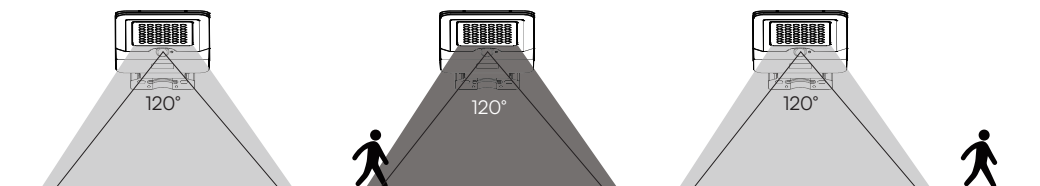

MODE B: KEEP LIGHTING MODE

Press the button 2nd time, the lamp turns to Mode B:

Lamp automatically lights up at night and keeps 60% brightness for 5 hours, then turns to Mode A.

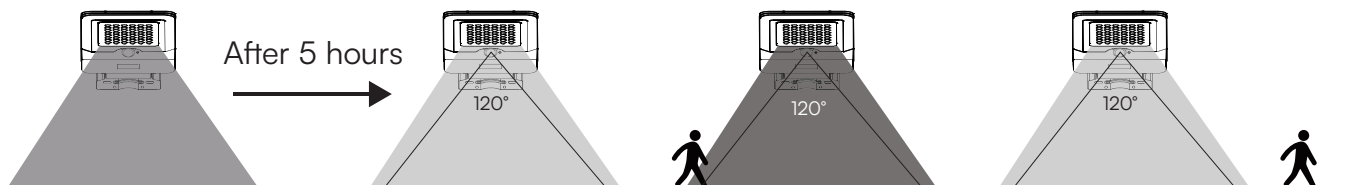

Off:

Press the button 3rd time, the lamp turns off.

3 DIFFERENT INSTALLATIONS

INSTALLATION A: WALL MOUNTED

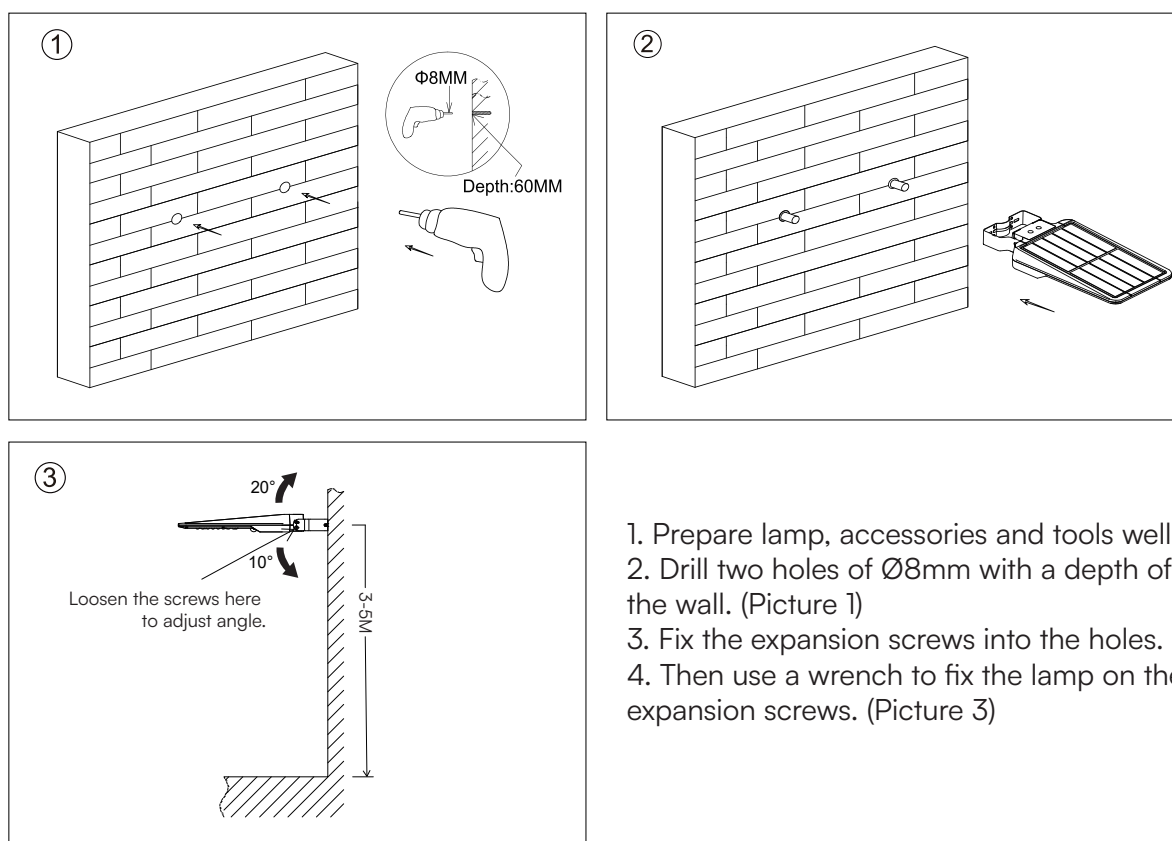

1. Prepare lamp, accessories and tools well firstly.
2. Drill two holes of $\Phi 8\text{mm}$ with a depth of 60mm on the wall. (Picture 1)
3. Fix the expansion screws into the holes. (Picture 2)
4. Then use a wrench to fix the lamp on the wall with expansion screws. (Picture 3)

INSTALLATION B: STRAIGHT POLE

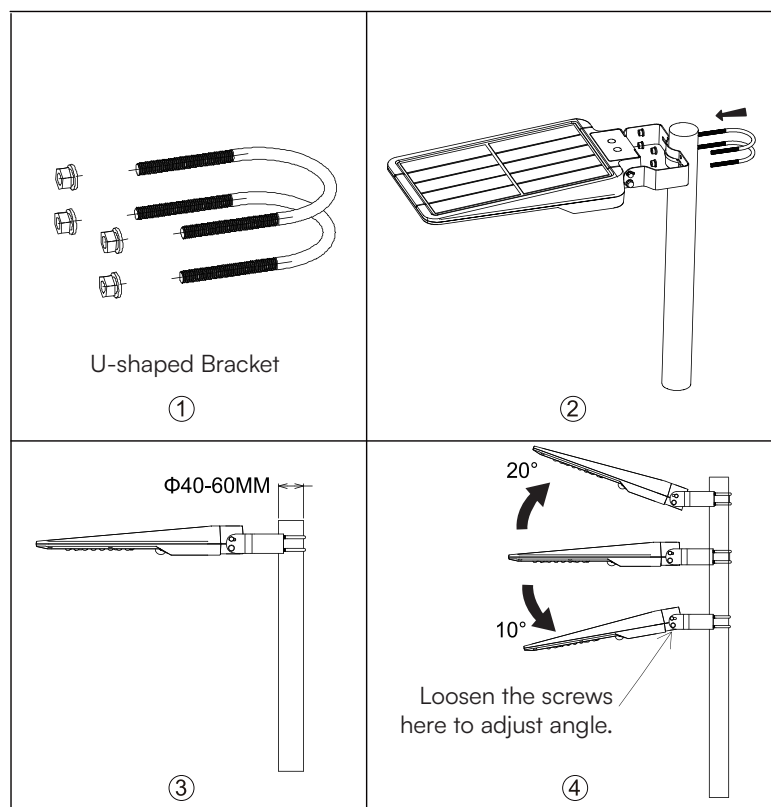

1. Prepare lamp, accessories and tools well firstly.
2. Remove the nut spacer of U-shaped brackets. (Picture 1)
3. Use the U-shaped brackets to fix the lamp on the pole. (Picture 2)
4. Loosen the screws at both ends of the bracket and adjust the angle of the lamp as needed, which is 20° adjustable in clockwise direction and 10° adjustable in counterclockwise direction, then tighten the screws. (Picture 3) 4)

*This installation applies to the poles with a diameter of $\Phi 40-60\text{mm}$.

ACCESSORIES INCLUDED

- Clamp for Straight Pole
- Clamp for Curved Pole
- Screws & Allen Wrench

INSTALLATION C: CURVED POLE

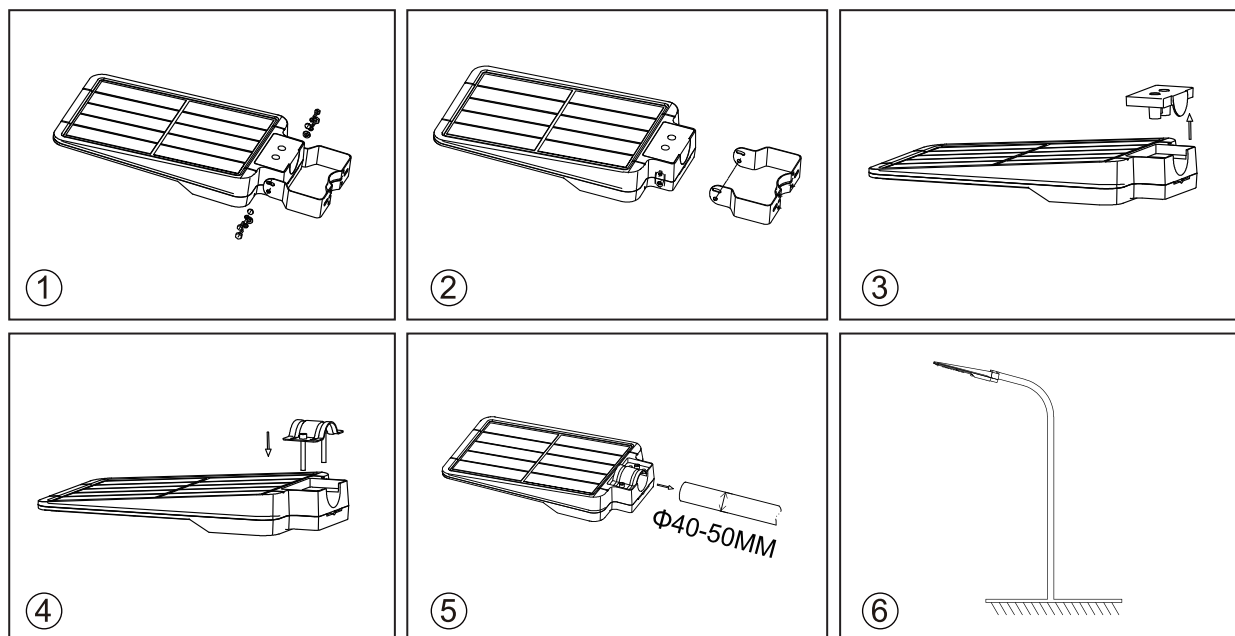

1. Prepare lamp, accessories and tools well firstly.
 2. Loosen the screws and take off the bracket. (Picture 1 2)
 3. Move the cover of lamp socket. (Picture 3))
 4. Fix the arch-shaped bracket onto the lamp socket (do not lock first). (Picture 4)
 5. Set up the lamp onto the lamp pole. (Picture 5)
 6. Adjust the lamp and balance it, then lock the arch-shaped bracket. (Picture 6)
- *This installation applies to the poles with a diameter of $\Phi 40-50\text{MM}$.

BATTERY REPLACEMENT INSTRUCTIONS

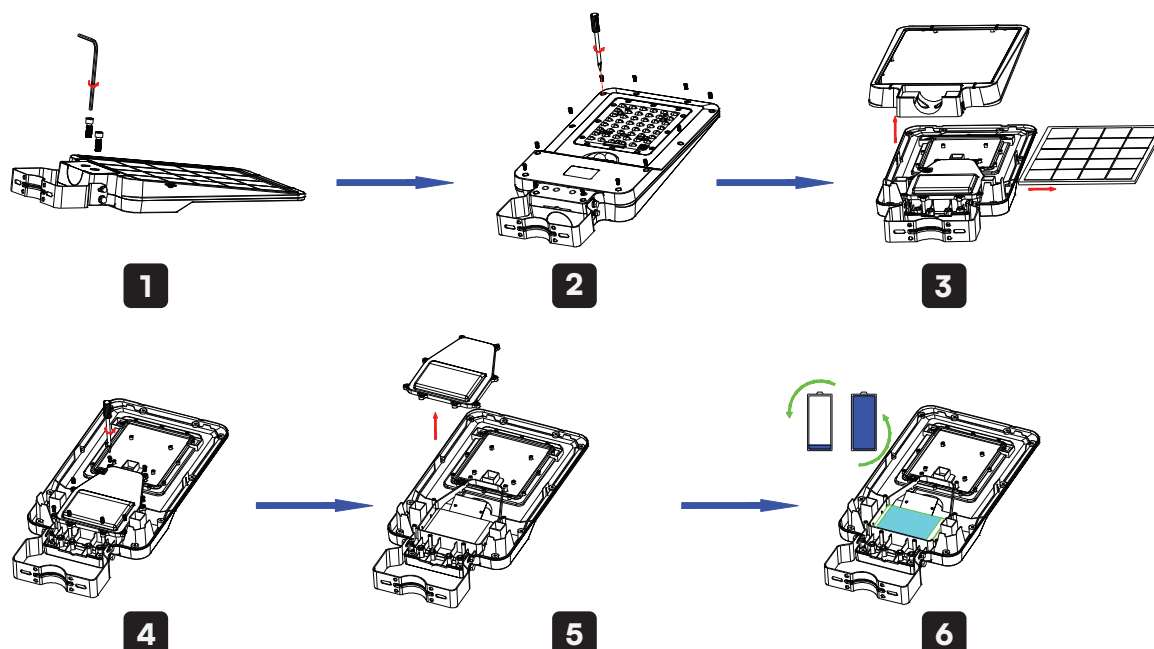

1. Loosen the cover plate screws and remove the cover plate.
2. Loosen the cover screws.
3. Remove the cover and solar panel separately.
4. Loosen the battery cover screws.
5. Remove the battery cover.
6. Remove the battery and disconnect the battery terminal to proceed with replacement.

SOLAR PANEL MAINTENANCE & WARNING

- Do not use solvents, petrol, etc. Otherwise the light will be damaged.
- Clean the light with a dry, lint-free cloth.
- Check the solar panel for dirt regularly. If dirt is present remove it to guarantee flawless function of the product.
- Especially during the winter, keep the product free from snow and ice.
- Confirm installation direction is correct (solar panel should be at top)
- Confirm no objects blocking the solar panel to receive sunlight
- Keep away from the fire.
- Don't immerse in the water

IMPORTANT NOTES

- This product contains battery type "Secondary" (rechargeable).
- Electrical and electronic equipment that has become waste is known as old equipment/device. Old devices must not be disposed of with other household waste.
- Owners of old devices at the end of its service life must return the device by taking them to the collection points set up by public waste disposal authorities or distributors. This return does not entail any costs for you.
- Owners of old devices have an obligation to remove accessible batteries / rechargeable batteries as well as non-destructively removable lamps from the old device prior to return. This does not apply if old devices are being prepared for reuse with the participation of a public law firm.
- Battery removal warning: The battery contained in this product must be removed only by professional personnel only. The battery must never be removed by the end user, if not removed correctly it could damage the battery which could cause fire.
- Batteries removed from an old electronic device should be disposed of separately. This return of battery does not entail any costs for you and the user is obliged to return the battery.
- Please make sure that this product is not powered on when removing the battery. Fire hazard! Avoid short-circuiting the contacts of a detached battery. Do not incinerate the battery. Please handle the battery with Caution!
- If electrical appliances or batteries are disposed of in landfills or dumps, hazardous substances can leak into the groundwater and get into the food chain, damaging your health and well-being.



- The symbol of "Crossed rubbish bins" indicates that this product should not be disposed of with other household wastes and must be collected separately from unsorted municipal waste at the end of its service life.
- Please use the link below to view the online directory of the collection and return points: <https://www.w.ea-r-system.de/ear-verzeichnis/sammel-und-ruecknahmestellen>

V-TAC UK LTD. IN CASE OF ANY QUERY/ISSUE WITH THE PRODUCT PLEASE REACH OUT TO US AT
SUPPORT@VTACEXPORTS.COM V-TAC, 5A TUNGSTEN PARK, DOWNS ROAD, WITNEY, OXFORDSHIRE, OX29 0AX

V-TAC WEST EUROPE LTD. IN CASE OF ANY QUERY/ISSUE WITH THE PRODUCT, PLEASE REACH OUT TO US AT:
SUPPORT@V-TAC.EU FOR MORE PRODUCTS RANGE, INQUIRY PLEASE CONTACT OUR DISTRIBUTOR OR NEAREST DEALERS.
V-TAC WEST EUROPE LTD. GROUND FLOOR, 71 LOWER BAGGOT STREET, DUBLIN 02, IRELAND D02 P593
