

- Montageanleitung
- Assembly instructions
- Notice de montage
- Montagehandleiding
- Návod na montáž
- Instrucțiune de montaj
- Navodila za namestitev
- Installationstruktioener



Klebetchnik / bonding technique / fixation à coller / verlijm techniek
Seite / Page / page / Pagina 2 - 11



Schraubtechnik / Profile drilling method / fixation à percer / Schroef techniek
Seite / Page / page / Pagina 12 - 19

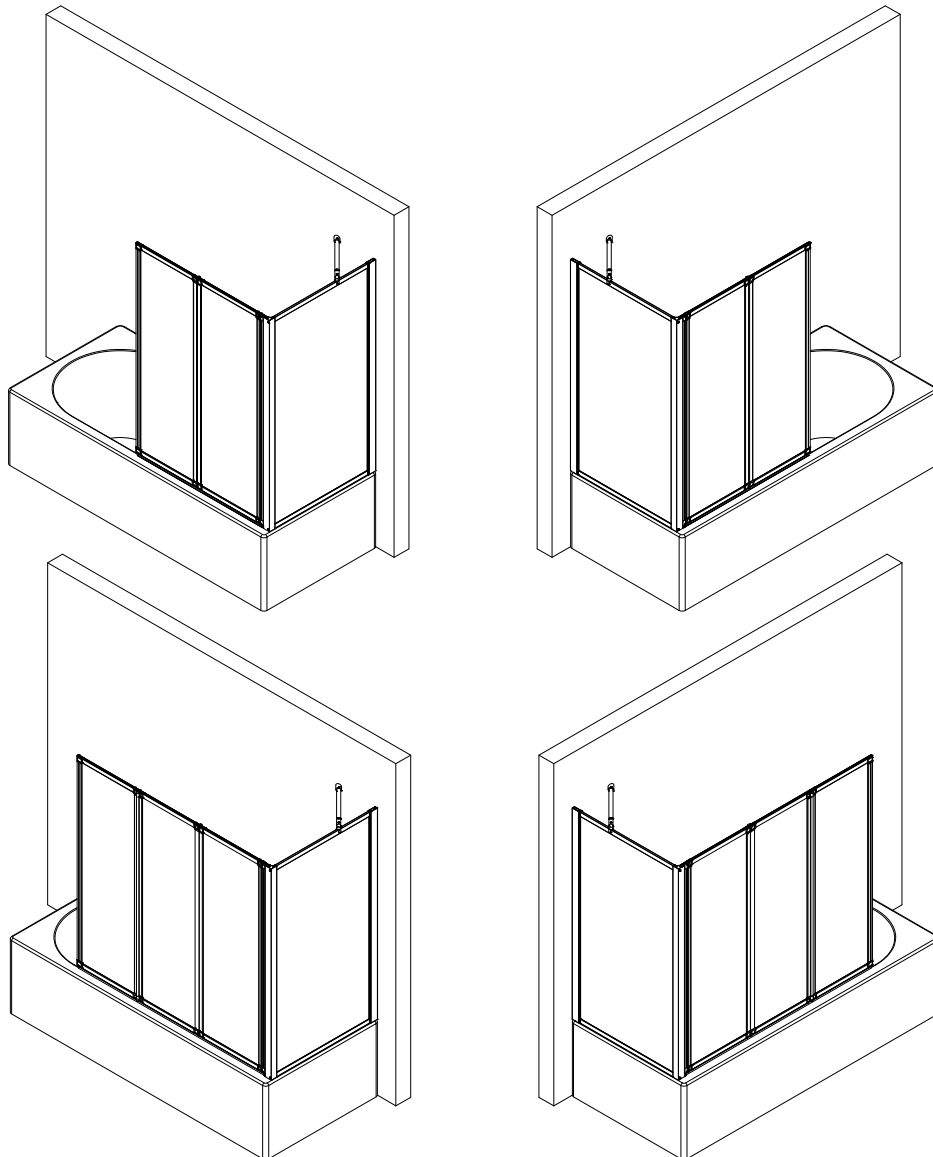

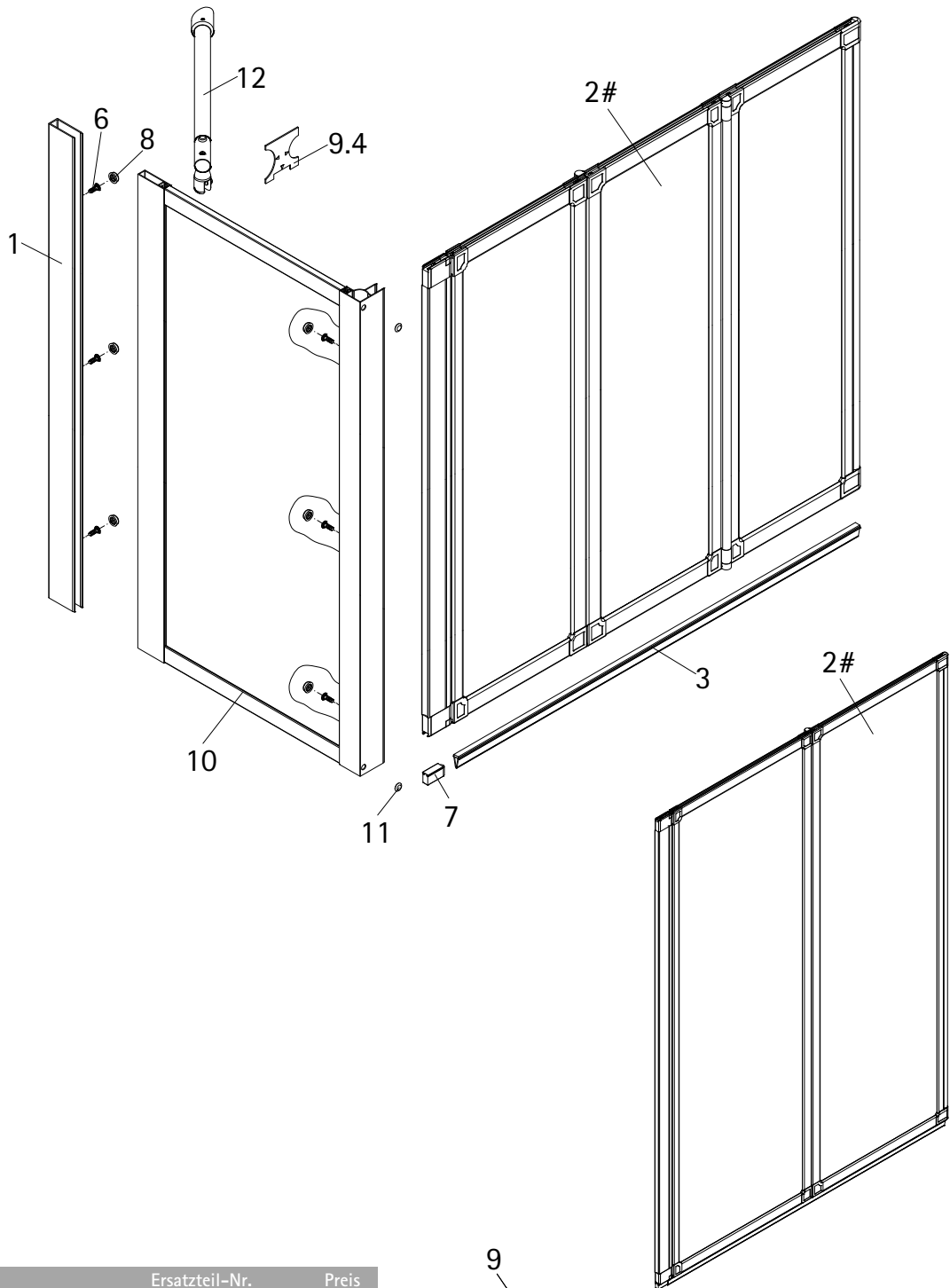

Pos.	Bezeichnung	Ersatzteil-Nr.	Stück	Preis
1	1x Wandanschlussprofil	E60230-6	Stück	86,95 €
2#	1x Wannenaufsatz 2 teilig			
2#	1x Wannenaufsatz 3 teilig			
3	1x Dichtprofil horizontal	E100076-4	Stück	23,95 €
6*	6x Kappenschraube 3,5 x 9,5 mm			
7	1x Endkappe für Dichtprofil	E100080-2	Stück	9,95 €
8*	6x Abdeckkappe für Kappenschraube			
9	1x Klebeset komplett	E100496	Set	59,95 €
9.1	2x Reinigungstuch			
9.2	3x Kleber			
9.3	1x Aufrollhilfe			
9.4	1x Montagehilfe			
10	1x Seitenwand			
11	2x Lochabdeckscheiben			
12	1x Stabilisationsbügel, komplett	E60330	Stück	46,95 €
	* Montagezubehör	E60200-2		16,95 €
	# optional			

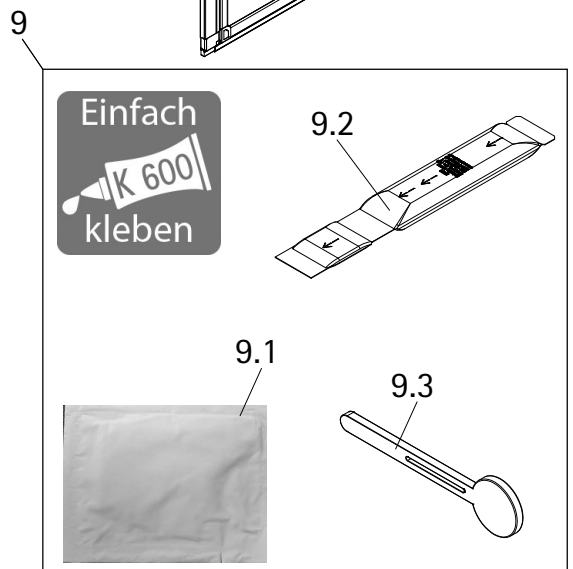

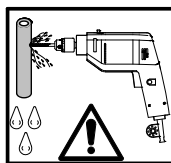
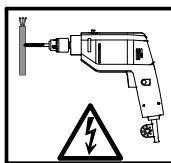
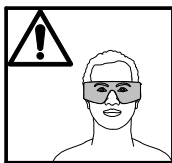
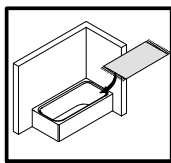

1 Klebtechnik / bonding technique / fixation à coller / verlijm techniek

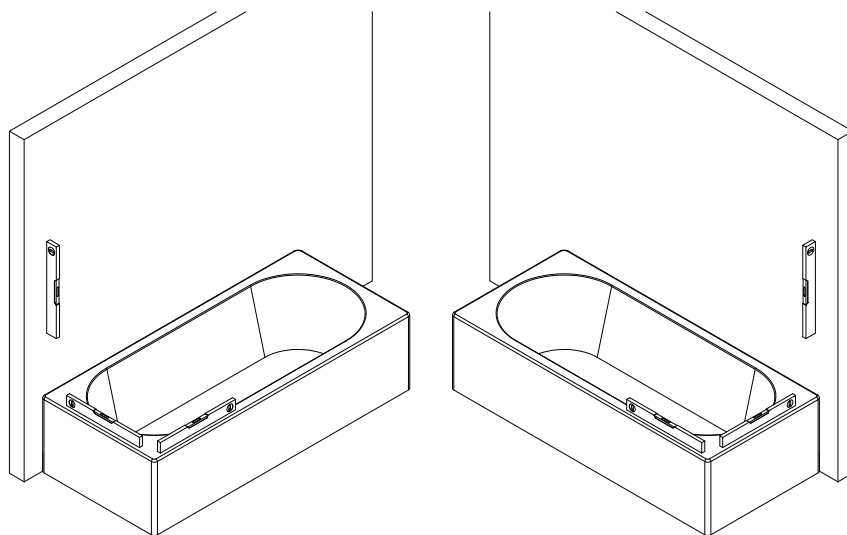

2



- Beipackzettel unbedingt beachten.
- Note: Read enclosed instruction leaflet carefully
- Veuillez impérativement faire attention à la notice explicative.
- Let op: les de bijsluiter

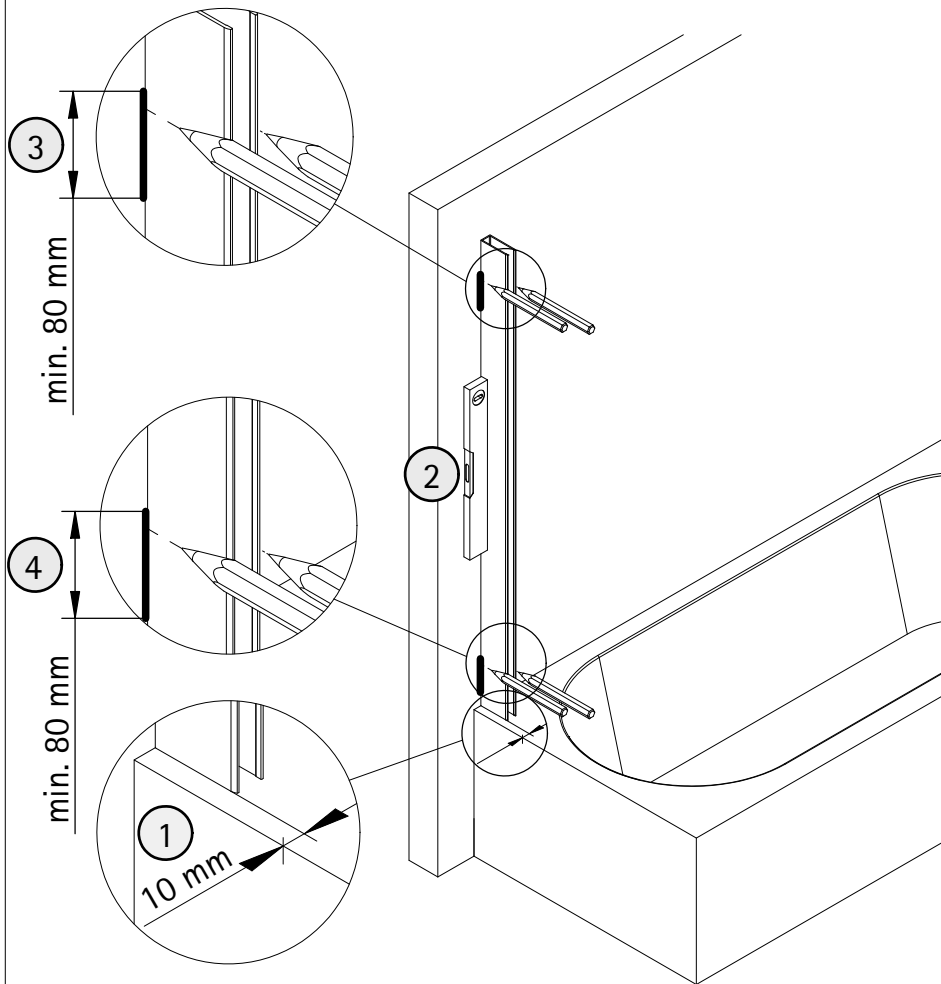

3

* Nicht im Lieferumfang enthalten,
not included in delivery,
non fourni dans l'emballage,
niet bij levering inbegrepen,

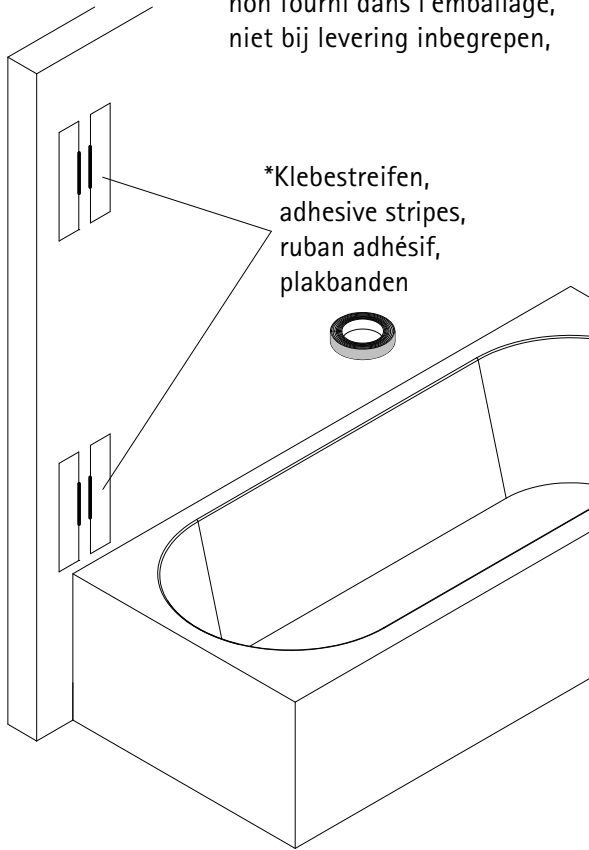

4

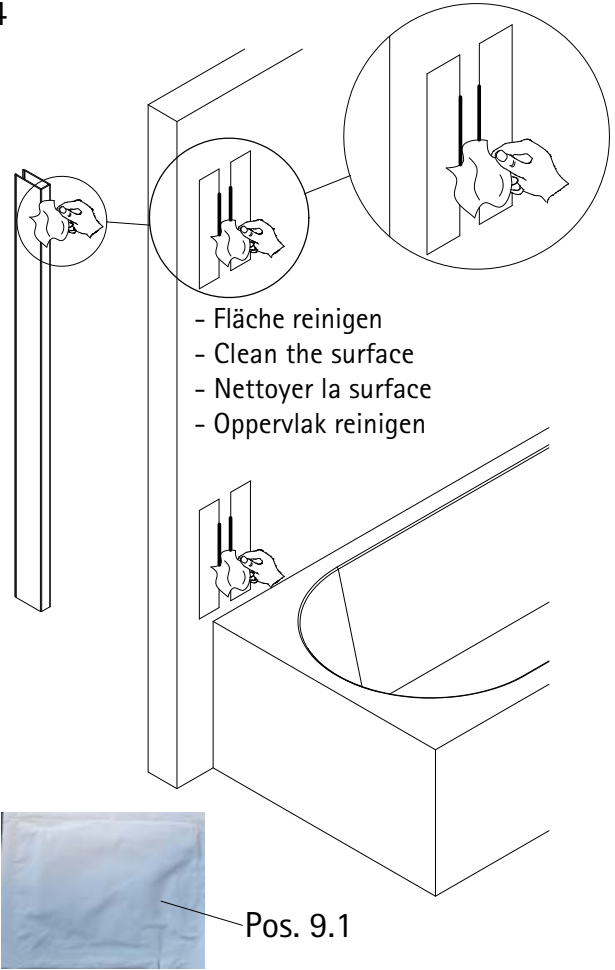

5

- Kleber nach Anleitung anrühren und auf die gekennzeichneten Flächen des Wandanschlußprofils auftragen.
- Mix glue according to the instructions and apply the mixture on the marked areas.
- Appliquez la colle mélangée selon les instructions sur la surface marquée du profilé.
- Lijm volgens voorschrift omroeren en op de gemarke oppervlaktes van het wandaansluitprofiel aanbrengen.

*Anrührunterlage
stirring support
support pour mélanger
aanroer-ondergrond

Pos. 9.3

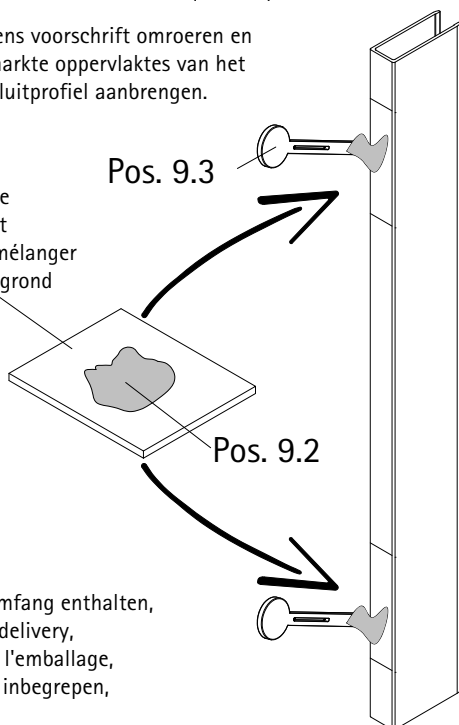

Pos. 9.2

* Nicht im Lieferumfang enthalten,
not included in delivery,
non fourni dans l'emballage,
niet bij levering inbegrepen,

6

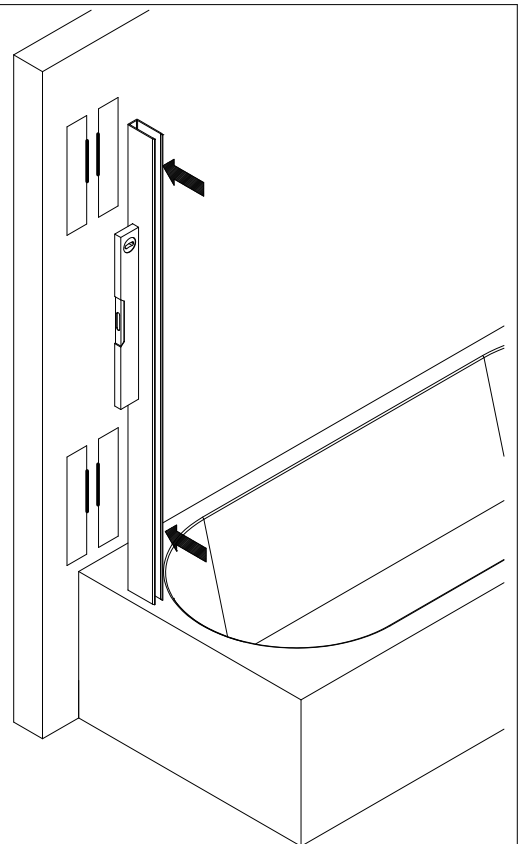

- Profil positionieren und andrücken.
- Position profile and press it onto the wall.
- Positionnez le profilé et appuyez le fortement contre le mur.
- Profiel plaatsen en aandrukken.

7

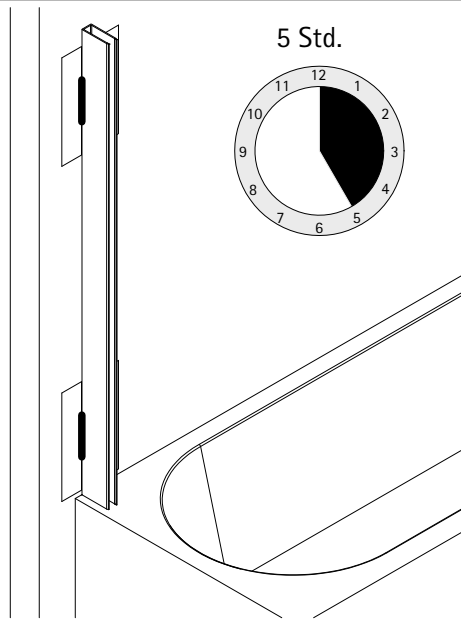

- Nach ca. 5 Stunden kann die Montage der Badewannenfaltwand begonnen werden.
- After approx. 5 hours the bath screen can be installed.
- Après env. 5 heures le montage du pare-baignoire peut démarrer.
- Na 5 uur kan met de montage van de badwand worden gestart.

8

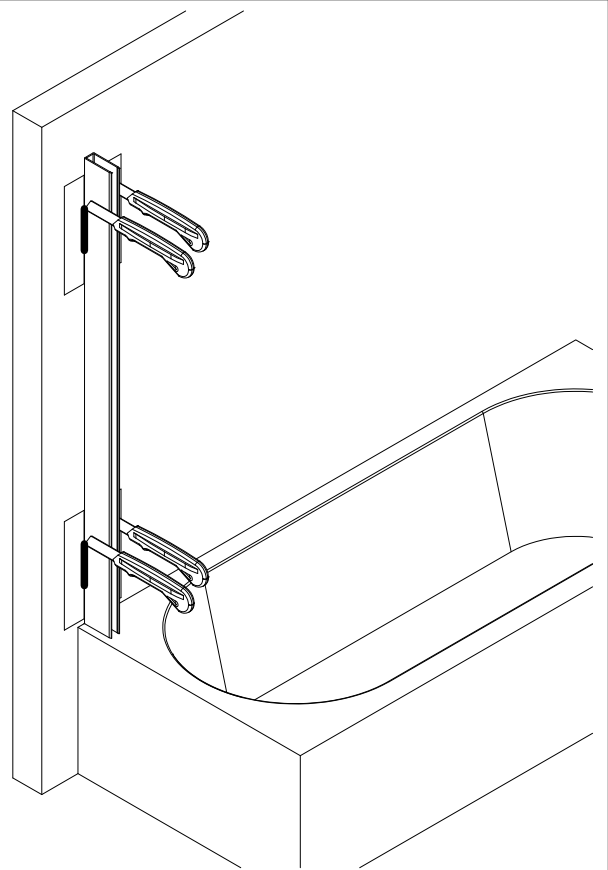

- Überstehenden Kleber entfernen.
- Remove overlying glue.
- Enlevez le surplus de la colle.
- Restlijm verwijderen.

9

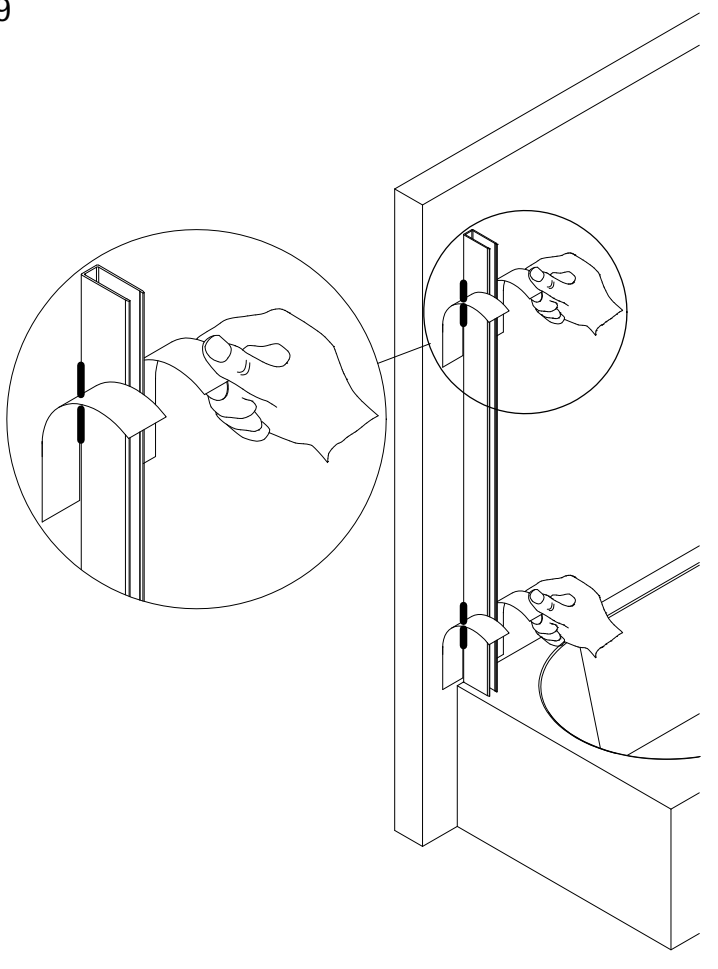

10

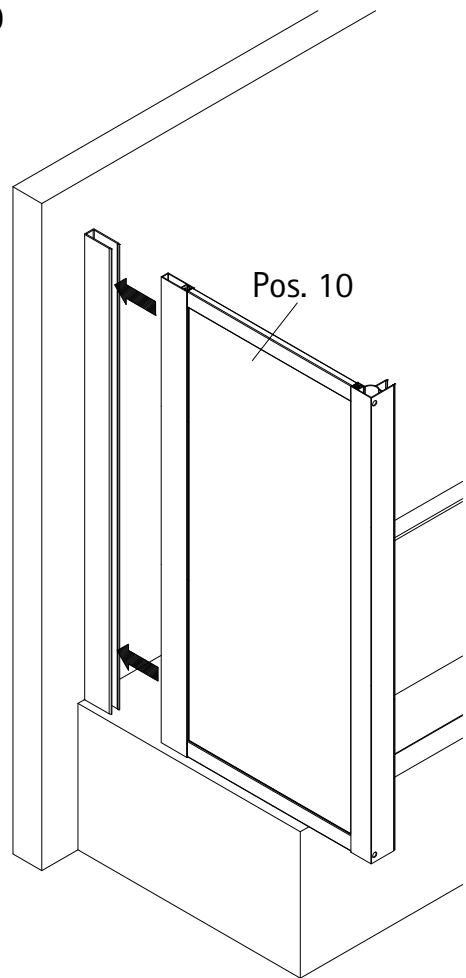

11

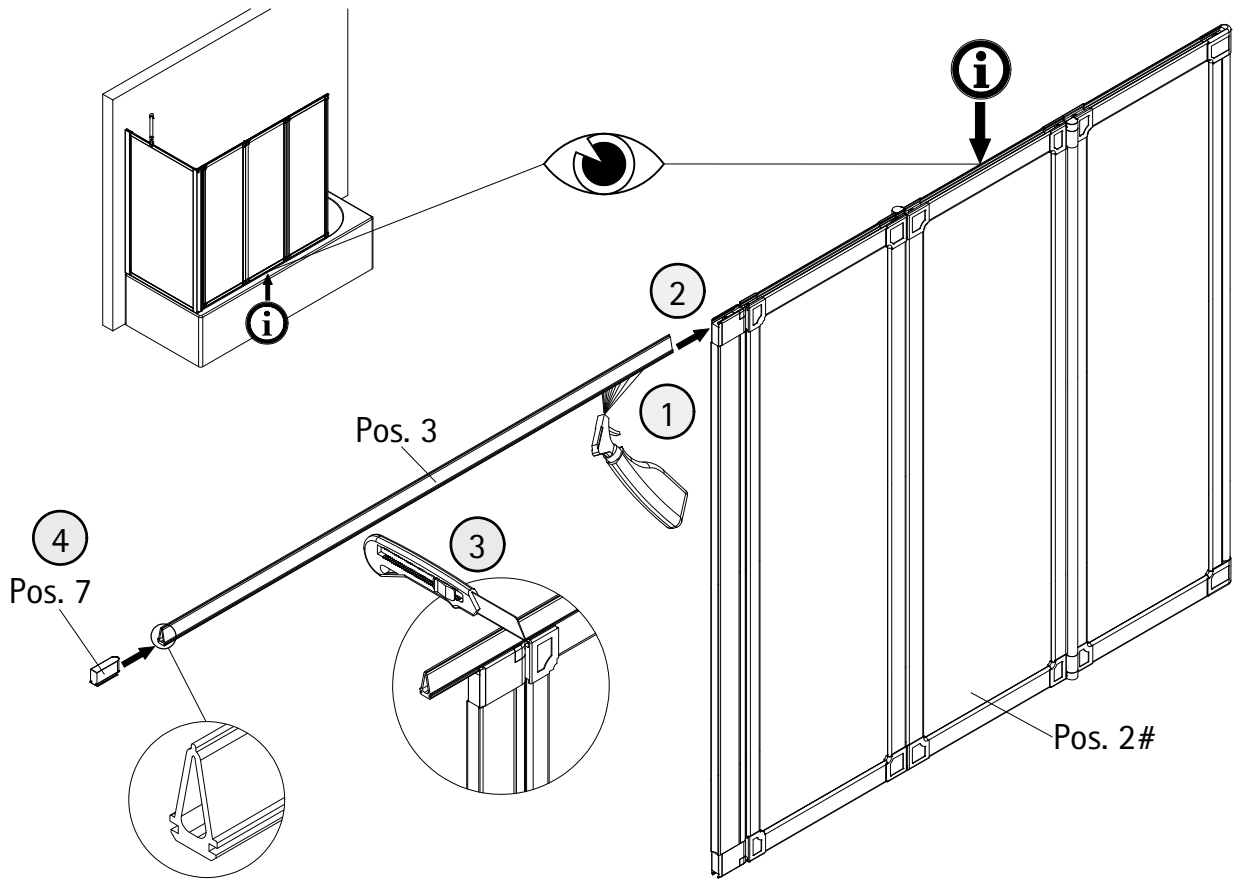

optional, en option, optioneel

12

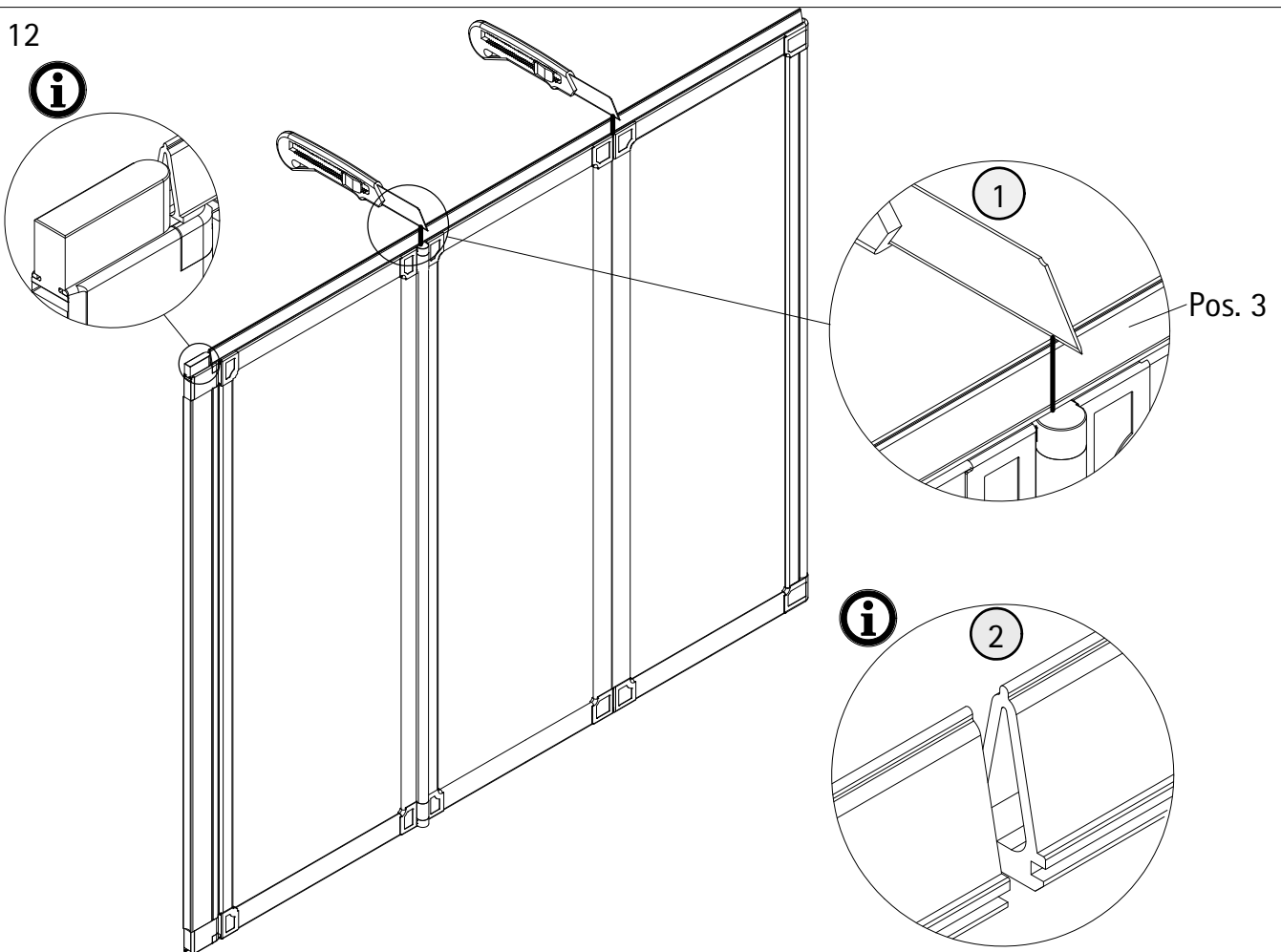

13

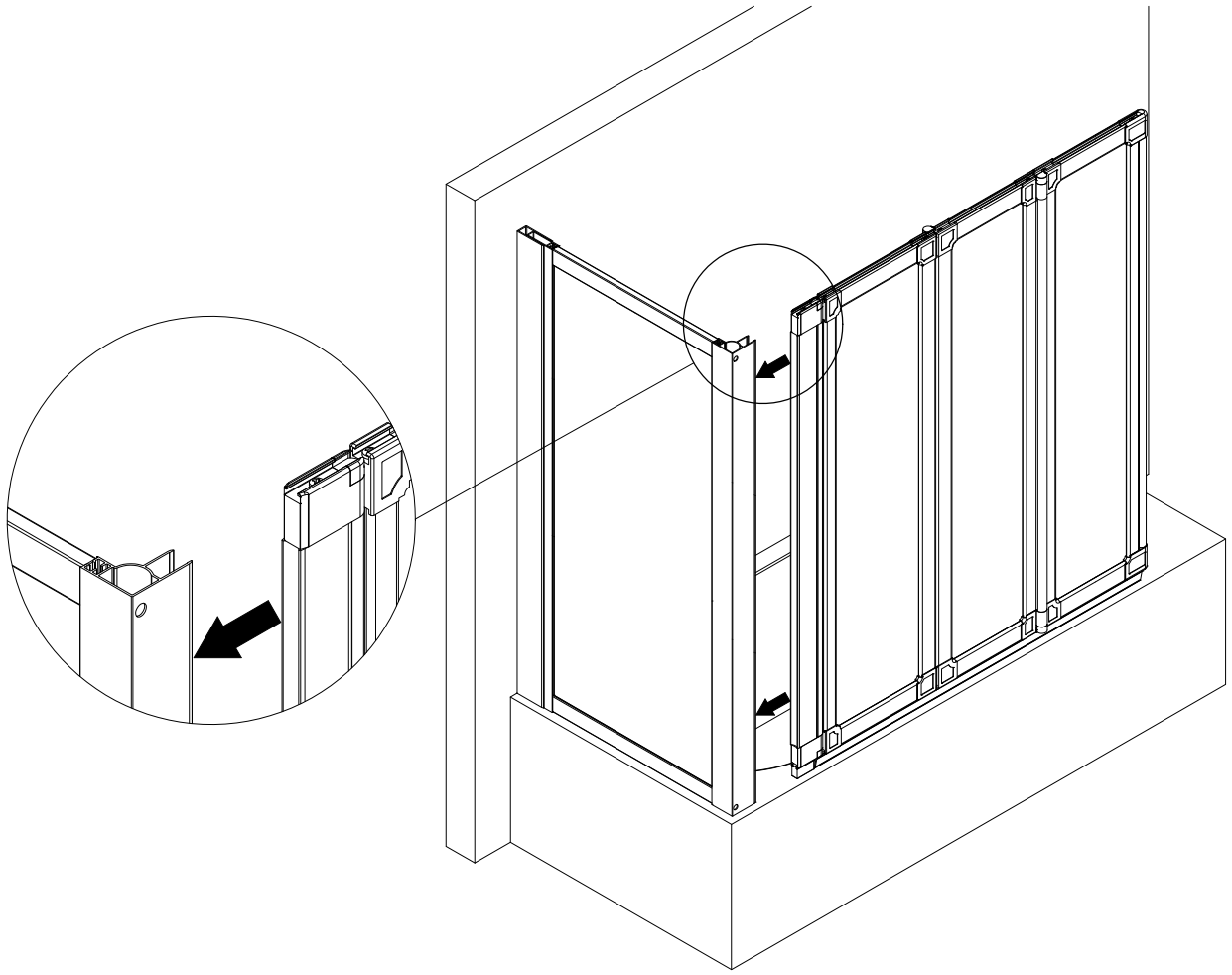

14

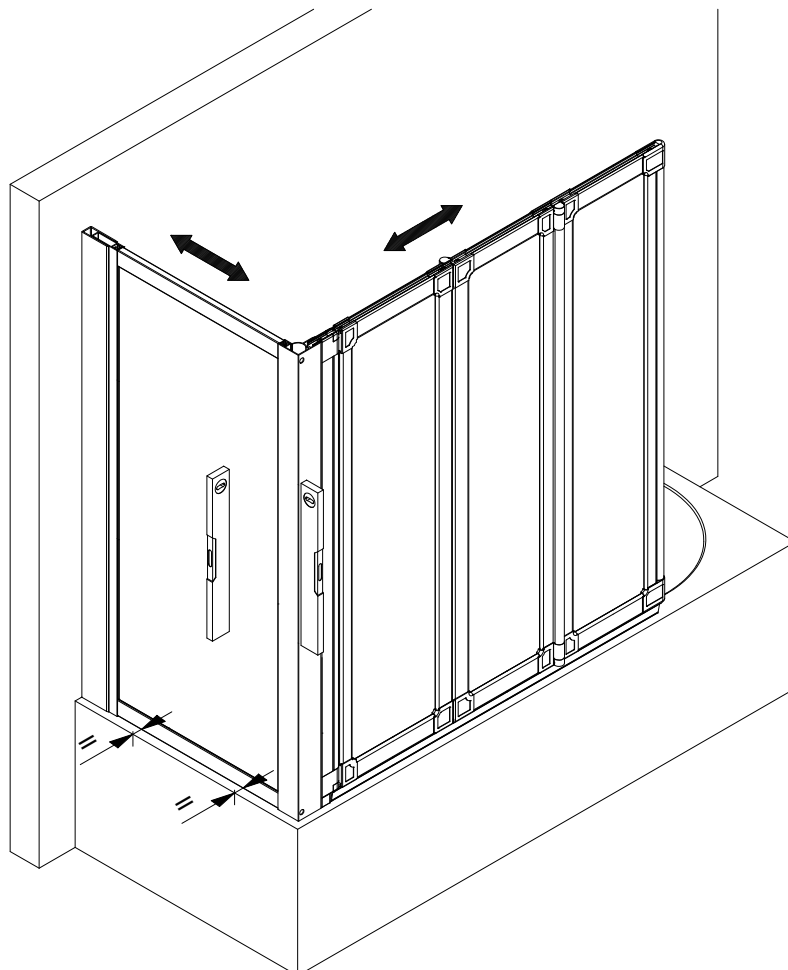

15

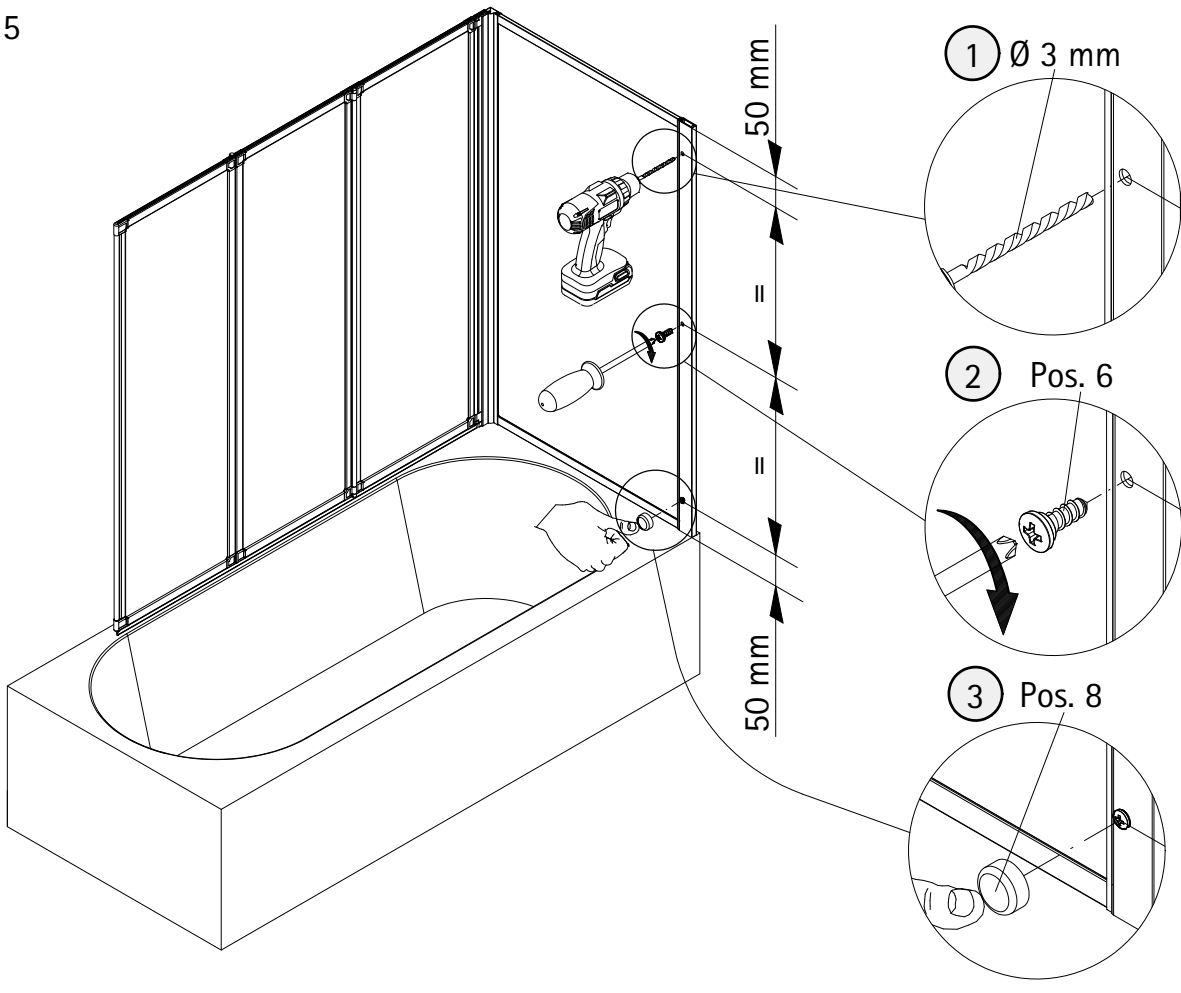

16

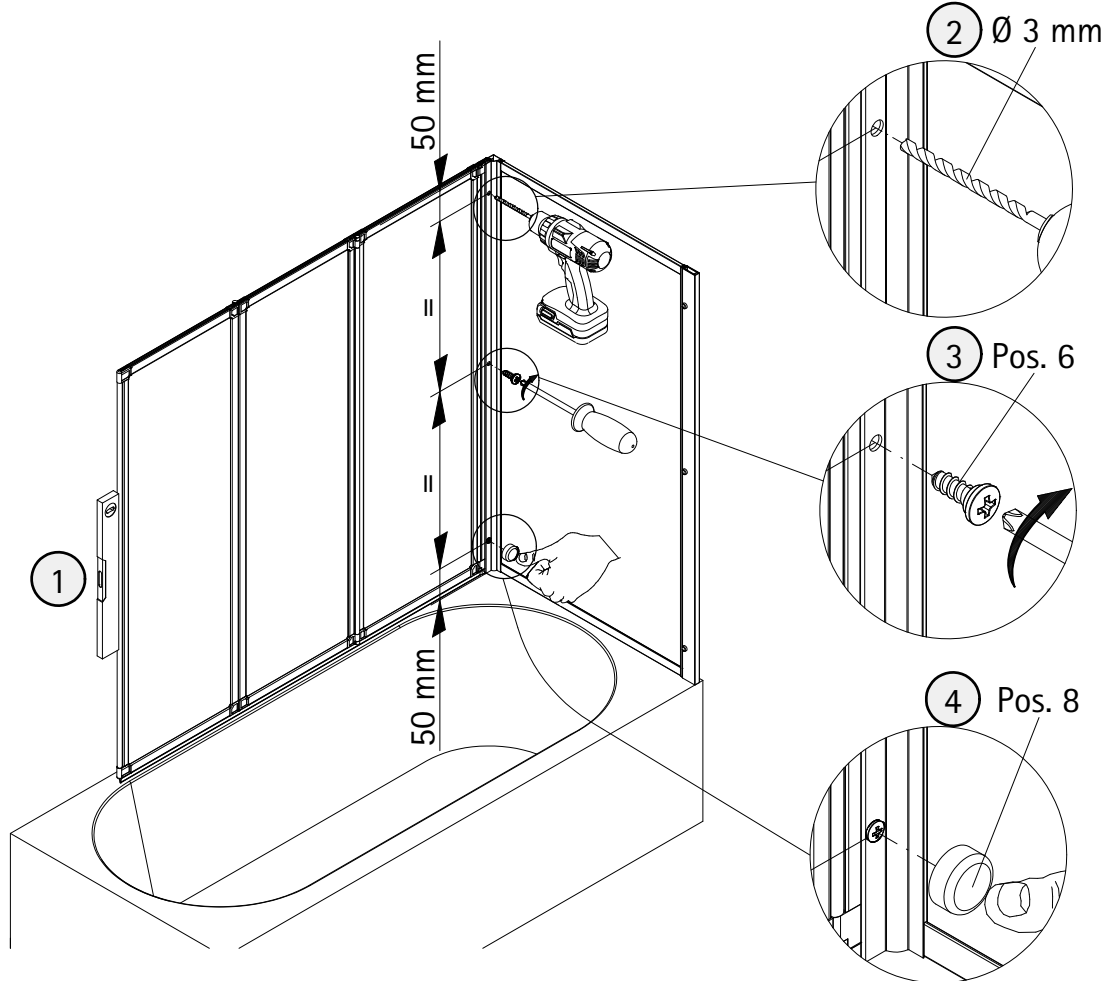

17



- Beipackzettel unbedingt beachten.
- Note: Read enclosed instruction leaflet carefully
- Veuillez impérativement faire attention à la notice explicative.
- Let op: les de bijsluiter

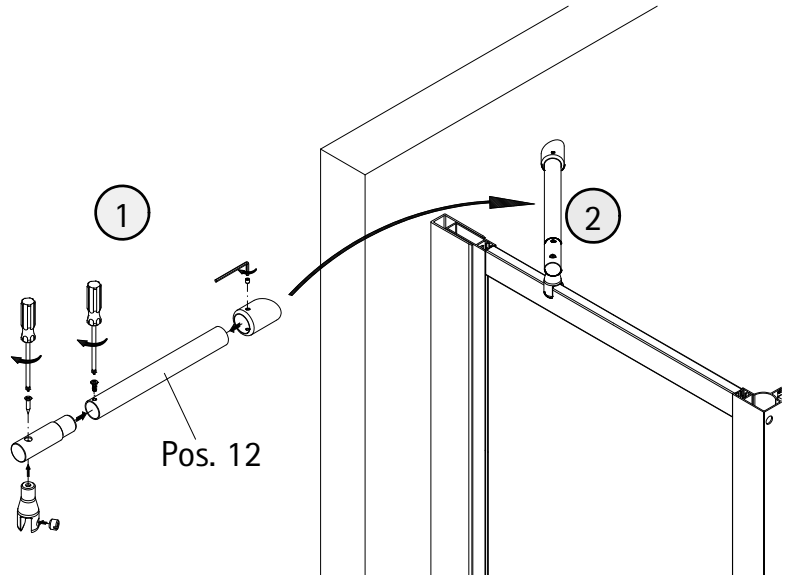

18

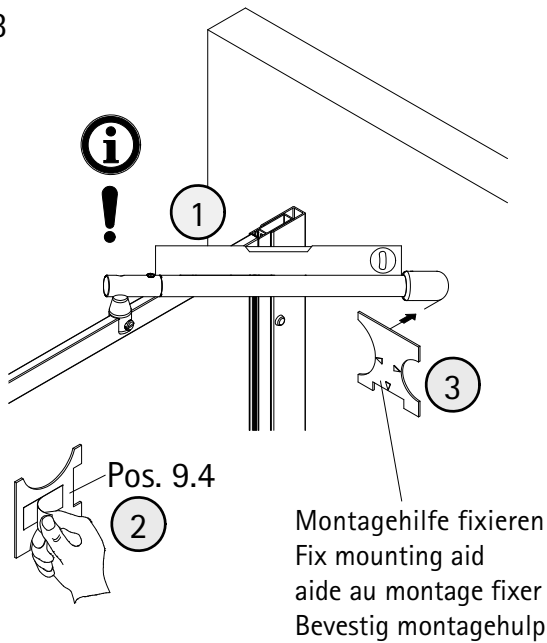

19

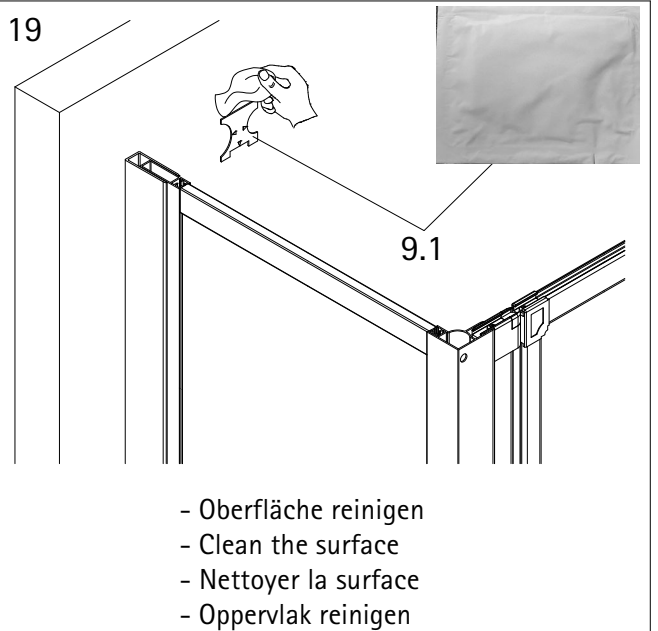

20

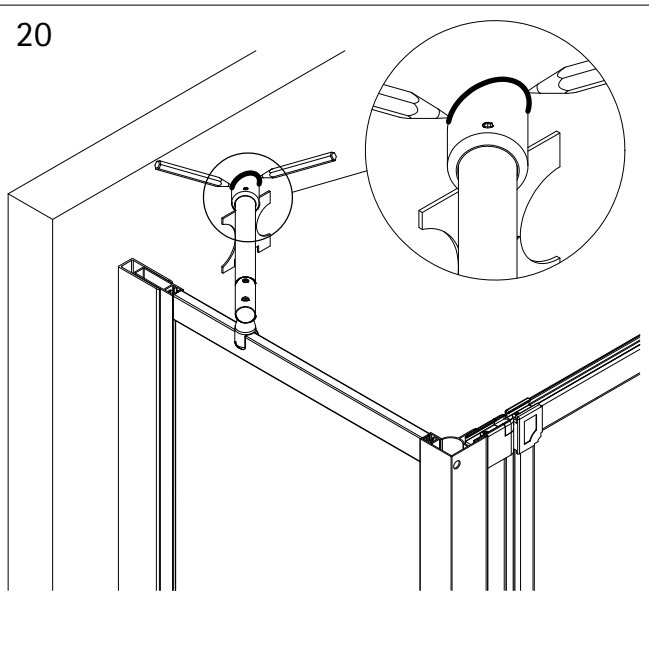

21

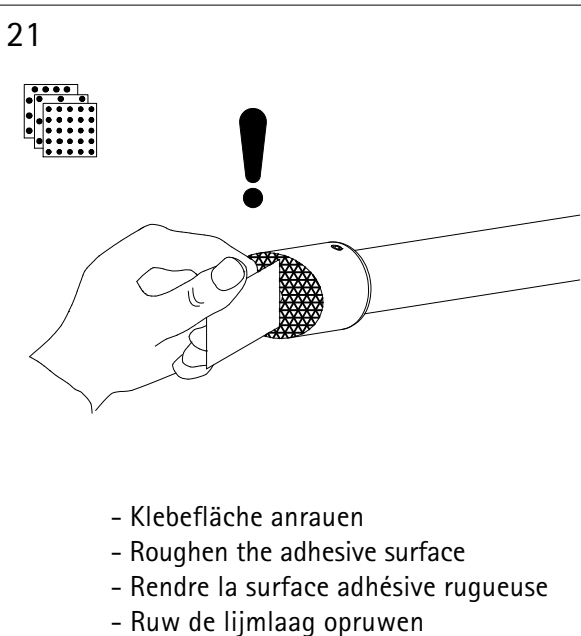

22

- Kleber nach Anleitung anrühren und auf die gekennzeichnete Fläche des Stabilisationsbügels auftragen.
- Mix glue according to the instructions and apply the mixture on the marked areas.
- Appliquez la colle mélangée selon les instructions sur la surface de la barre de stabilisation.
- Lijm volgens voorschrift omroeren en op de gemerkte oppervlaktes van het stabilisatie stang aanbrengen.

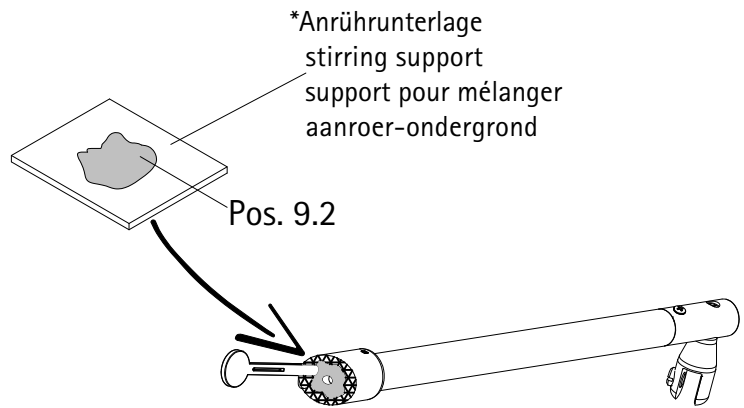

* Nicht im Lieferumfang enthalten,
not included in delivery,
non fourni dans l'emballage,
niet bij levering inbegrepen,

23

5 Std.

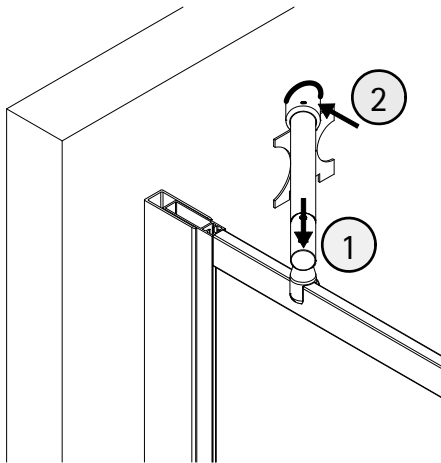

- positionieren und andrücken.
- Position press in onto the wall.
- Positionnez et appuyez le fortement contre le mur.
- plaatsen en aandrukken.

24

- Nach 5 Stunden kann die Montage fortgesetzt werden.
- After approx 5 the installation process can be continued.
- Après 5 heures le montage peut continuer.
- Na 5 uur kan met de montage worden vervolgd.

25

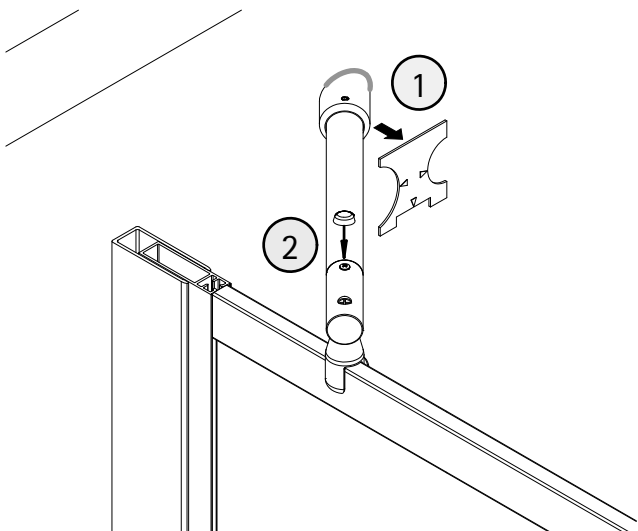

26

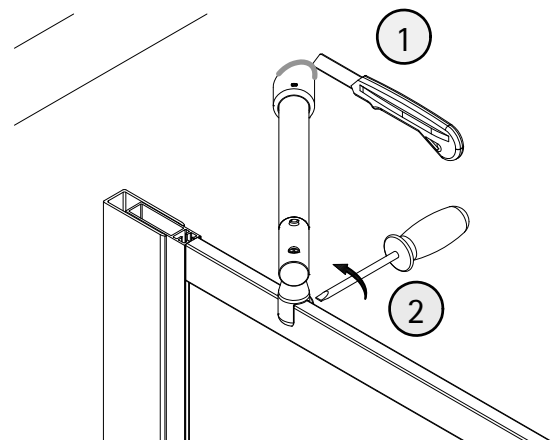

- Überstehenden Kleber entfernen.
- Remove overlying glue.
- Enlevez le surplus de la colle.
- Restlijm verwijderen.

27

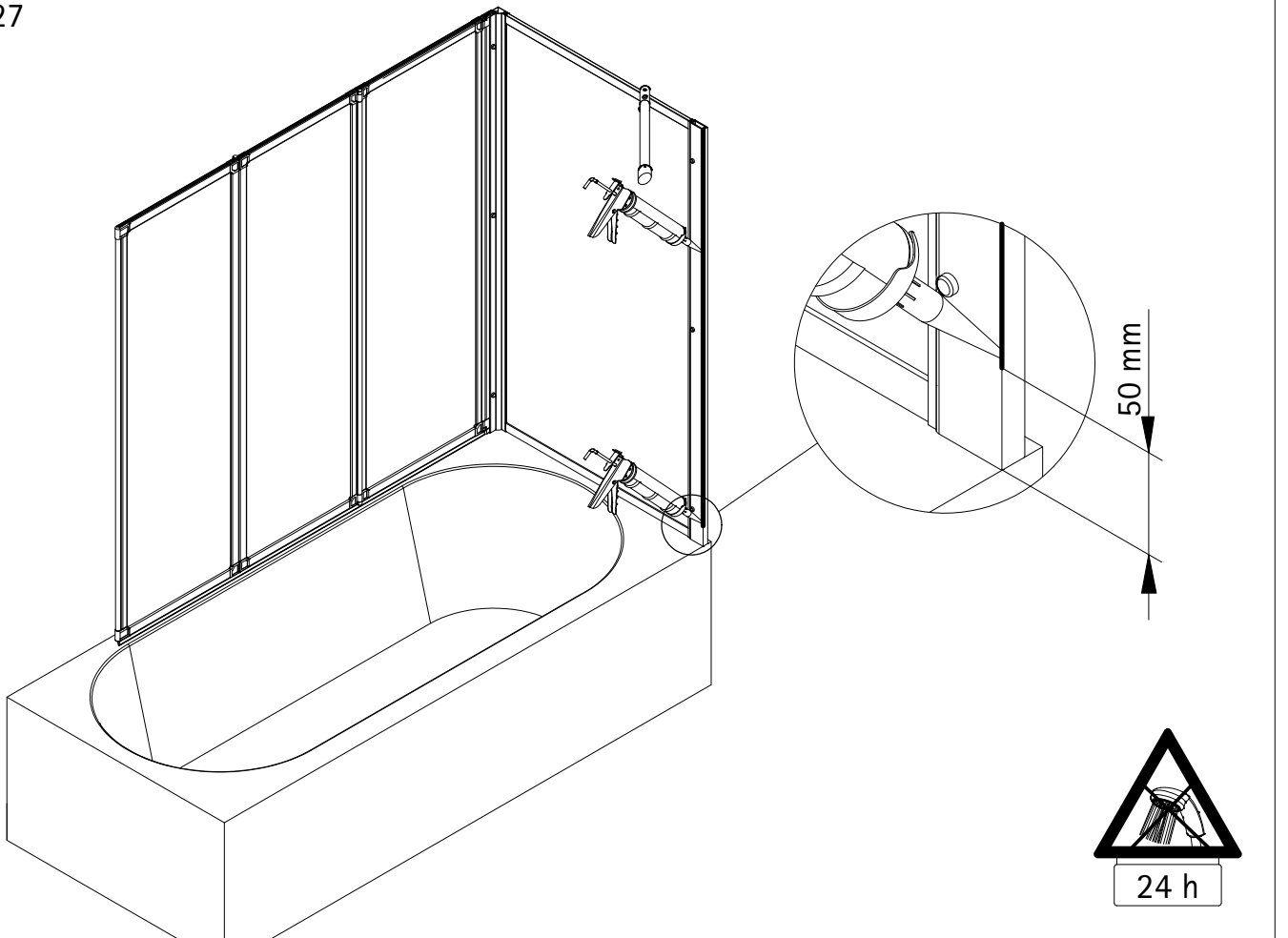

28

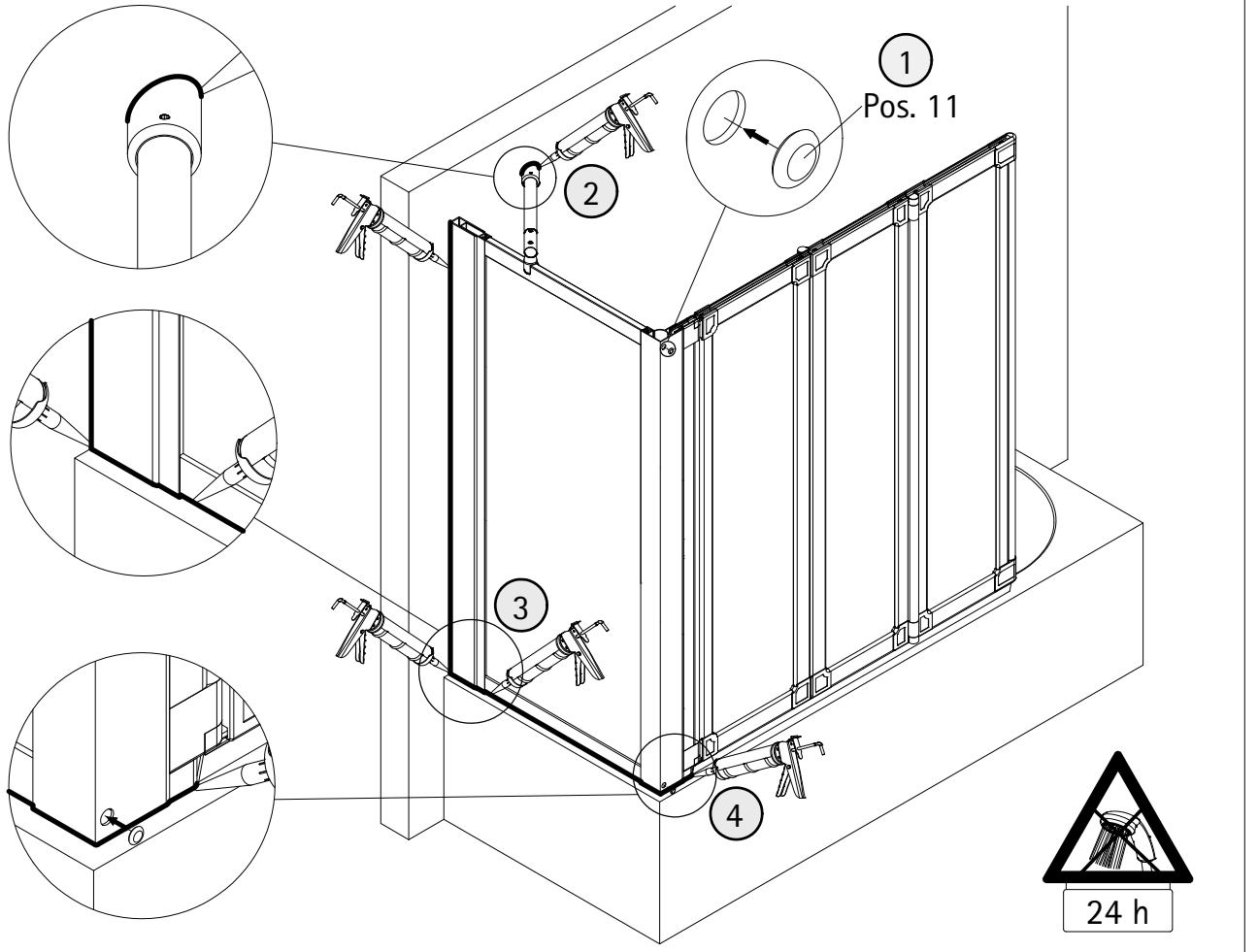

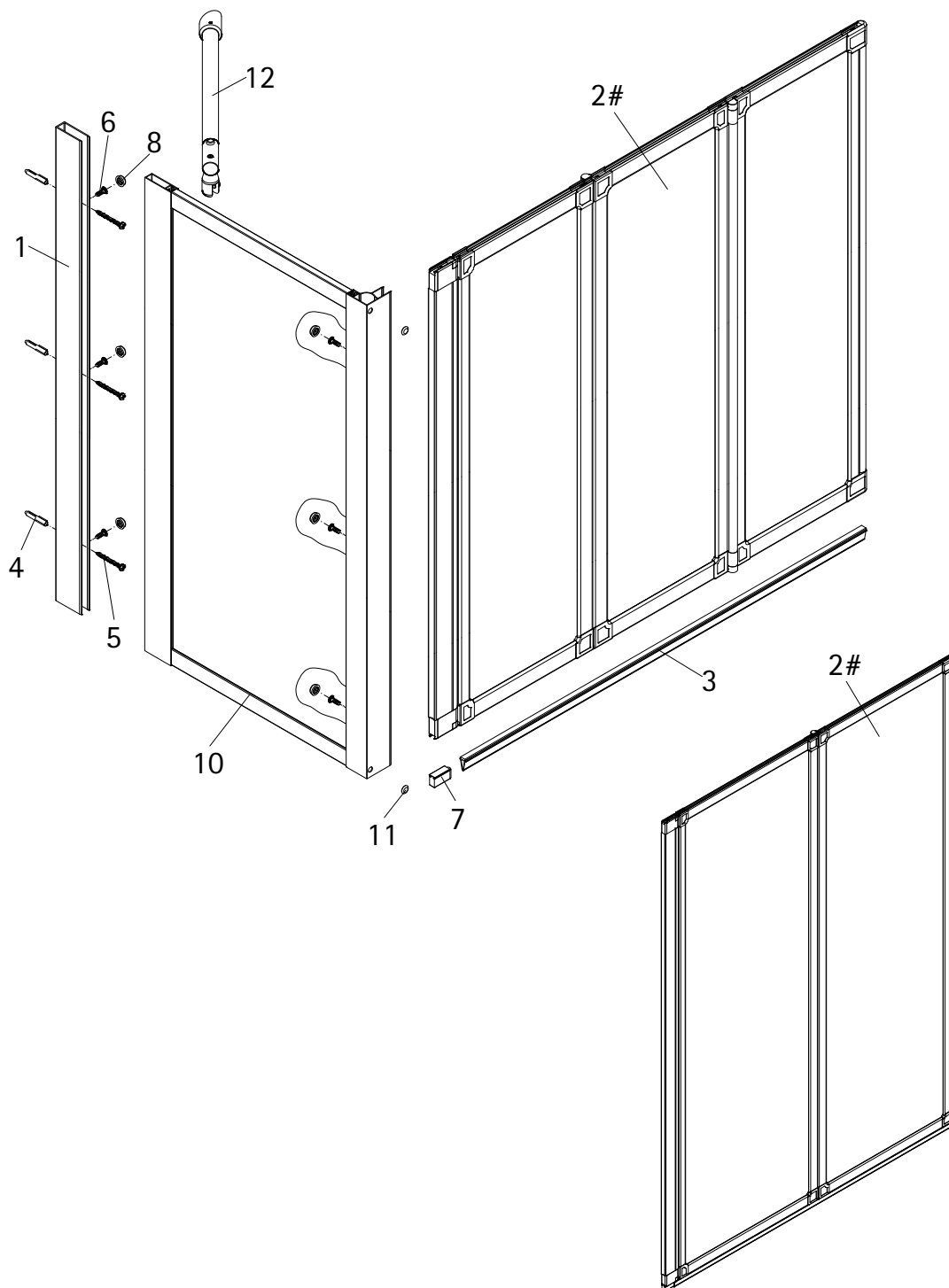

Pos.	Bezeichnung	Ersatzteil-Nr.	Preis
1	1x Wandanschlussprofil	E60230-6	Stück 86,95 €
2#	1x Wannenaufsatz 2 teilig		
2#	1x Wannenaufsatz 3 teilig		
3	1x Dichtprofil horizontal	E100076-4	Stück 23,95 €
4*	3x Dübel S6		
5*	3x Linsen-Blechschrabe 4,2 x 45 mm		
6*	6x Kappenschraube 3,5 x 9,5 mm		
7	1x Endkappe für Dichtprofil	E100080-2	Stück 9,95 €
8*	6x Abdeckkappe für Kappenschraube		
10	1x Seitenwand		
11	2x Lochabdeckscheiben		
12	1x Stabilisationsbügel, komplett	E60330	Stück 46,95 €
	* Montagezubehör	E60200-2	16,95 €
	# optional		

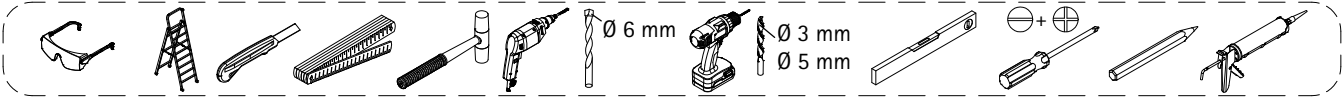
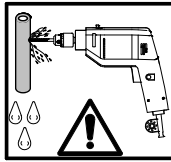
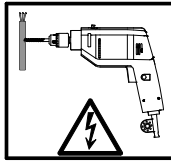
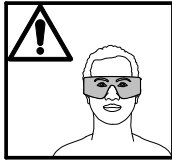
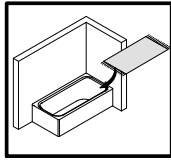

1 Schraubtechnik / Profile method / fixation à percer / Schroef techniek

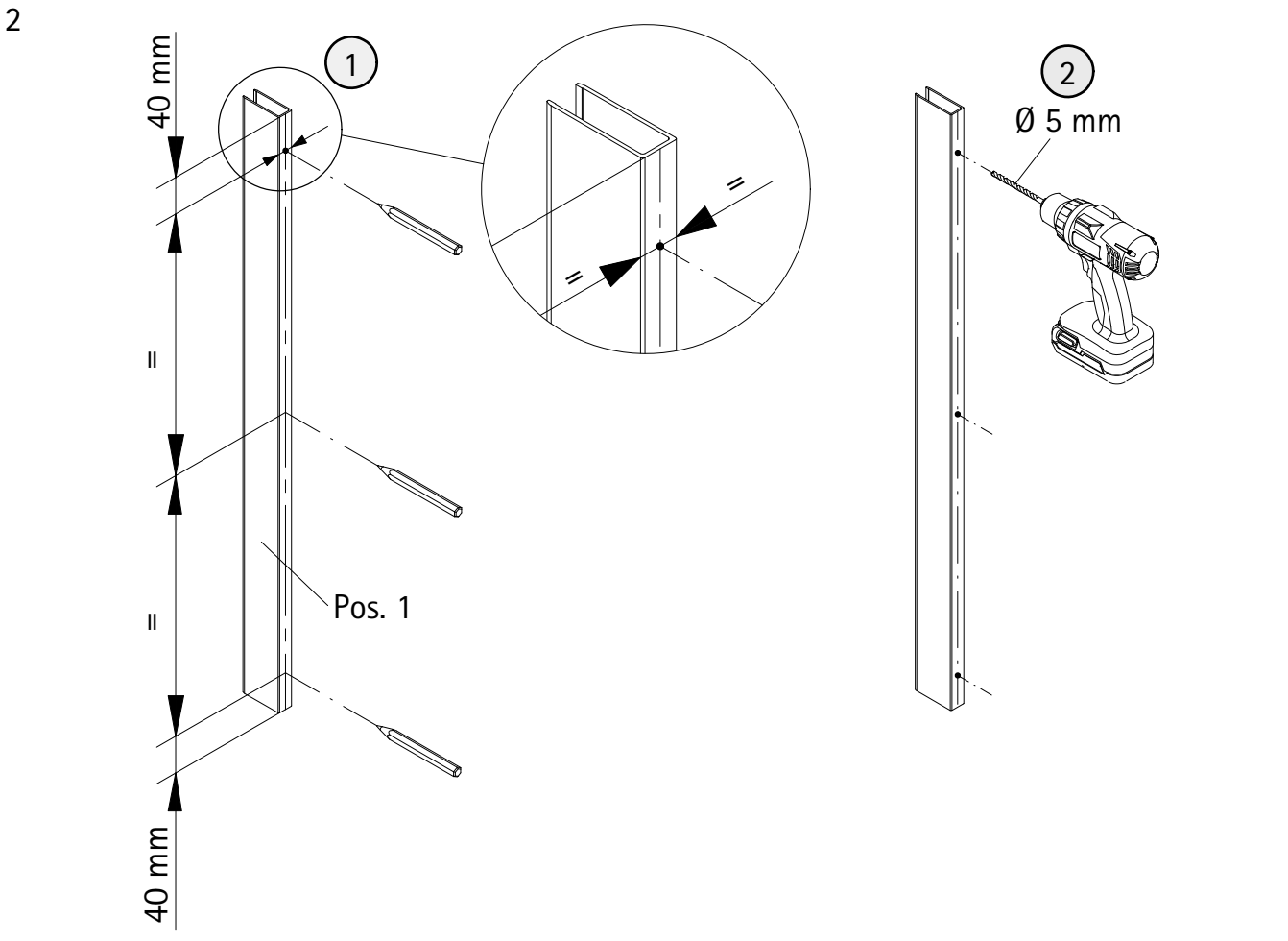
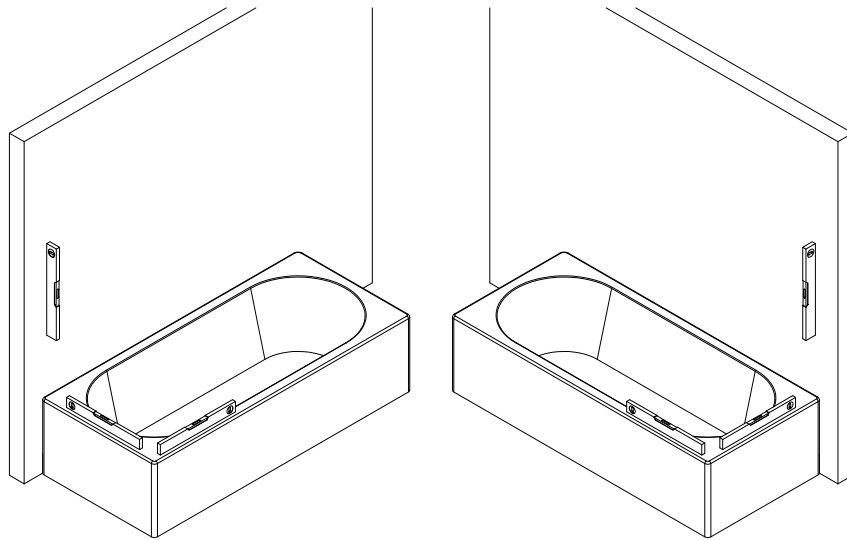

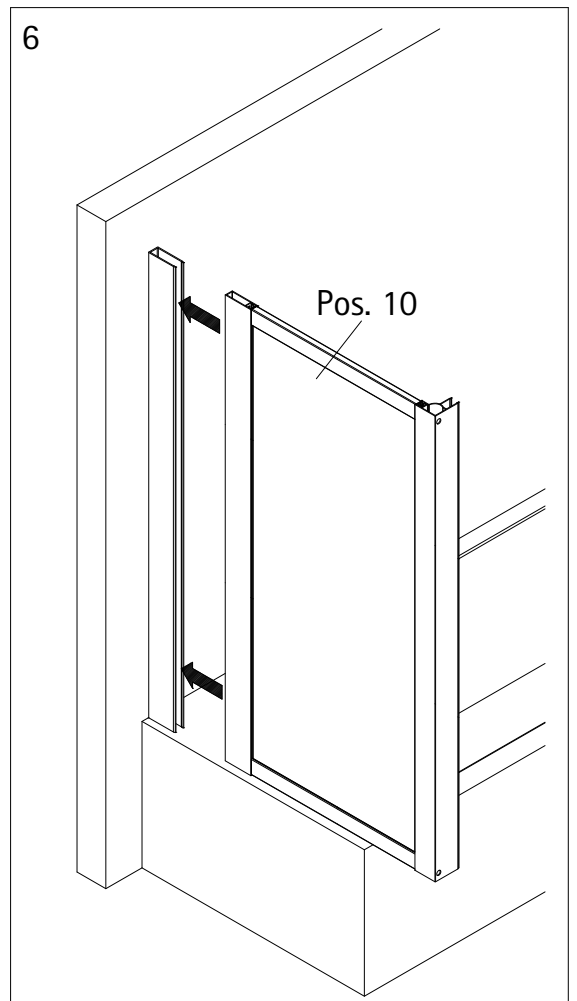
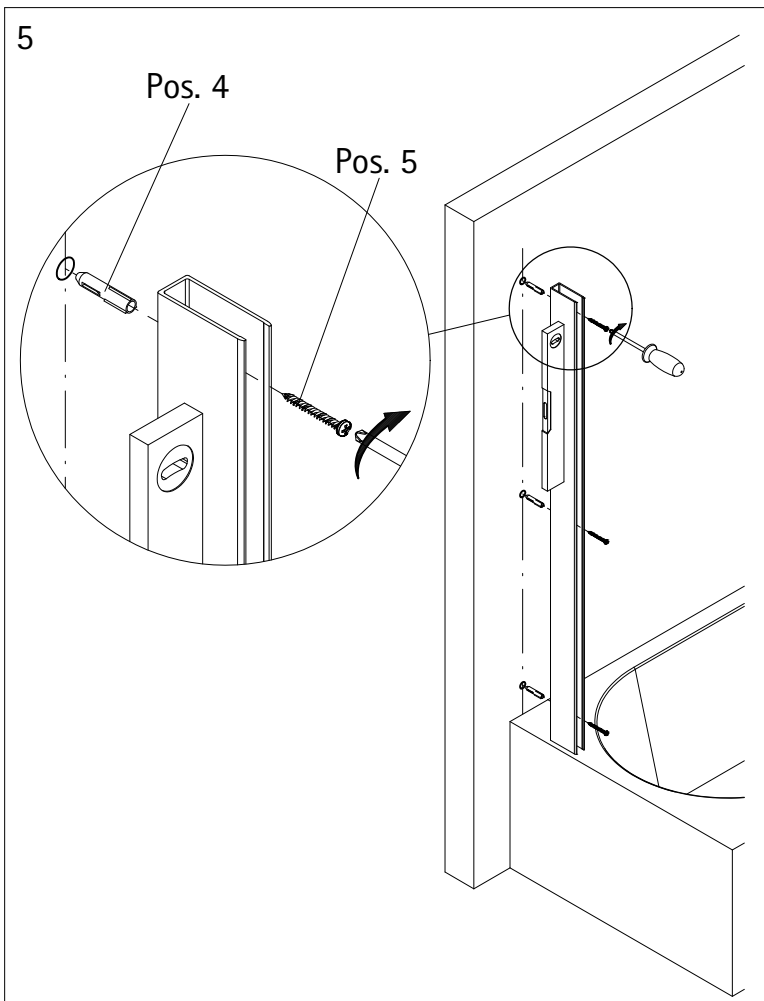
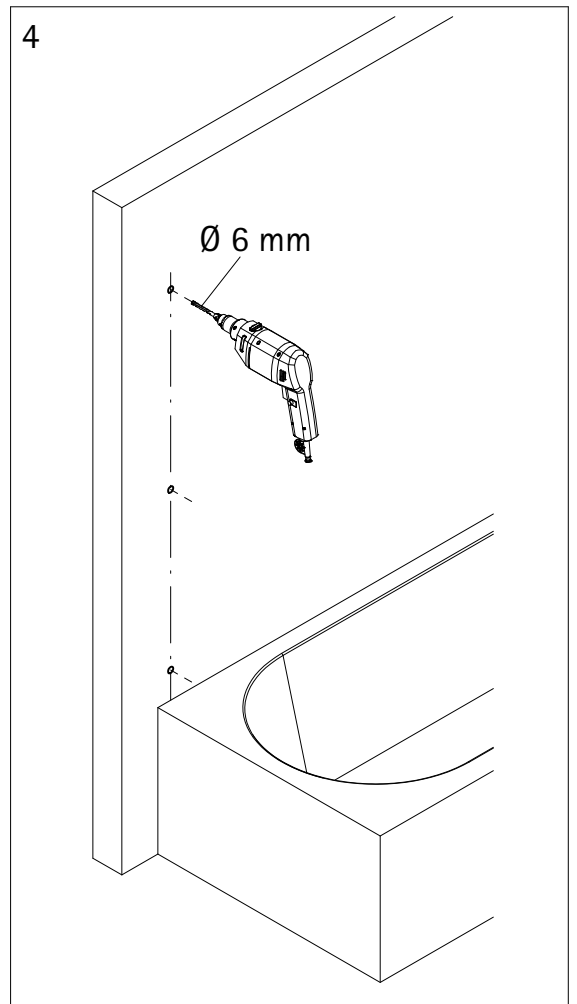
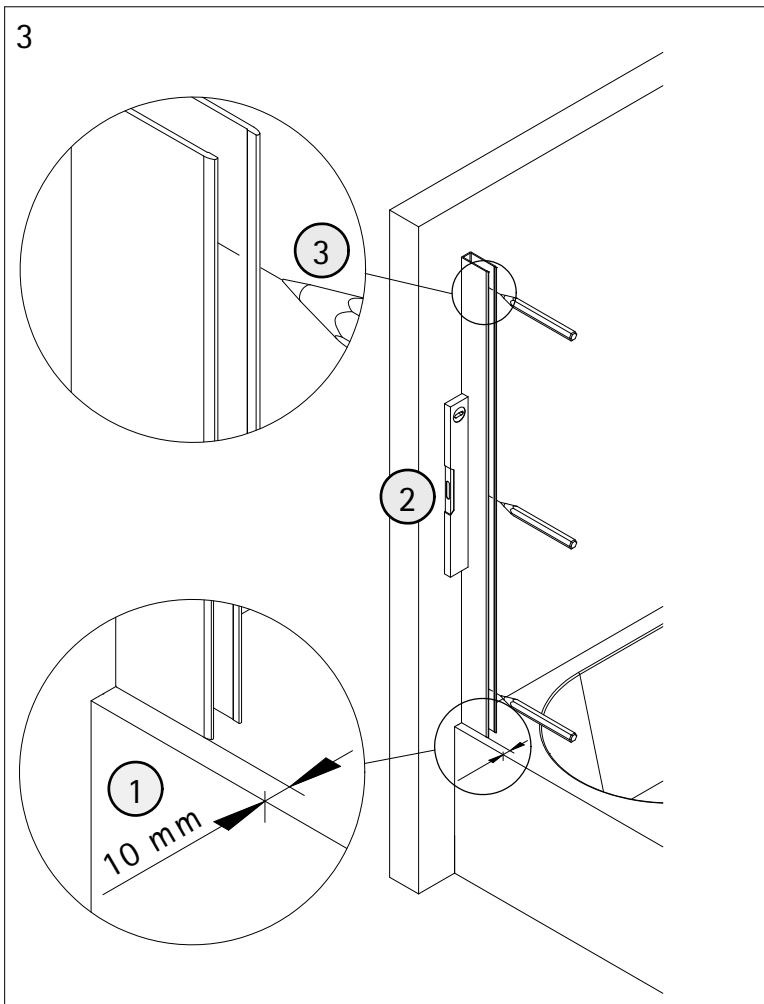

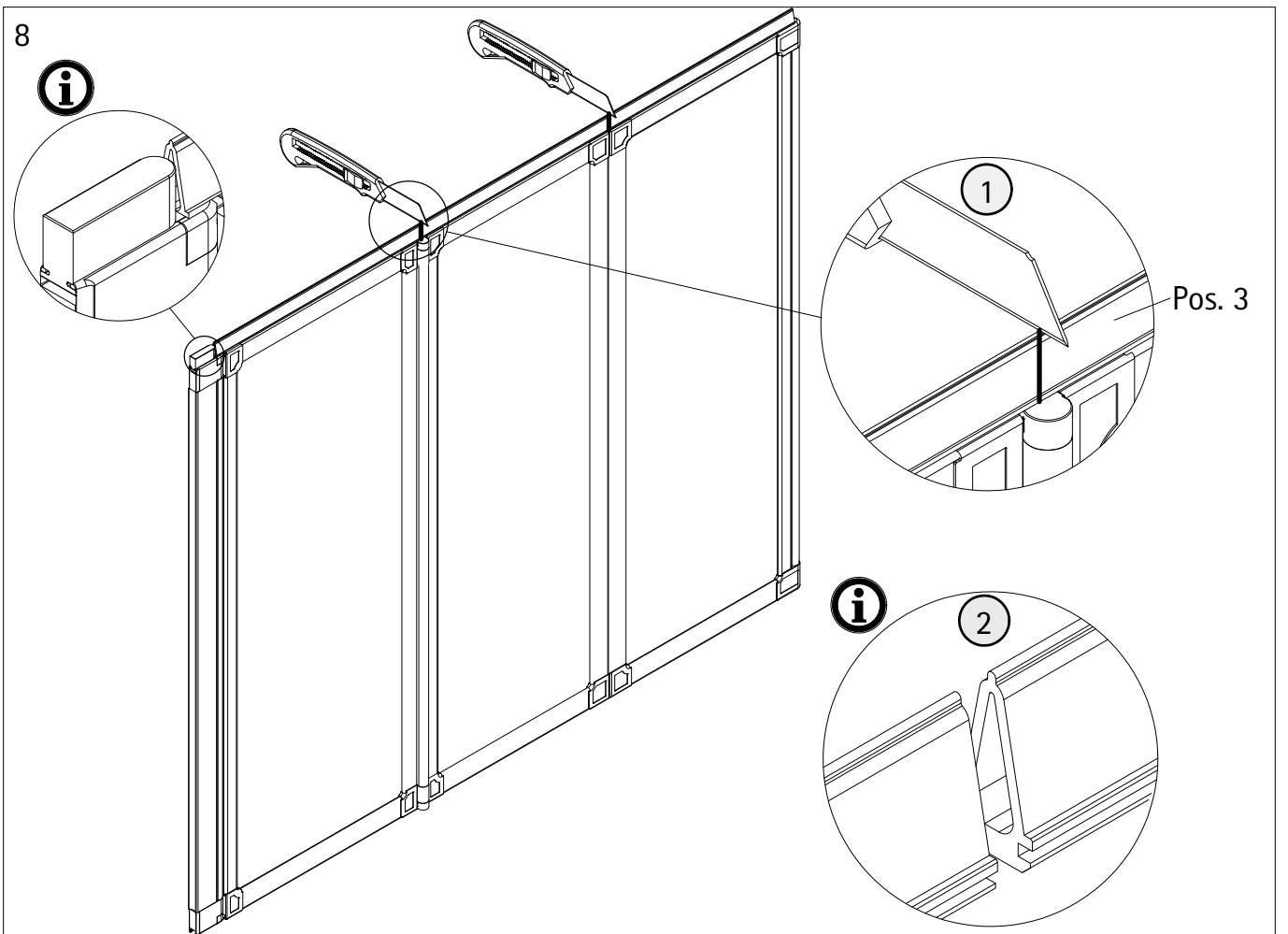
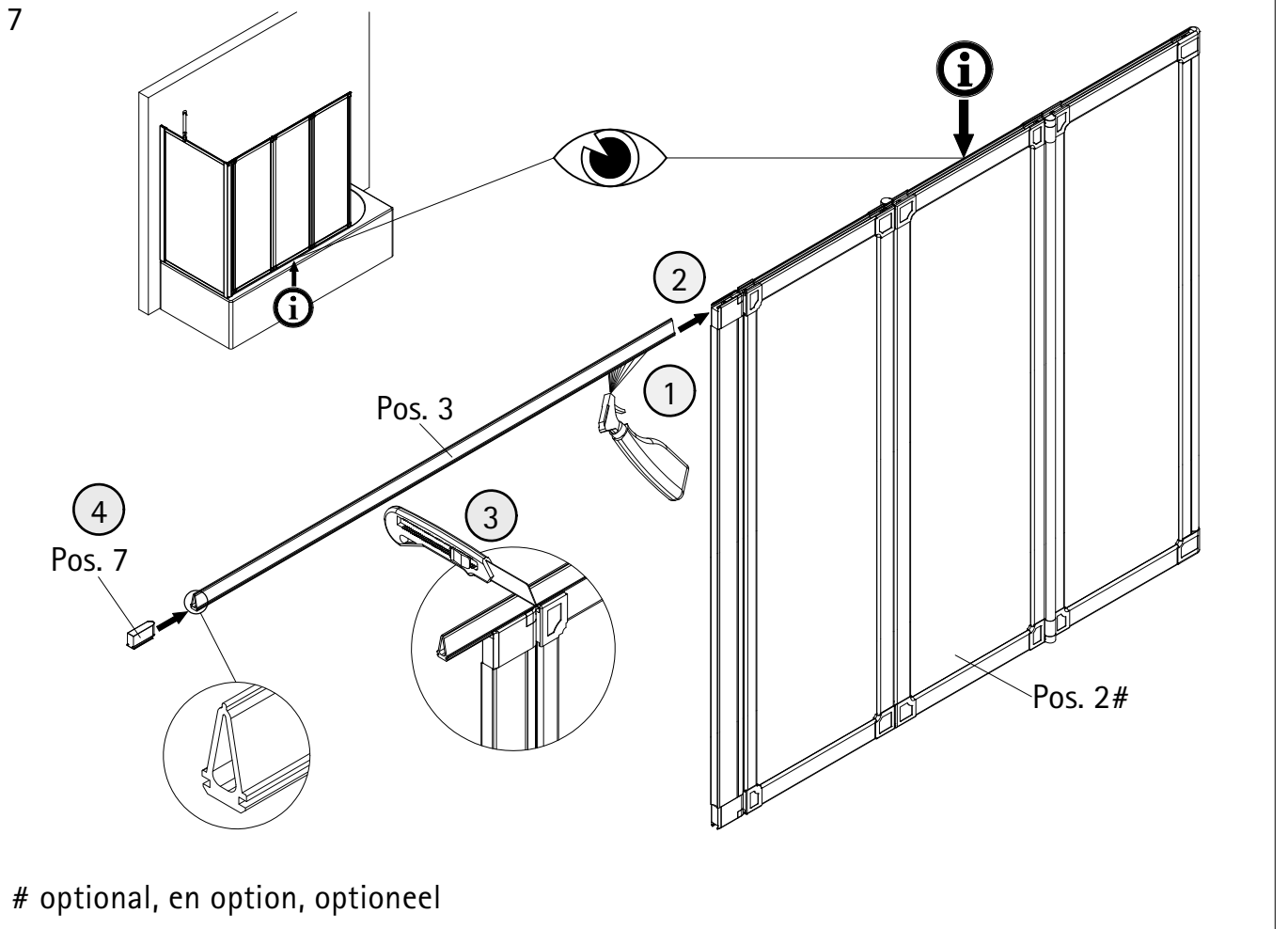

9

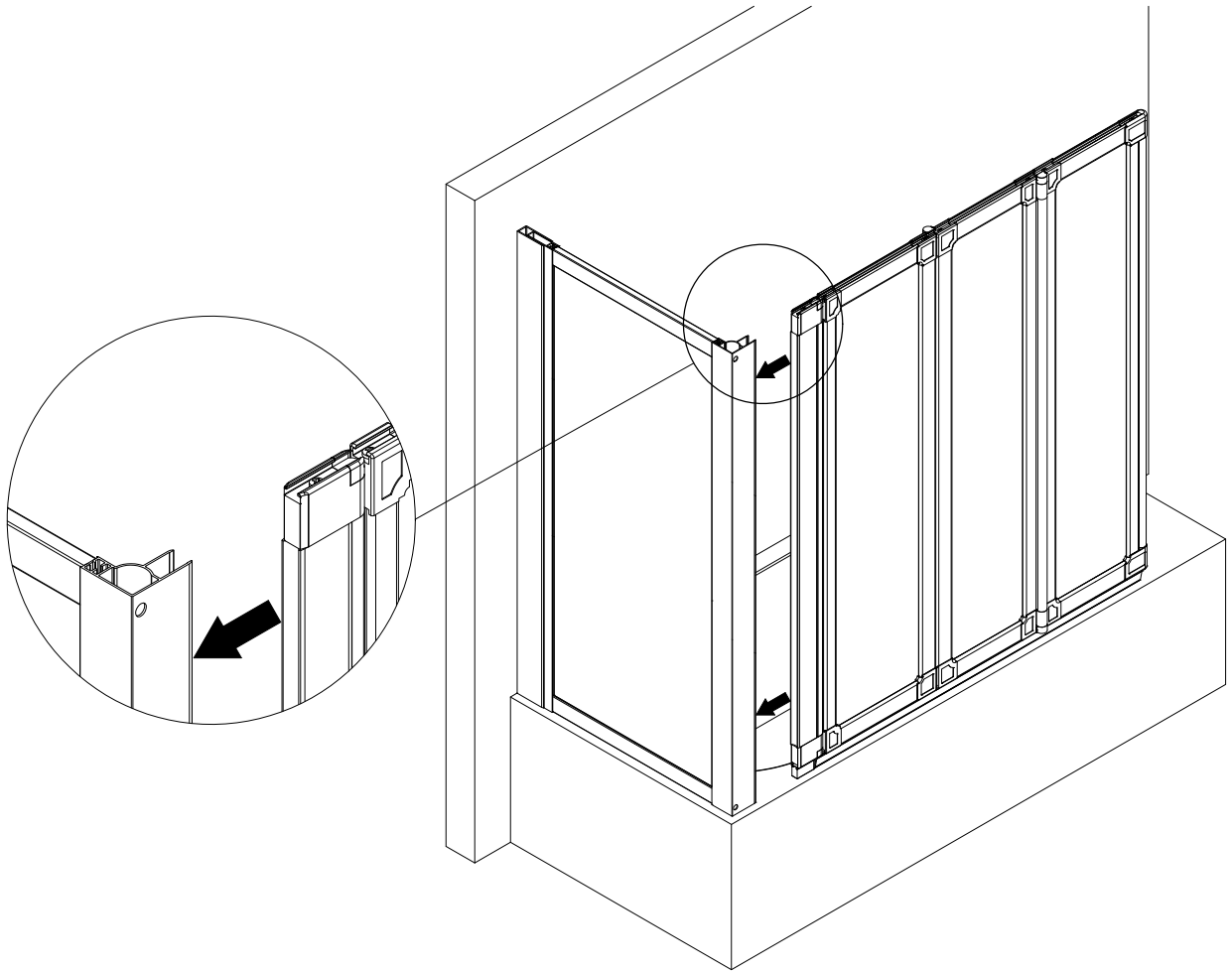

10

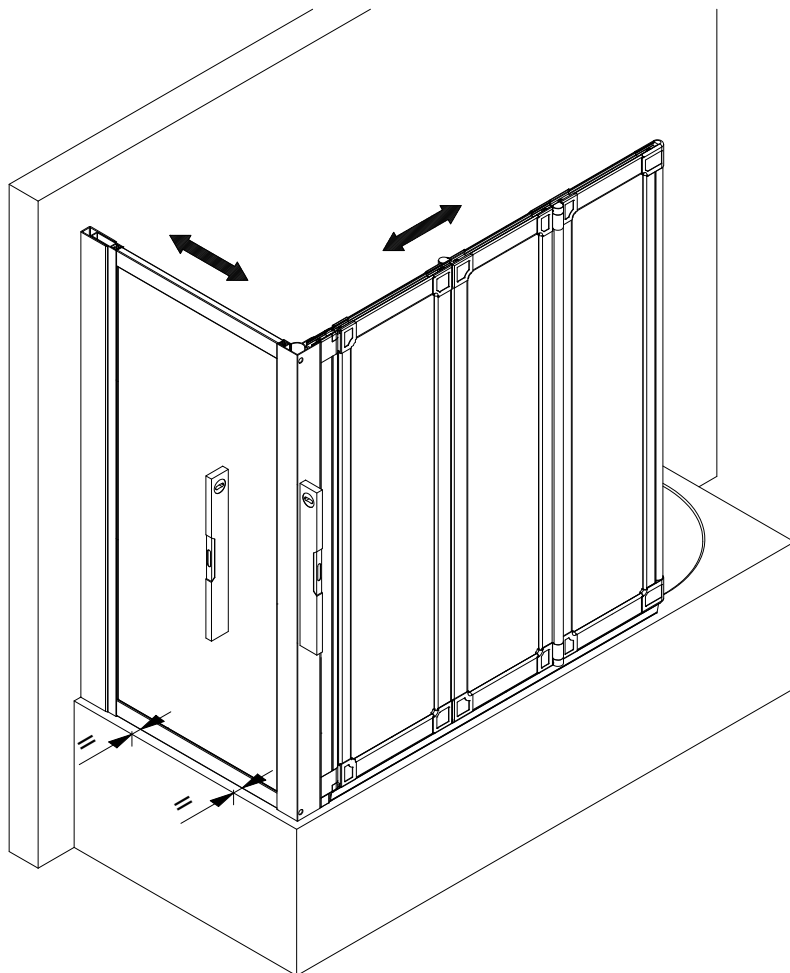

11

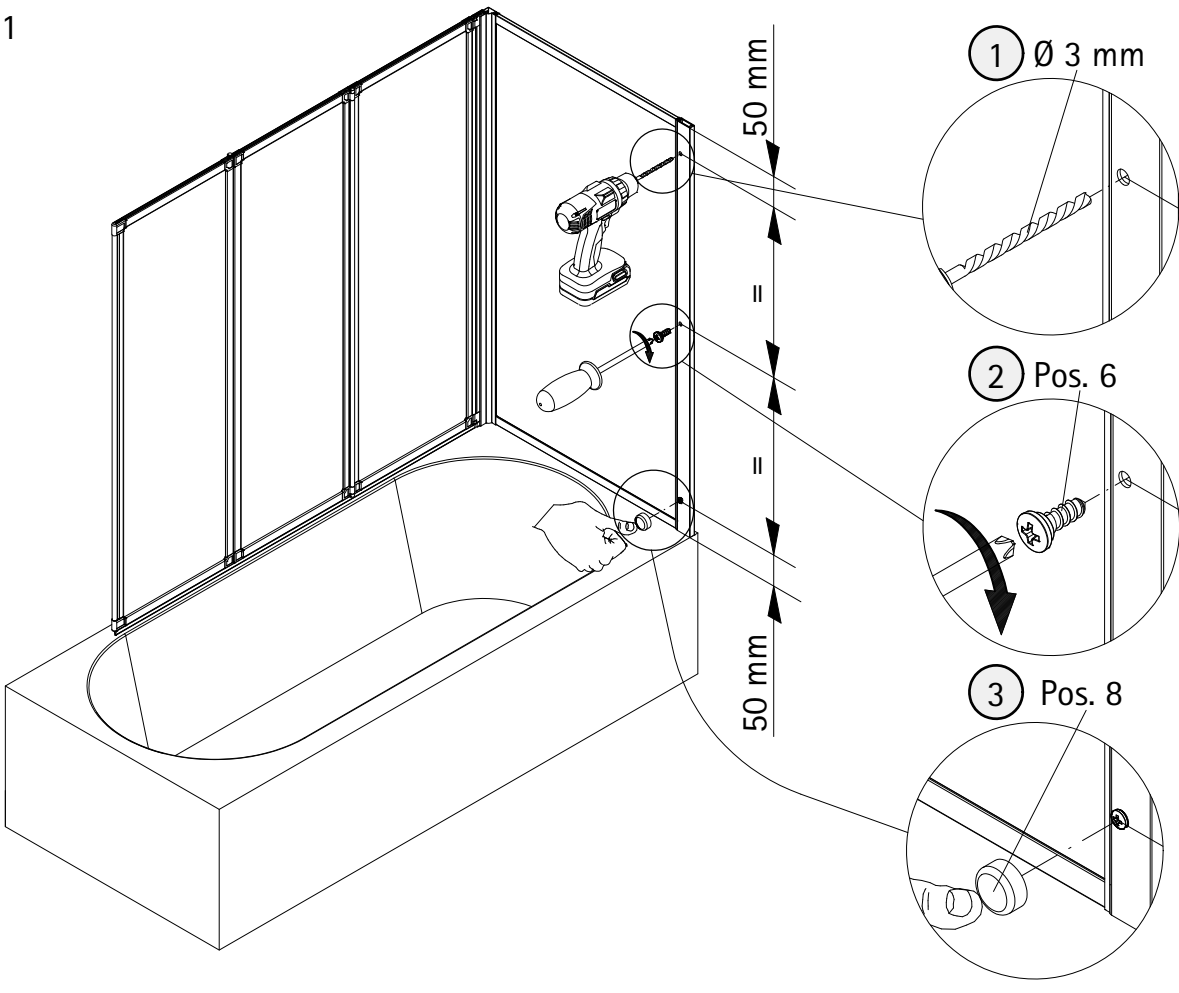

12

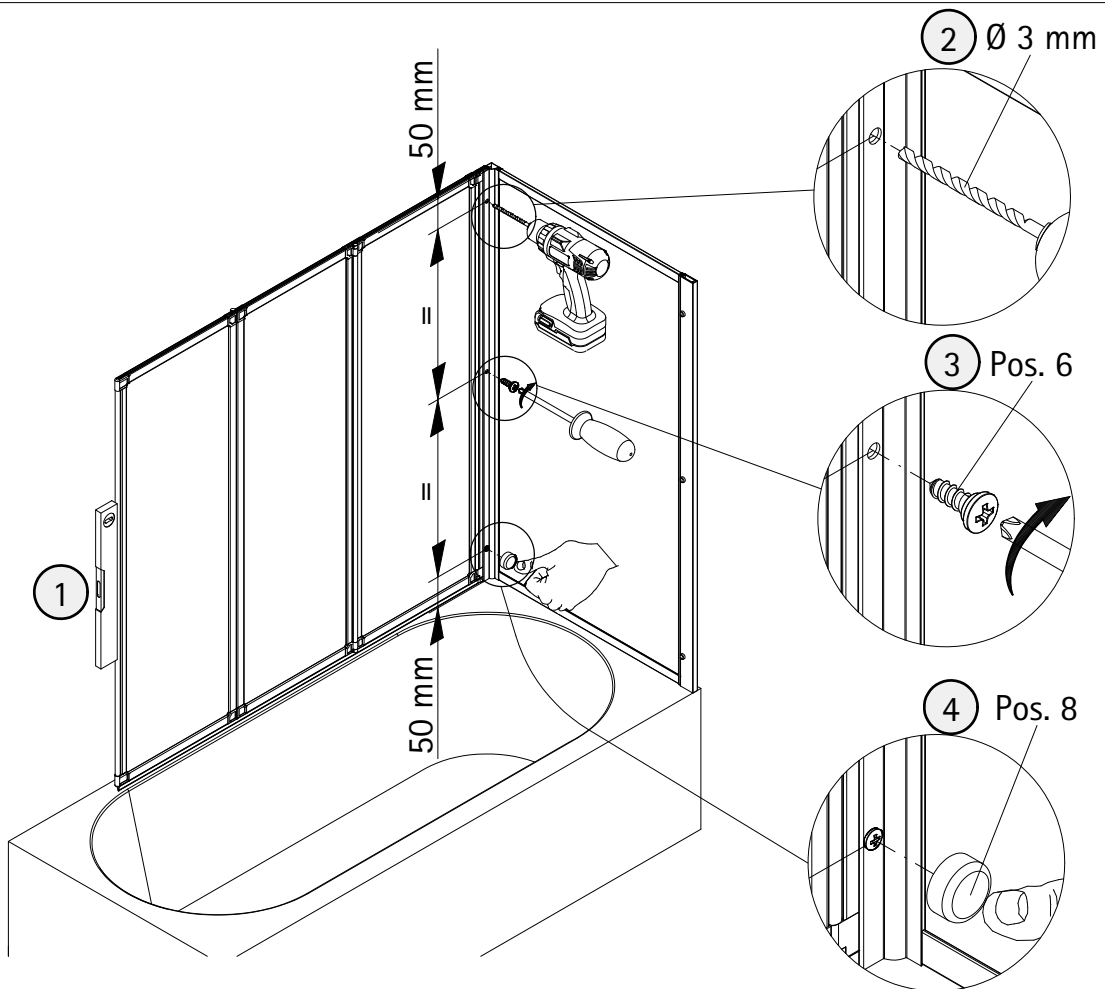

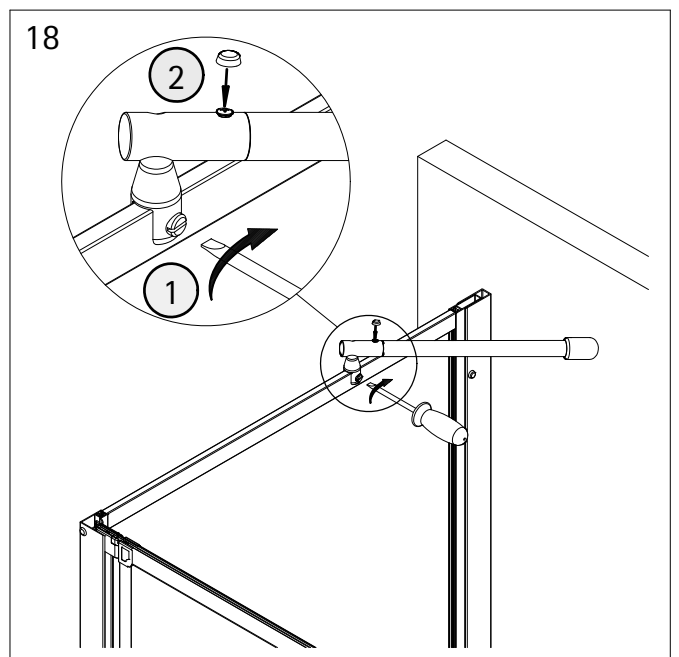
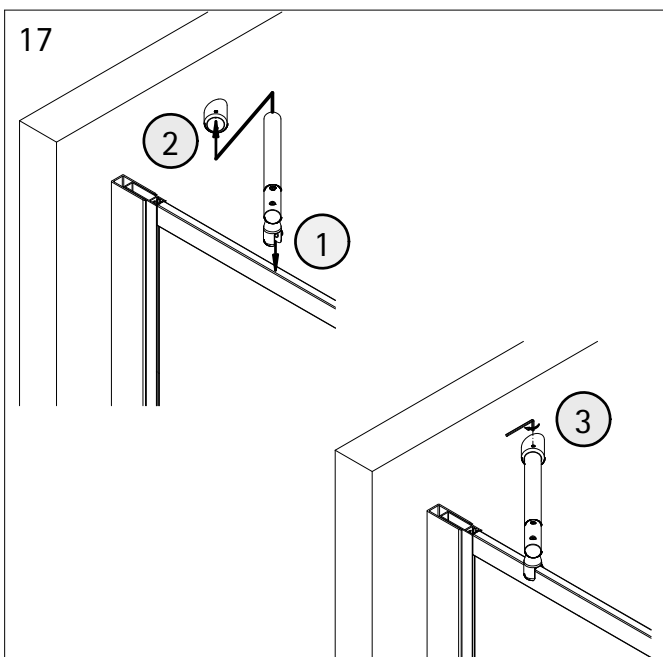
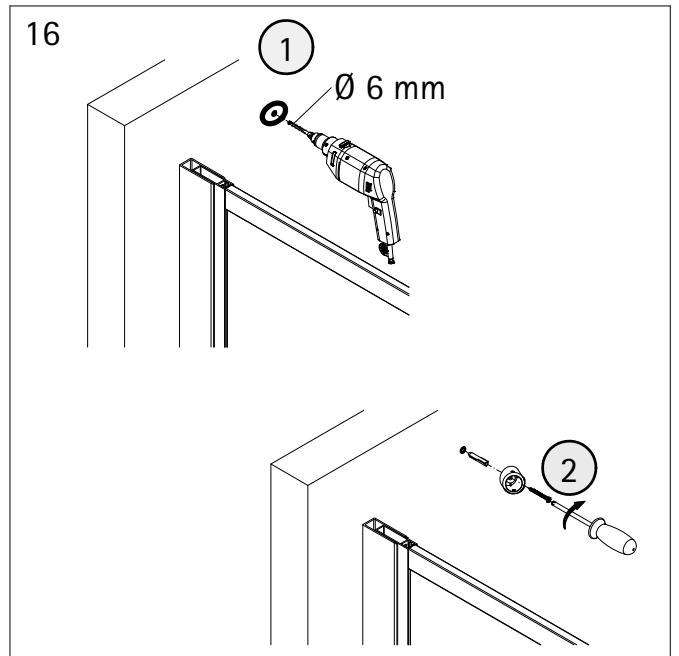
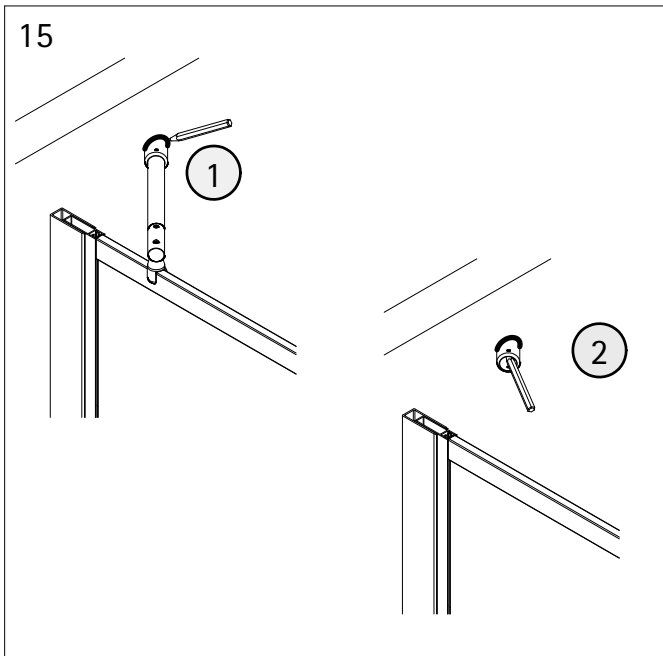
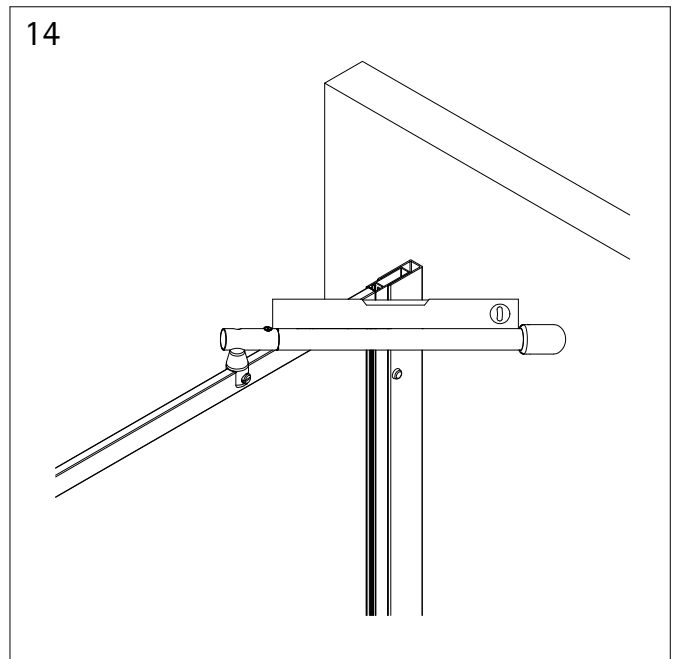
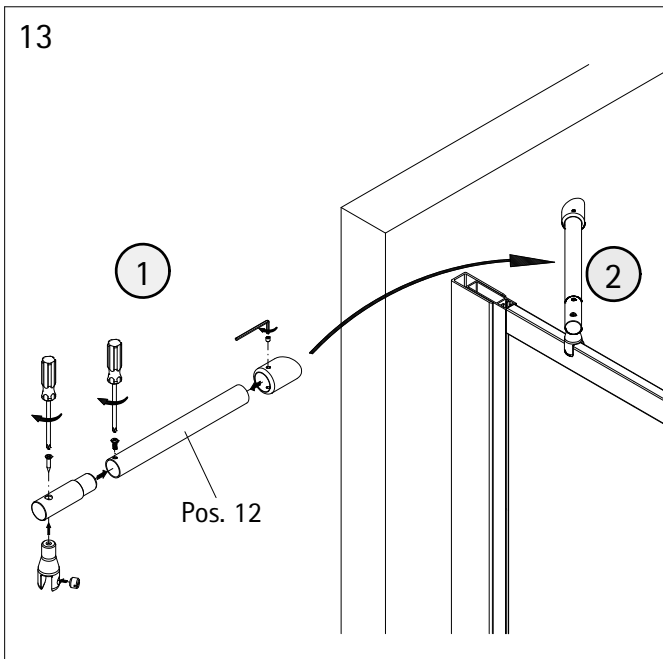

19

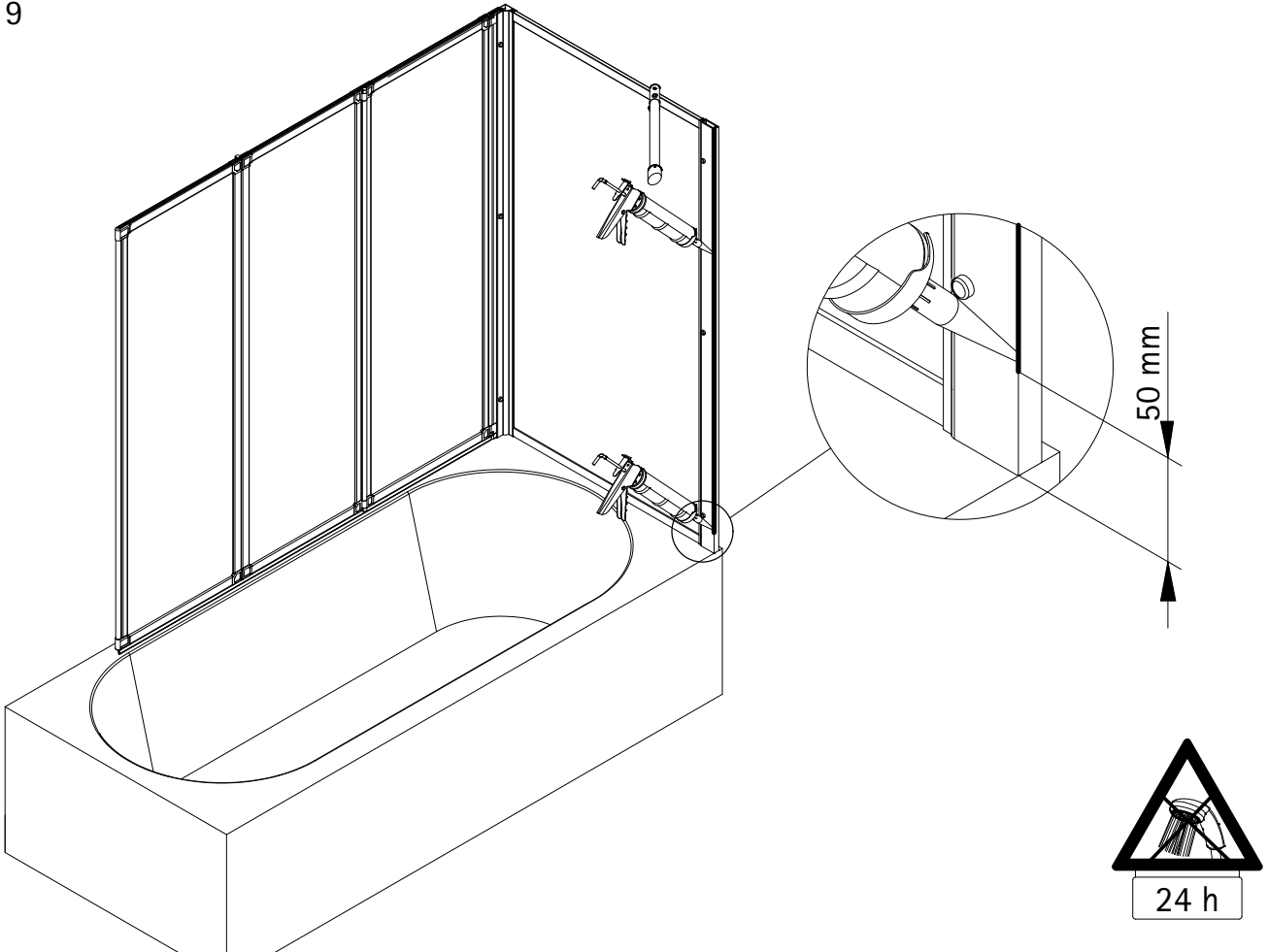

20

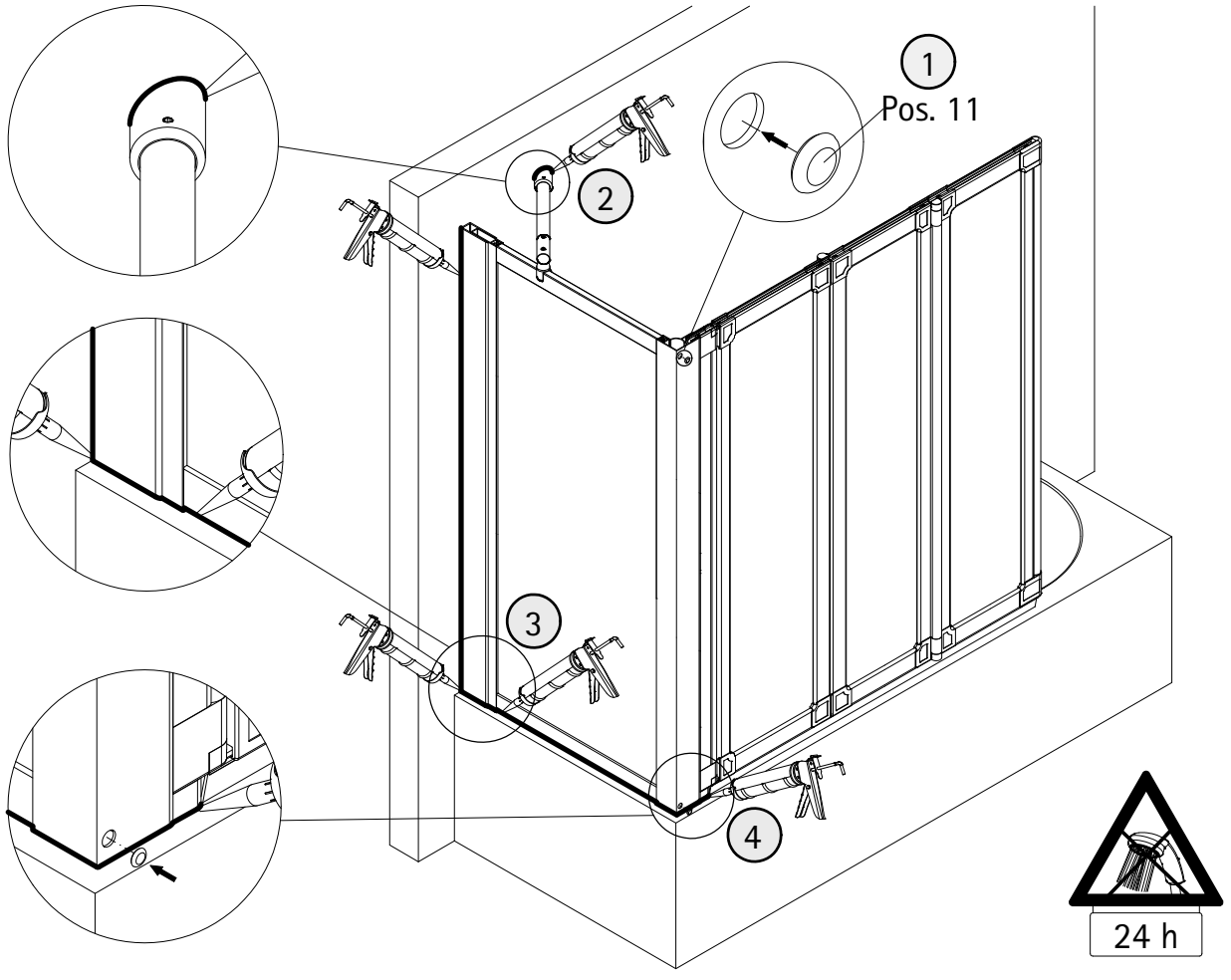

2030-1

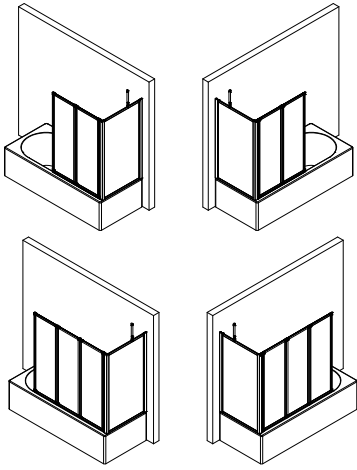

Prüfnummer / Inspection number / Numéro de contrôle / Testnummer



Ersatzteilbestellung / spare parts order
commande de pièces détachées / Bestelling van onderdelen:
Fax 02962 / 972-4260



Technische Hilfe / technical help / l'aide technique / technologische ondersteuning
Telefon 02962 / 972-40



E-Mail:
ersatzteile@duschservice.de



Duschservice
Zum Hohlen Morgen 22
59939 Olsberg
Deutschland / Germany / Allemagne / Duitsland

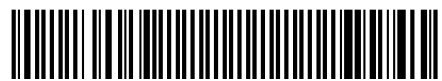

000073595000000000000000000000