

- Montageanleitung
- Assembly instructions
- Notice de montage
- Montagehandleiding
- Návod na montáž
- Instrucțiune de montaj
- Navodila za namestitev
- Installationstruktioener

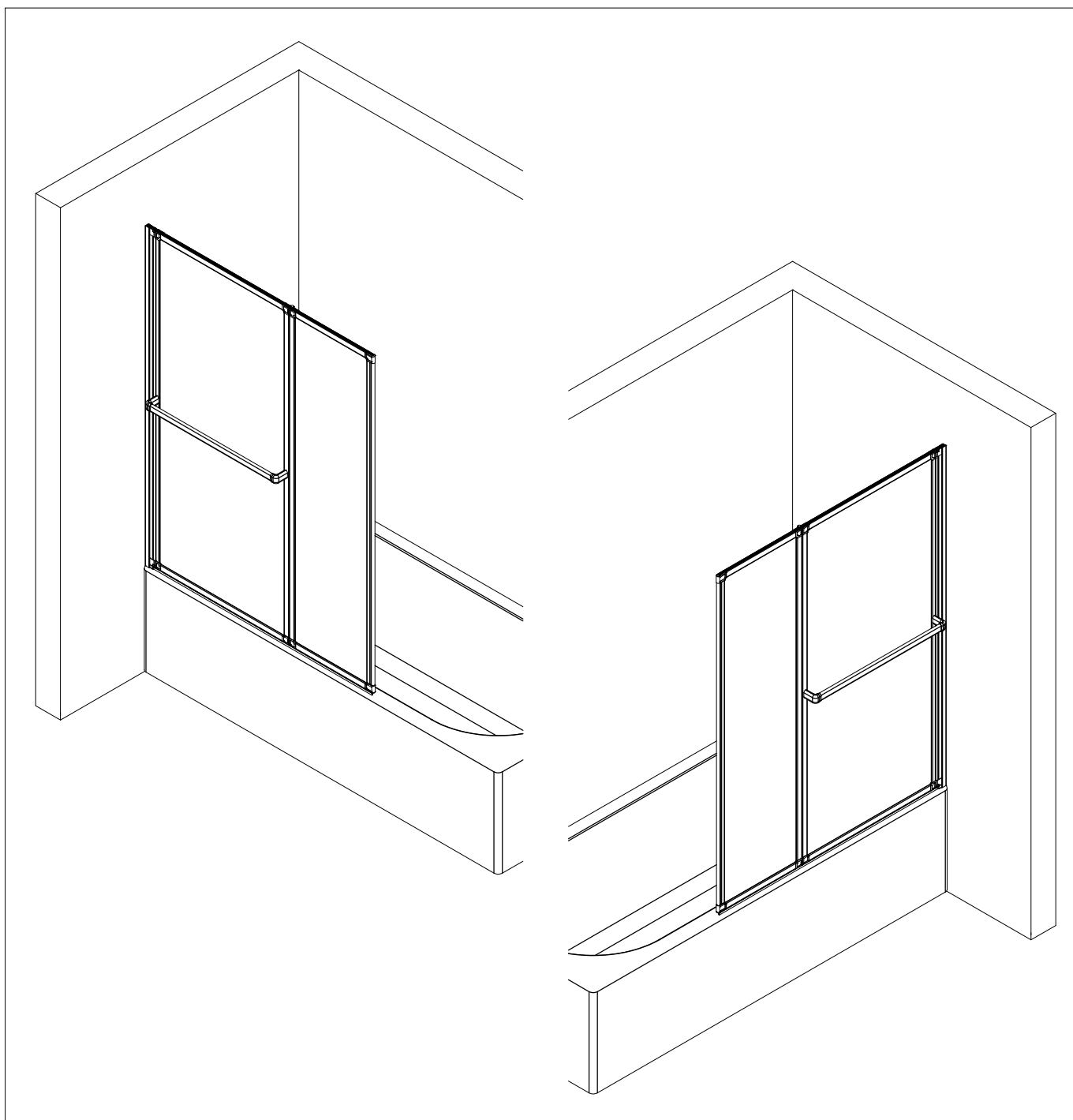

2083-1

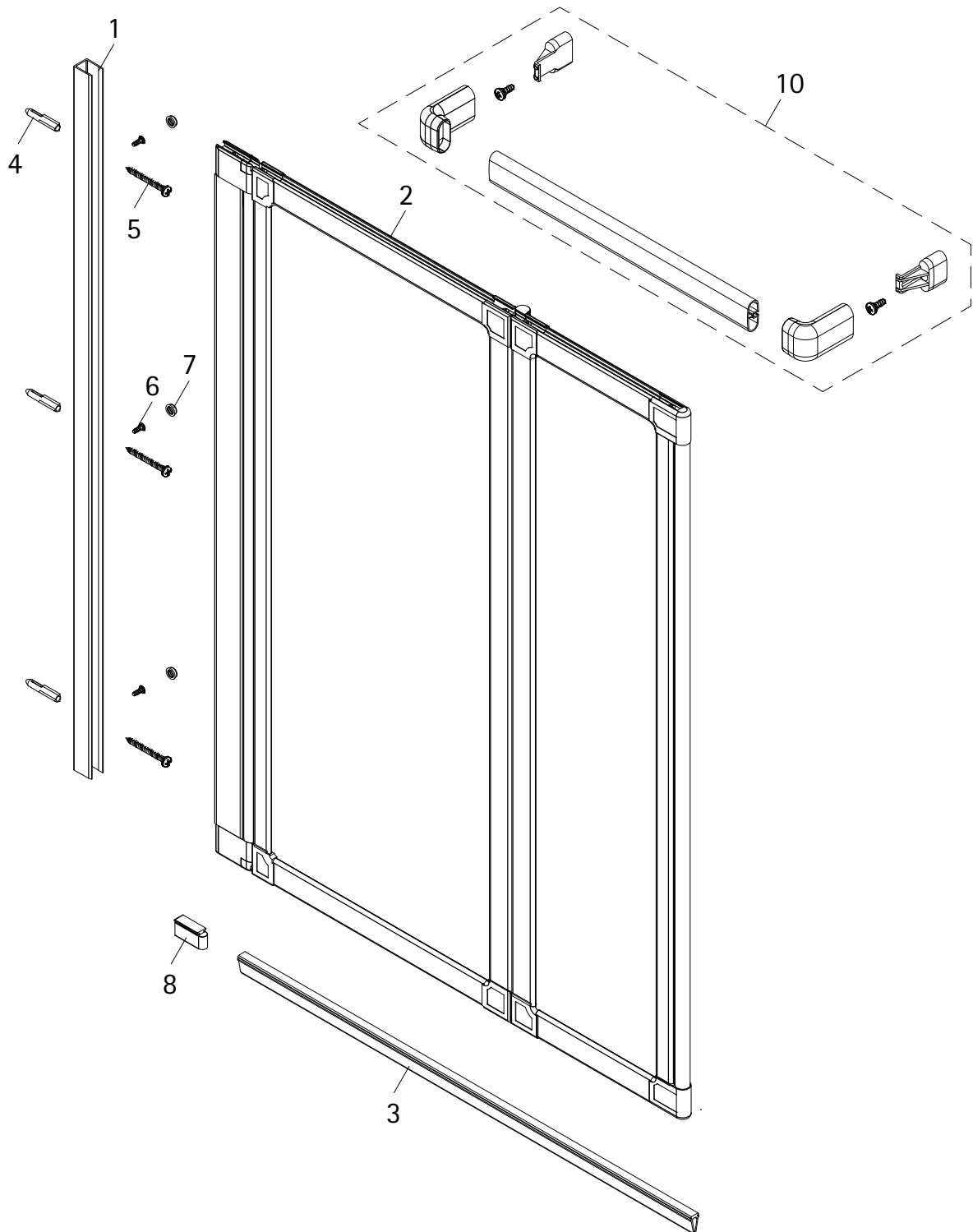

Pos.	Bezeichnung	Ersatzteil-Nr.	Preis
1	1x Wandanschlussprofil	E60230-3	Stück 86,95 €
2	1x Türelement 2 teilig, komplett		
3	1x Türdichtprofil	E100076-4	Stück 23,95 €
4*	3x Dübel		
5*	3x Schraube 4,2 x 45 mm		
6*	3x Schraube 3,5 x 9,5 mm		
7*	3x Abdeckkappe		
8*	1x Stützklötz		
10	1x Handtuchhalter komplett	E60170-5	Stück 44,95 €
	*Schrauben- und Abdeckkappenset	E60200-2	16,95 €

i

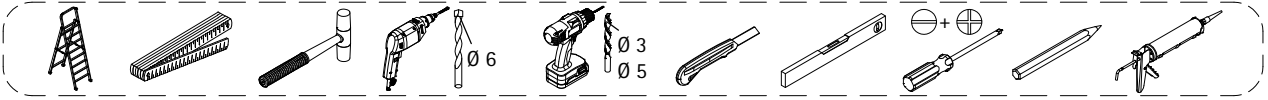
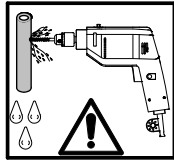
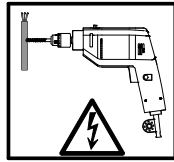
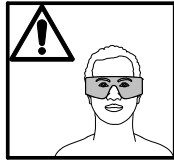
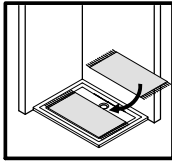
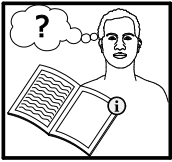

1

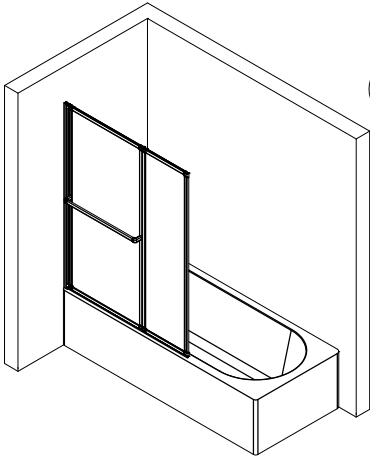

i

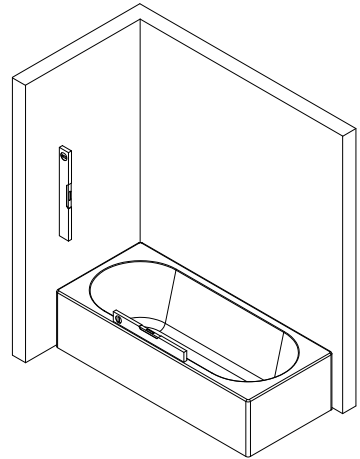
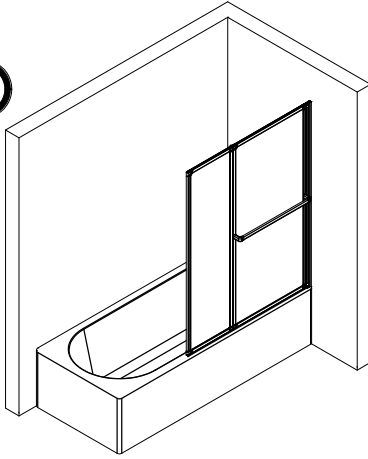

2

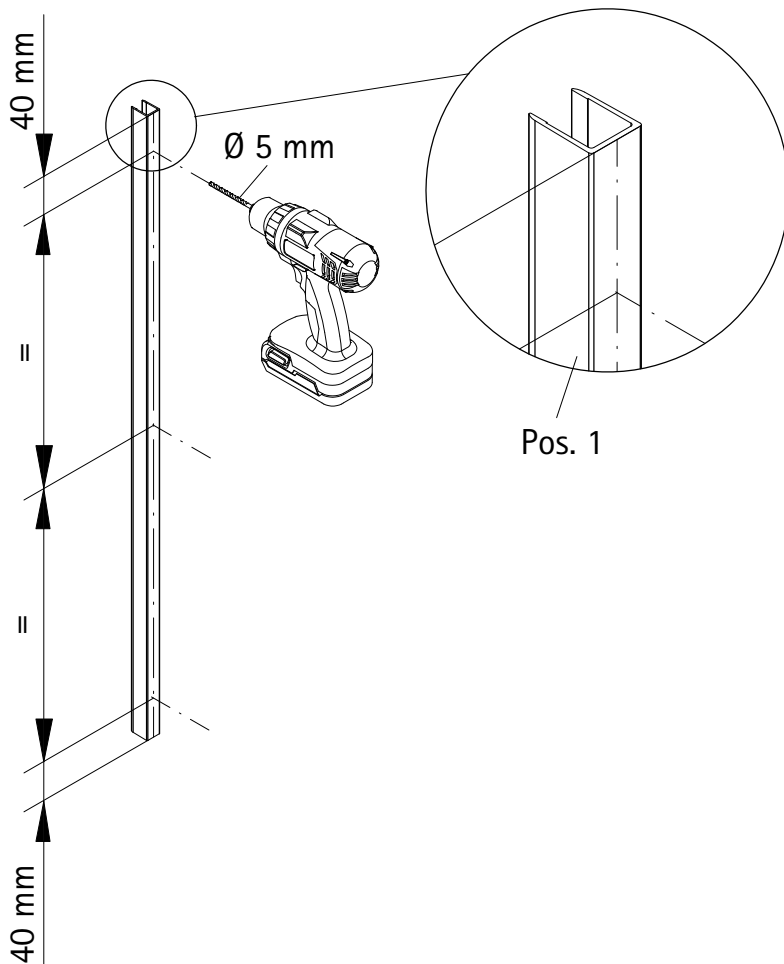

3

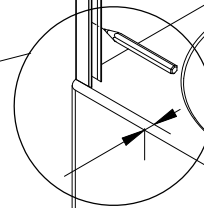
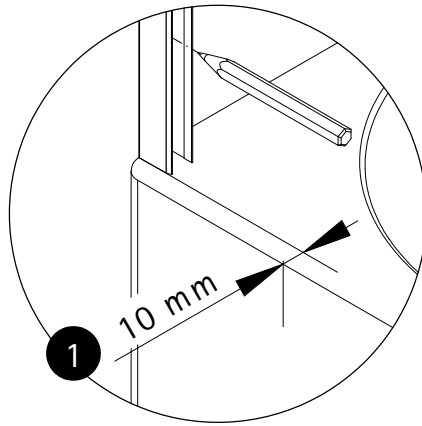
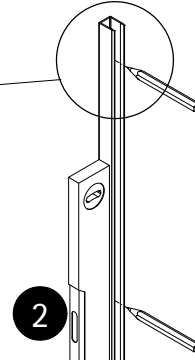
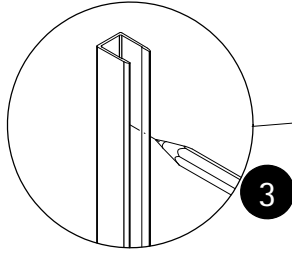
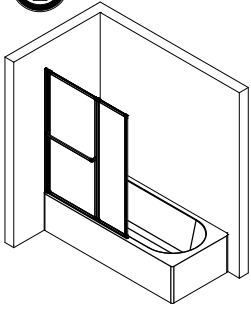

4

1
Ø 6 mm

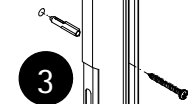
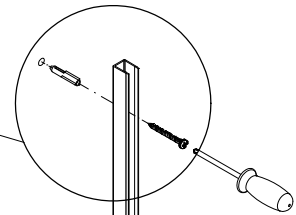
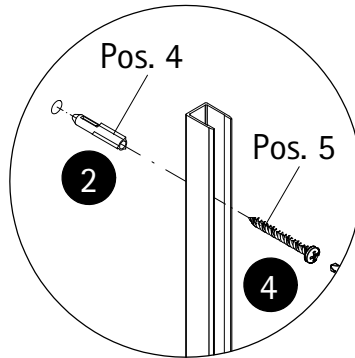
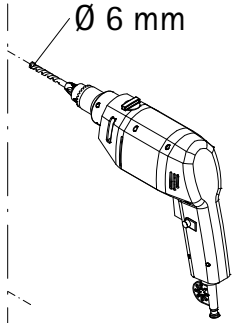

5

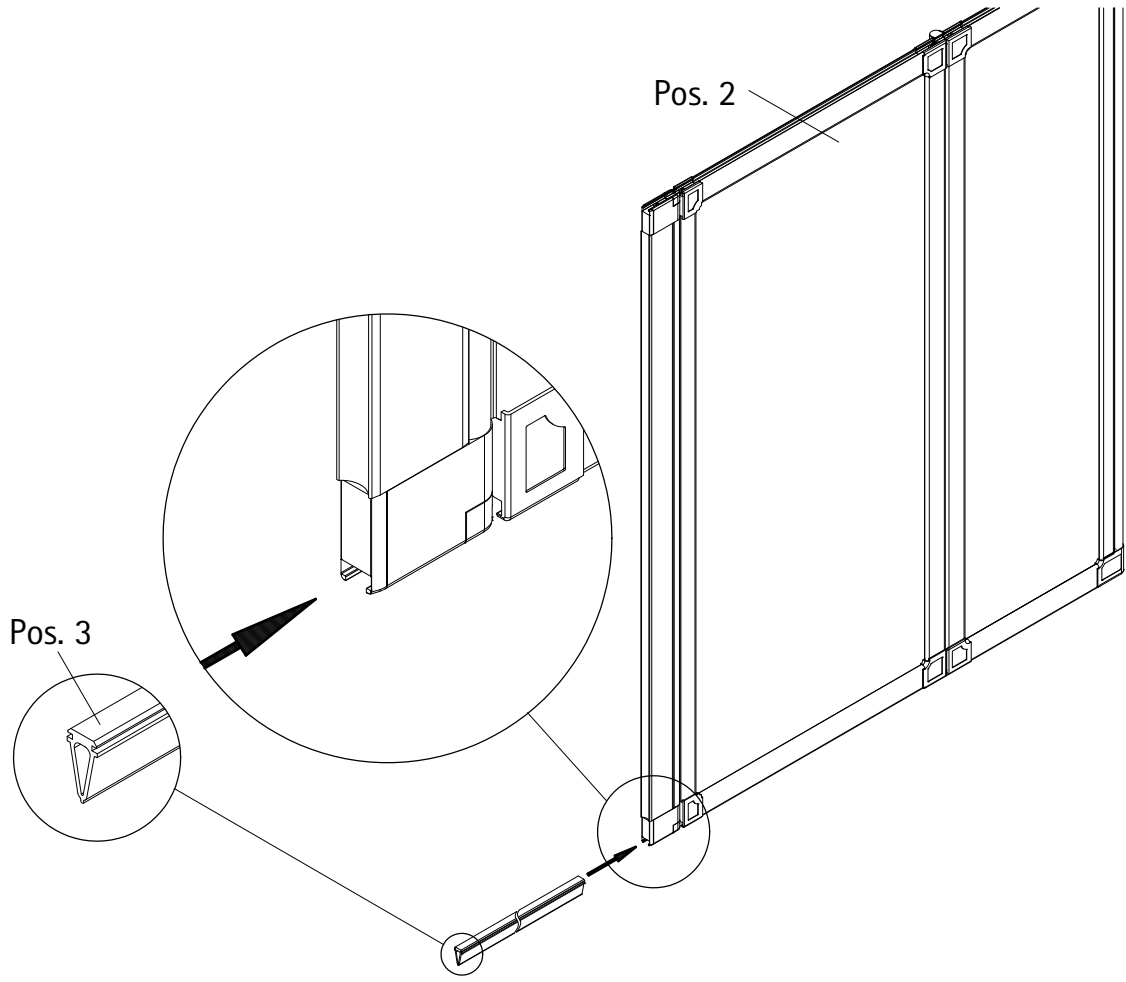

6

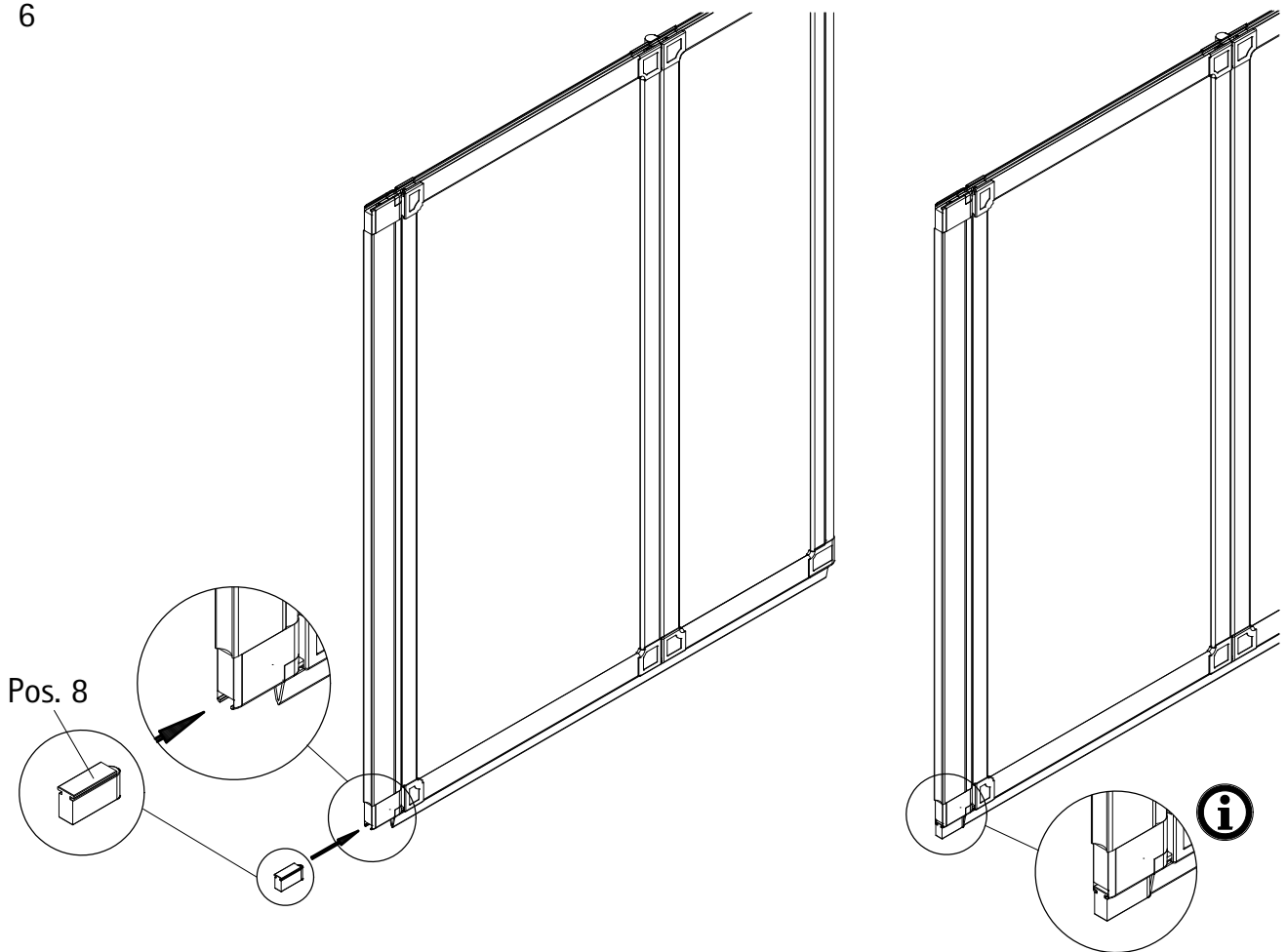

7

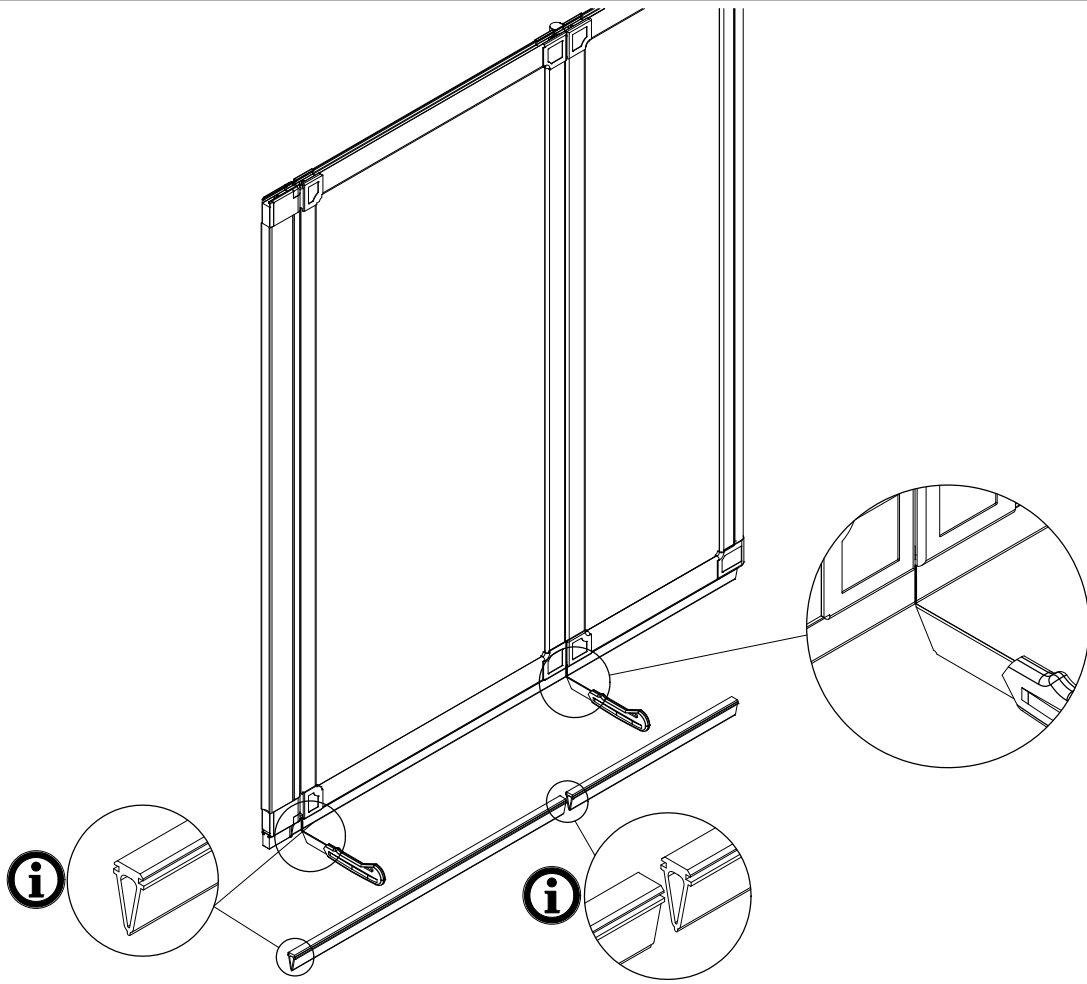

8

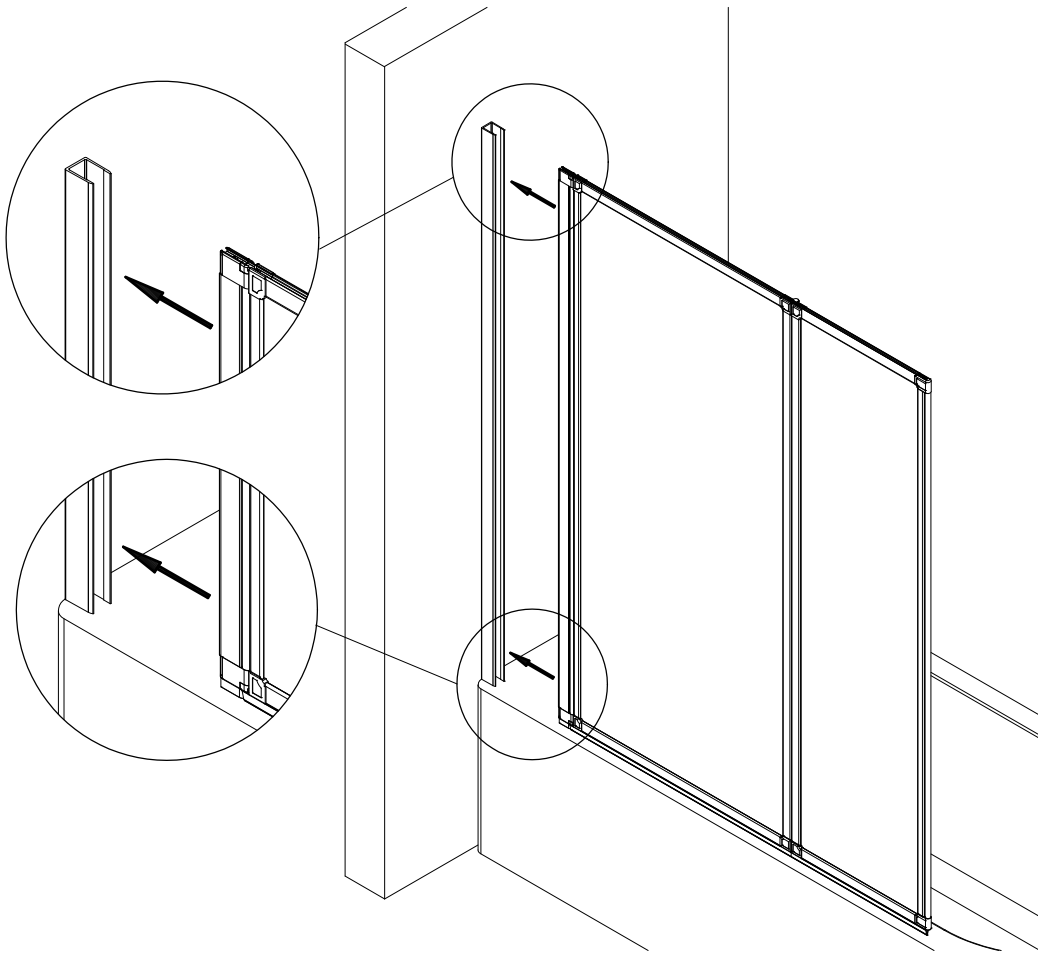

9

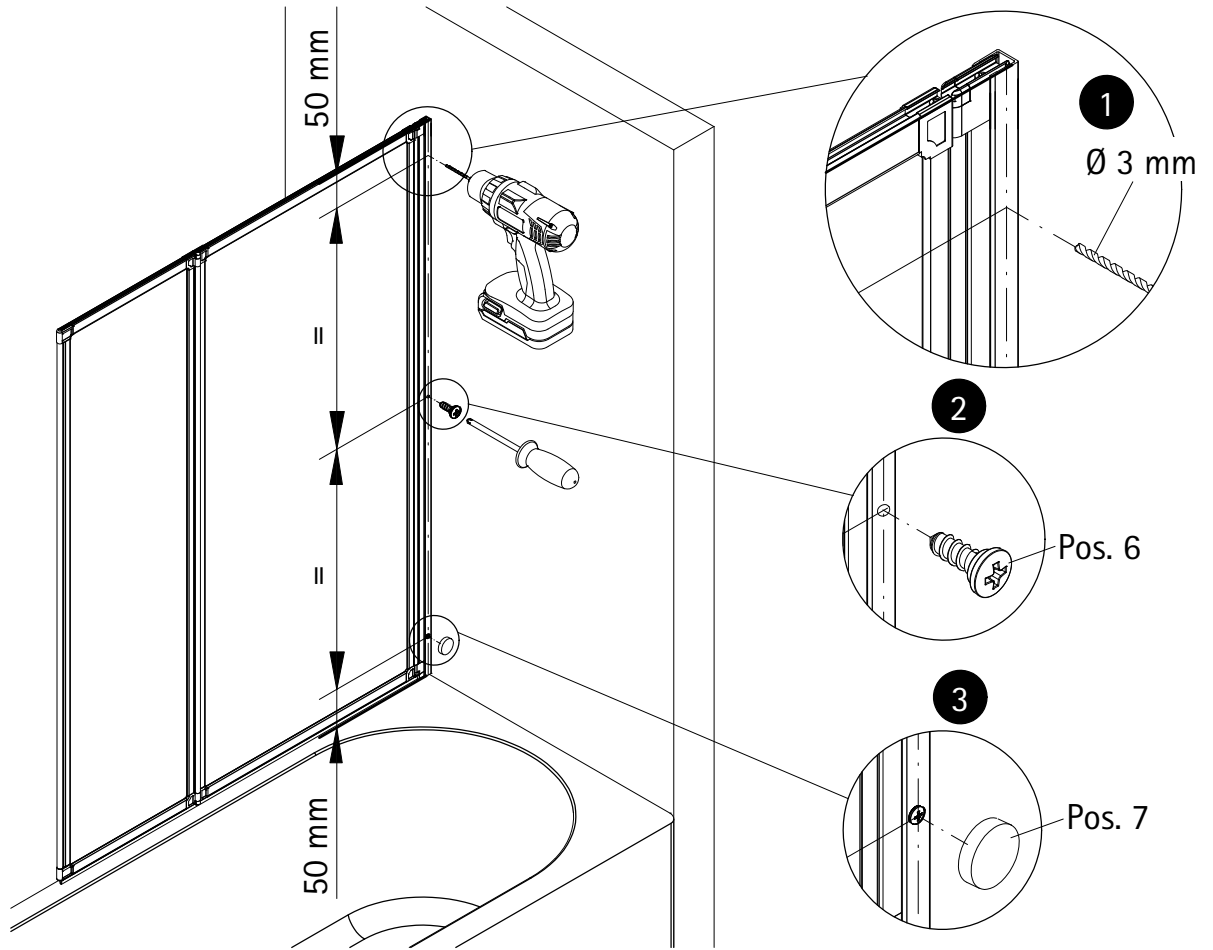

10

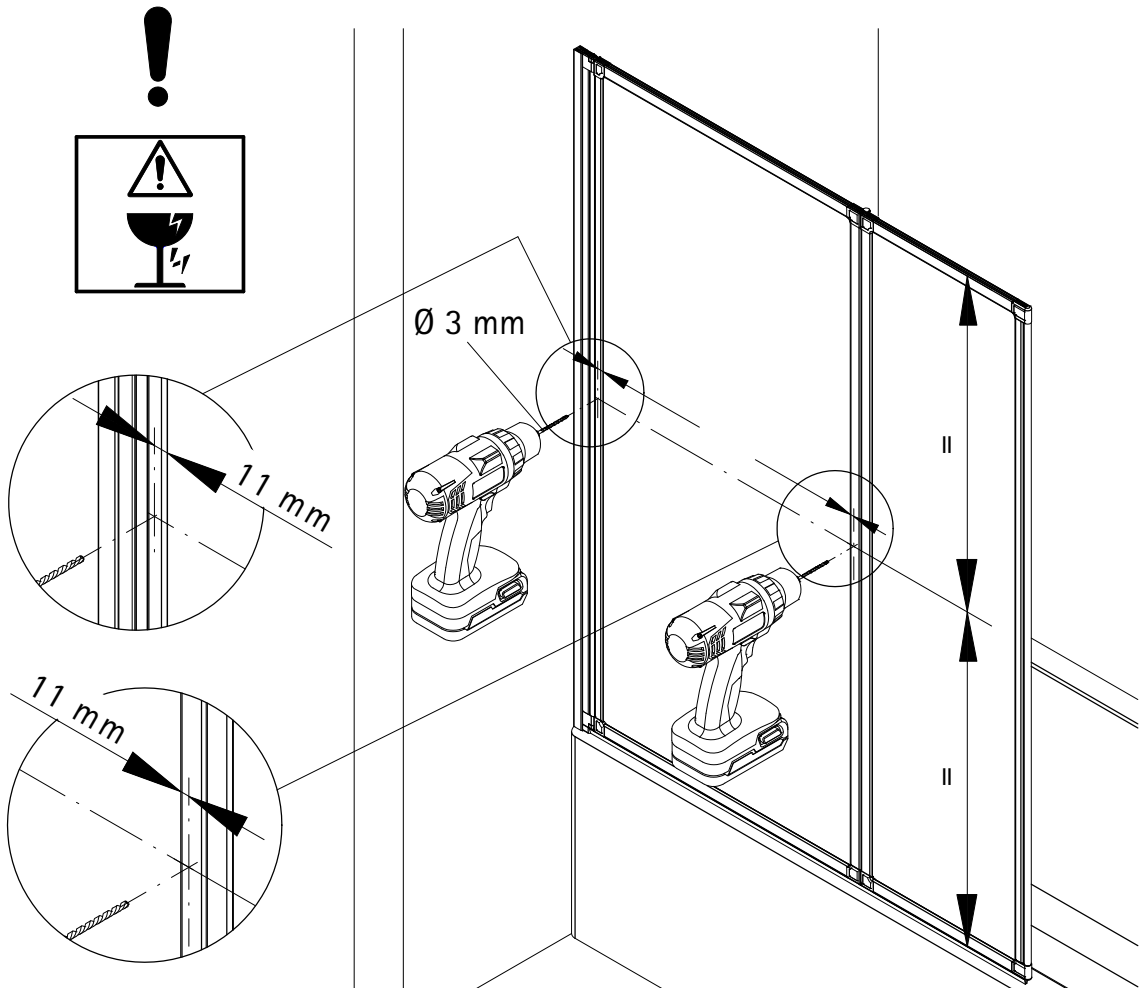

11

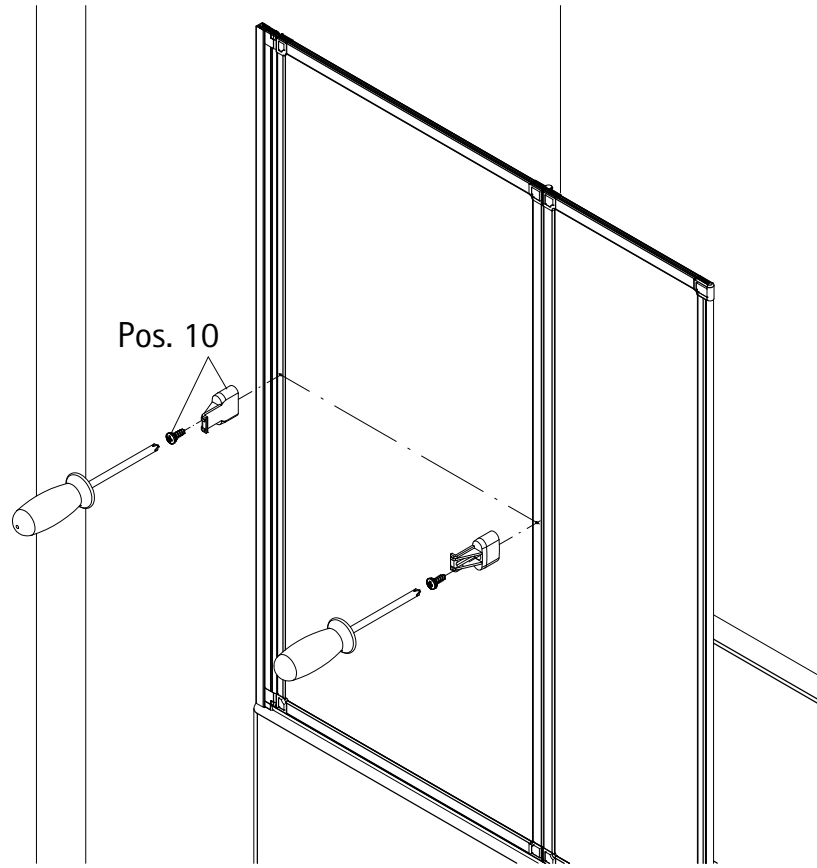

12

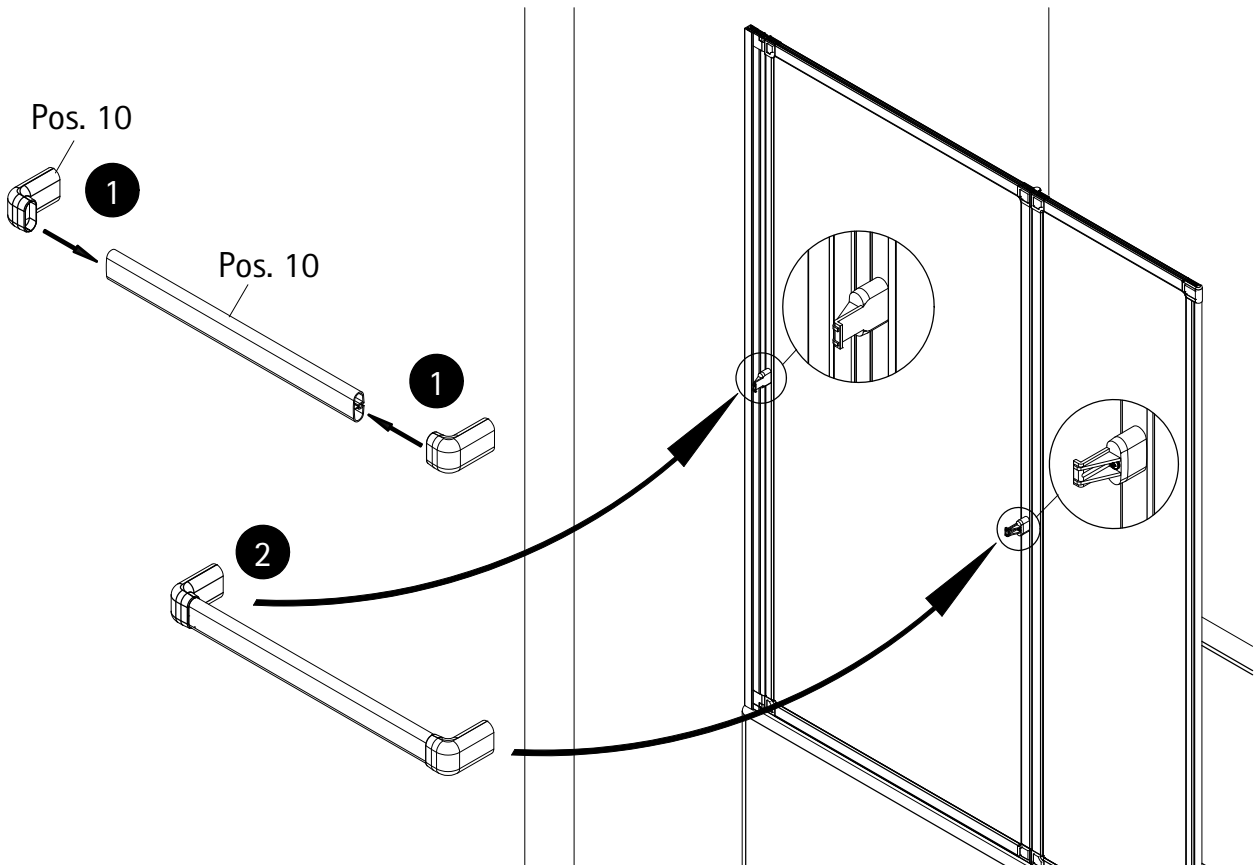

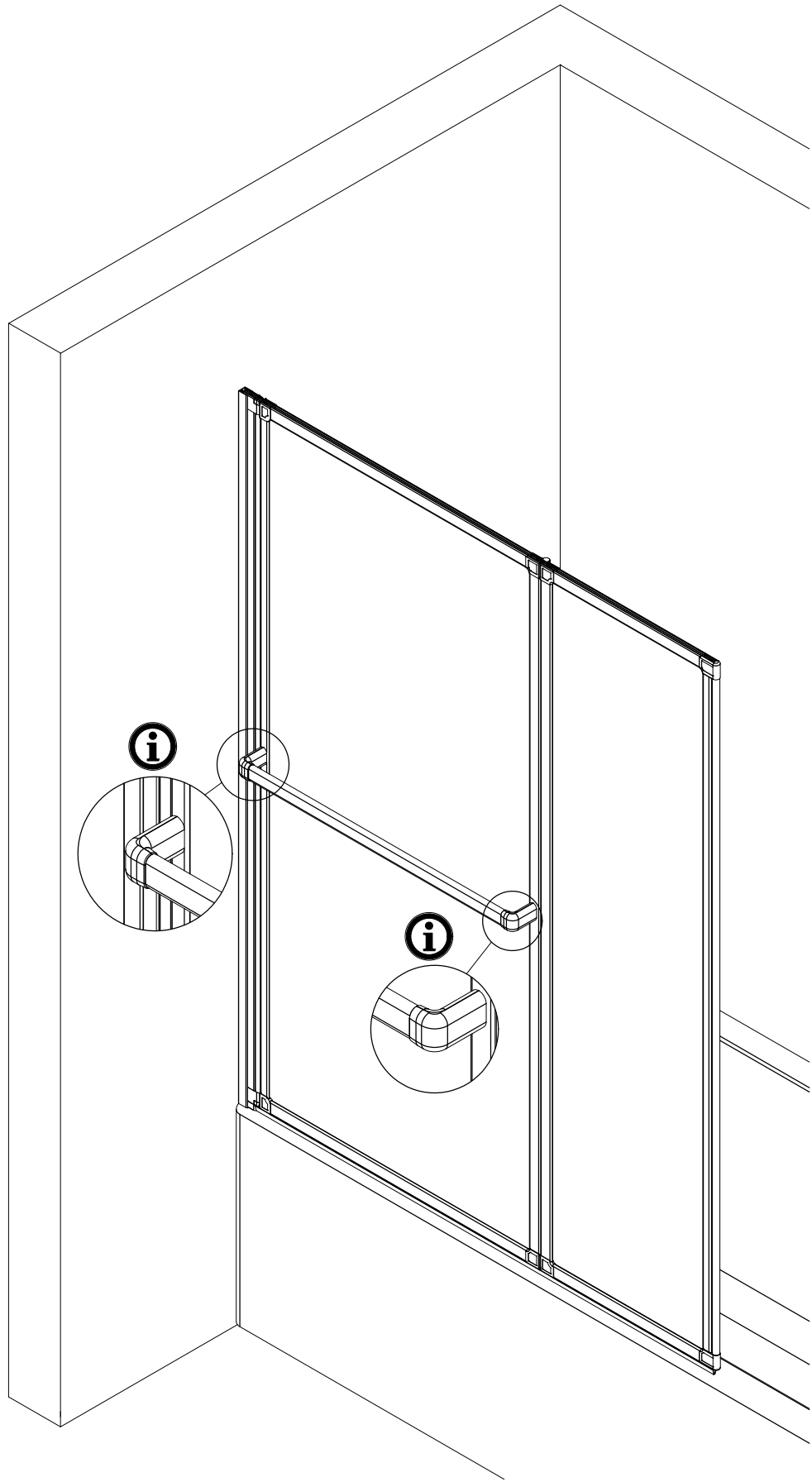

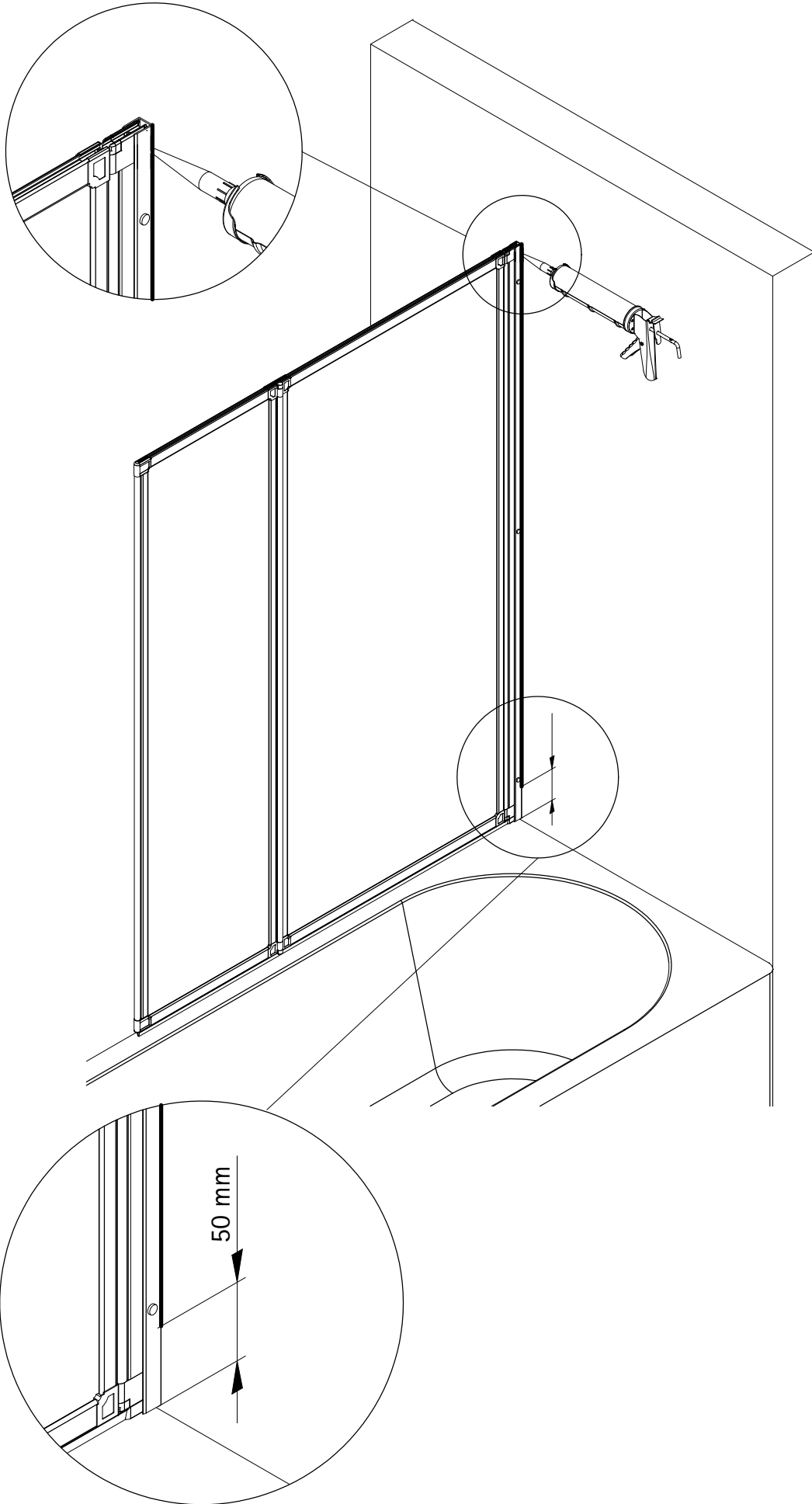

15

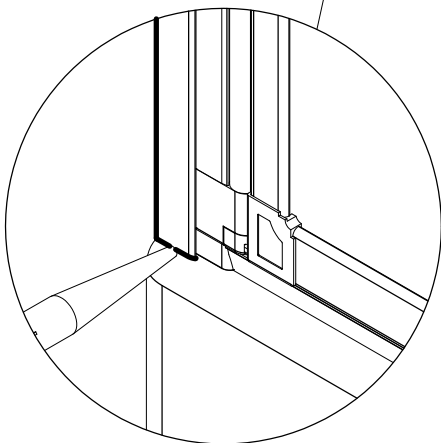
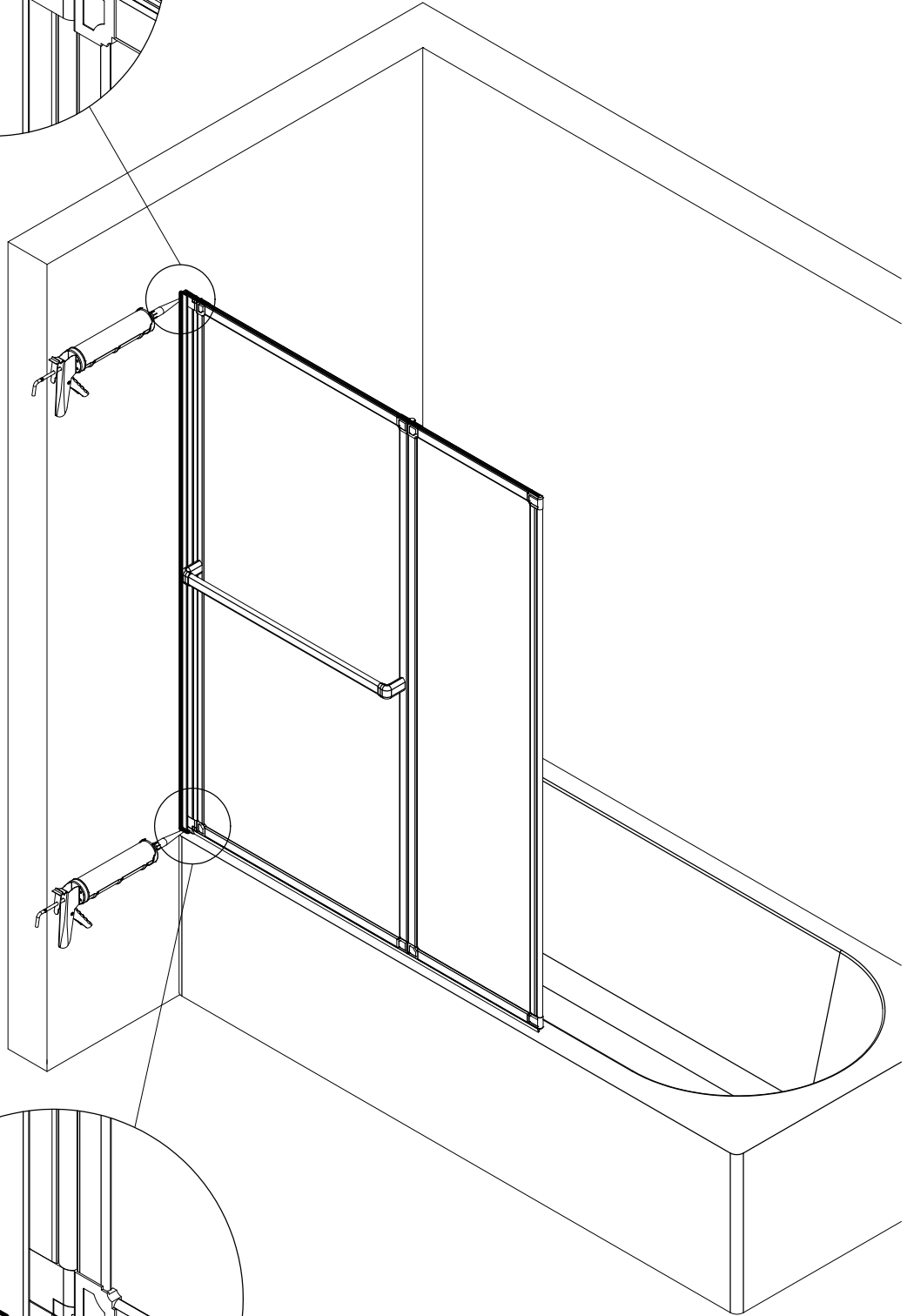
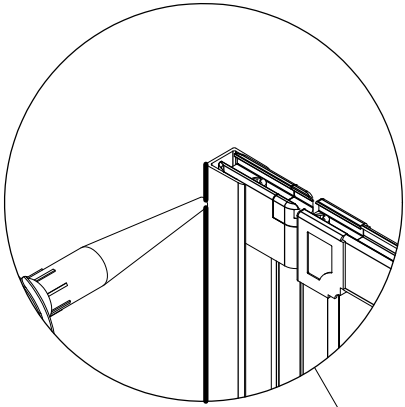

2083-1

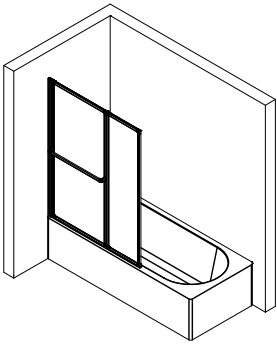

Prüfnummer / Inspection number / Numéro d'essai / Testnummer



Ersatzteilbestellung / spare parts order
commande de pièces de rechange / Bestelling van reserveonderdelen:
Fax 02962 / 972-4260



Technische Hilfe / technical help / l'aide technique / technologische ondersteuning
Telefon 02962 / 972-40



E-Mail:
ersatzteile@duschservice.de



Duschservice
Zum Hohlen Morgen 22
59939 Olsberg
Deutschland / Germany / Allemagne / Duitsland



0000773680000000000000000000

Montageanleitung Badewannenfaltwand "Einfach ohne Bohren"

Assembly instructions for bath screen "Easy installation without drilling"

Instructions de montage pare-baignoire "montage facile sans percer"

Montagevoorschrift badvouwwand "Simpele montage zonder boren"



- Beipackzettel unbedingt beachten.
- Note: Read enclosed instruction leaflet carefully.
- Veuillez impérativement faire attention à la notice explicative.
- Let op: lees de bijsluiter.

für Profilvarianten:
for profile versions:
pour les profilés:
voor profiel uitvoeringen:

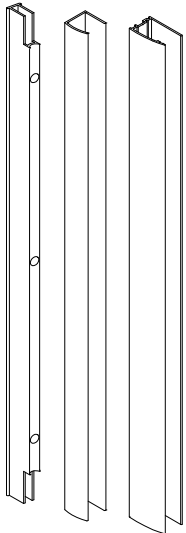

1

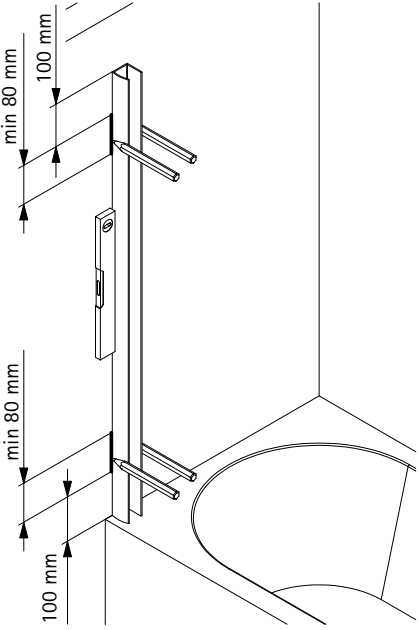

- Wandanschlußprofil muß unten aufstehen!
- Bottom of wall profile has to stand on the bathtub
- Le profilé mural doit se reposer en bas (reposer sur la baignoire)
- Wandprofiel moet aan onderzijde vast staan (op de badkuip rusten)

2

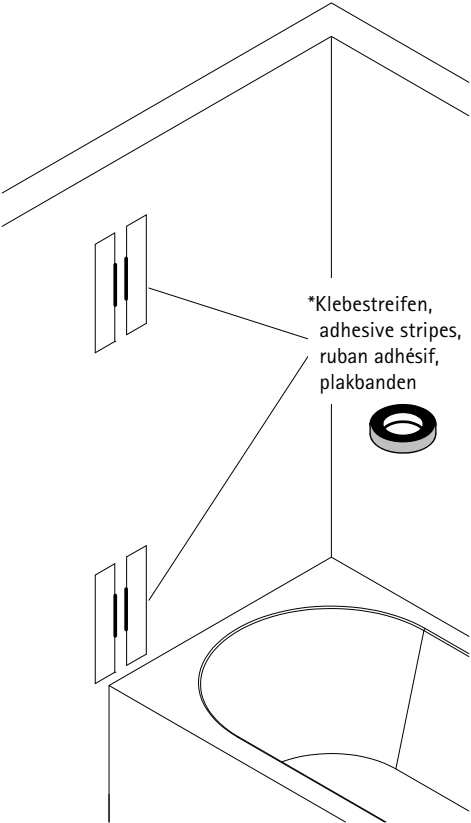

*Klebestreifen,
adhesive stripes,
ruban adhésif,
plakbanden

* Nicht im Lieferumfang enthalten,
not included in delivery,
non fourni dans l'emballage,
niet bij levering inbegrepen,

3

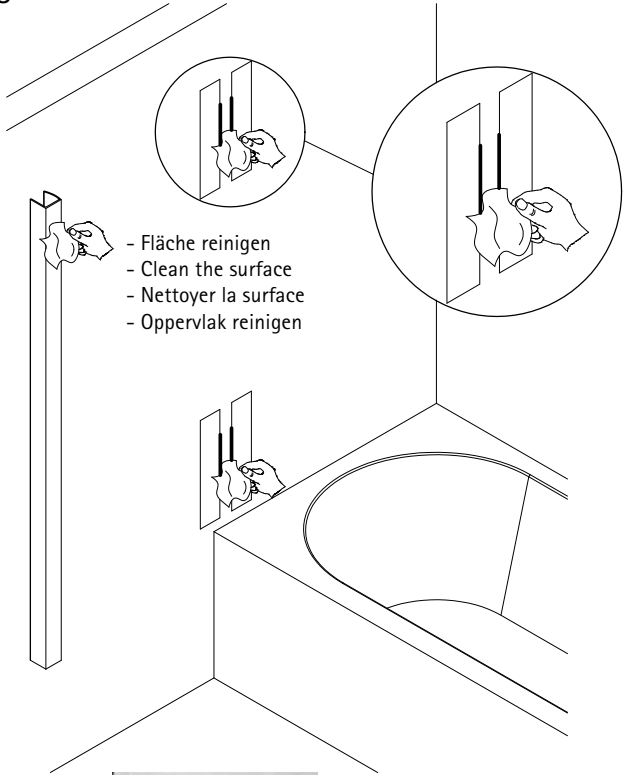

- Fläche reinigen
- Clean the surface
- Nettoyer la surface
- Oppervlak reinigen



4

- Kleber nach Anleitung anrühren und auf die gekennzeichneten Flächen des Wandanschlußprofils auftragen.
- Mix glue according to the instructions and apply the mixture on the marked areas.
- Appliquez la colle mélangée selon les instructions sur la surface marquée du profilé.
- Lijm volgens voorschrift omroeren en op de gemarke oppervlaktes van het wandaansluitprofiel aanbrengen.

*Anrührunterlage
stirring support
support pour mélanger
aanroer-ondergrond

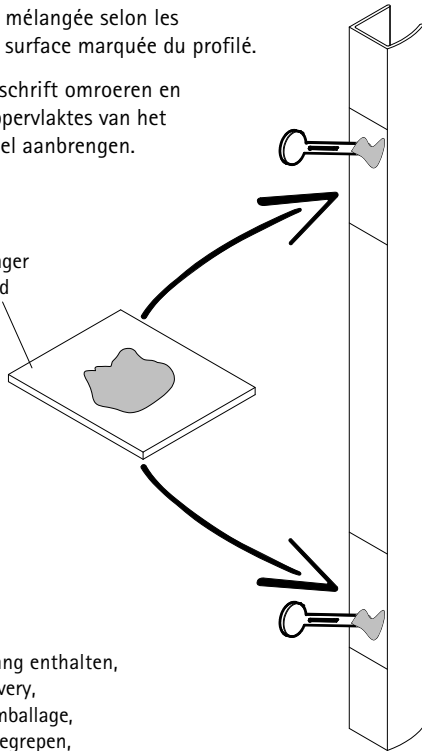

* Nicht im Lieferumfang enthalten,
not included in delivery,
non fourni dans l'emballage,
niet bij levering inbegrepen,

5

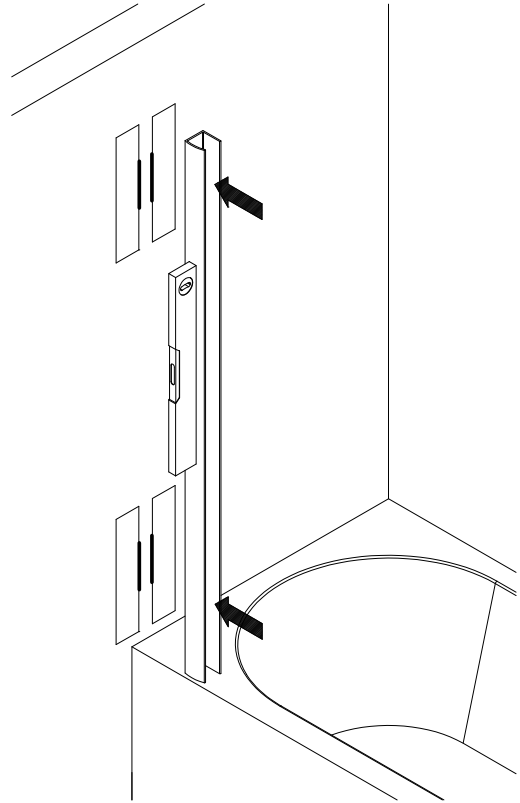

- Profil positionieren und andrücken.
- Position profile and press it onto the wall.
- Positionnez le profilé et appuyez le fortement contre le mur.
- Profiel plaatsen en aandrukken.

6

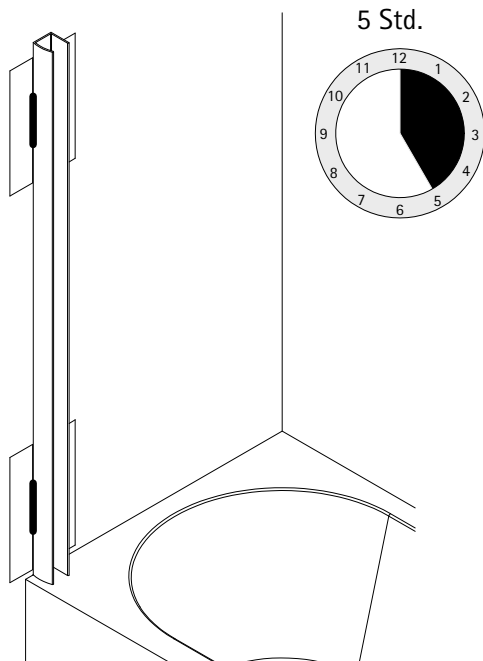

- Nach ca. 5 Stunden kann die Montage der Badewannenfaltwand begonnen werden.
- After approx. 5 hours the bath screen can be installed.
- Après env. 5 heures le montage du pare-baignoire peut démarrer.
- Na 5 uur kan met de montage van de badwand worden gestart.

7

- Überstehenden Kleber entfernen. Profil, innen und aussen, mit Silikon abdichten.
- Remove overlying glue. Seal the profile with silicone on the inside and on the outside
- Enlevez le surplus de la colle. Étancher le profilé avec du silicone à l'intérieur et à l'extérieur
- Restlijm verwijderen. Profiel afdichten met silicone an binnen- en buitenzijde

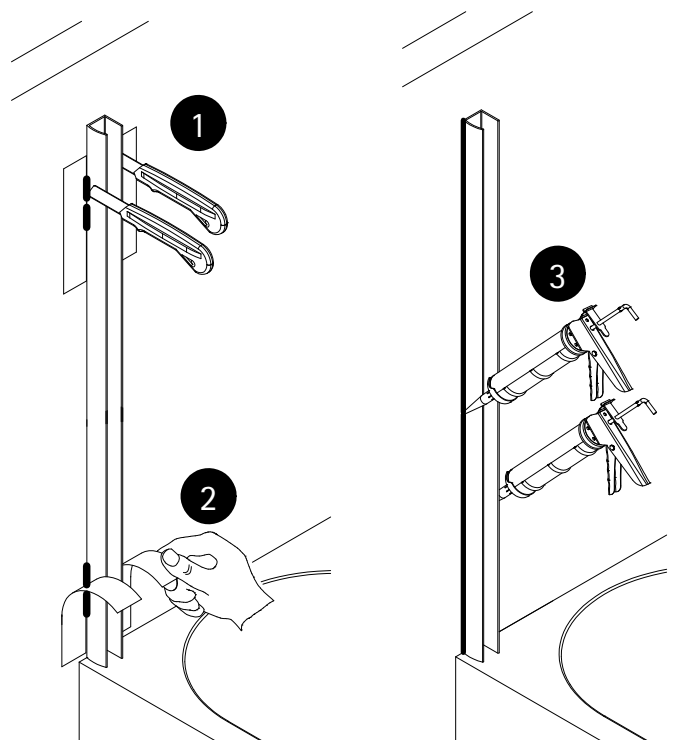



1

Demontage
Disassembly
Démontage
Demontage

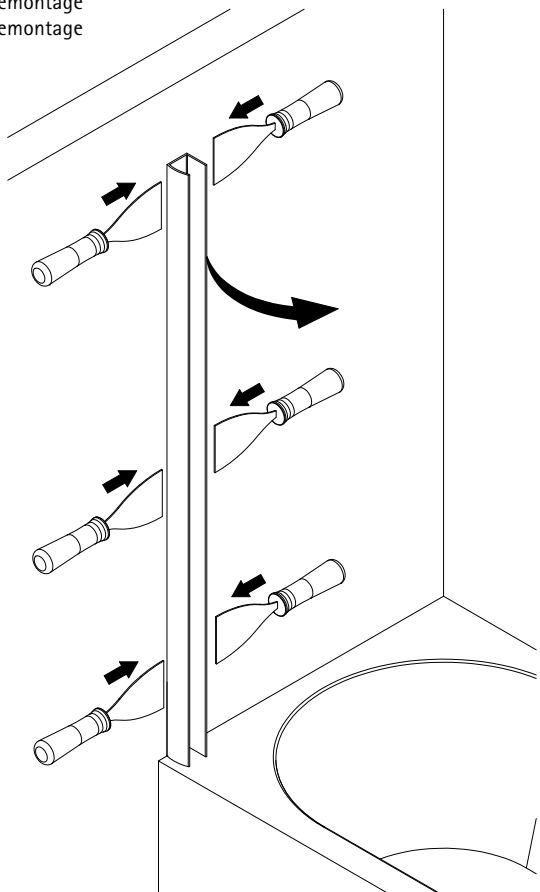

2

-Kleber rückstandslos entfernen
-Removing glue without leaving behind
any residues
-Enlever la colle sans laisser de traces
-Verwijder lijm zonder resten

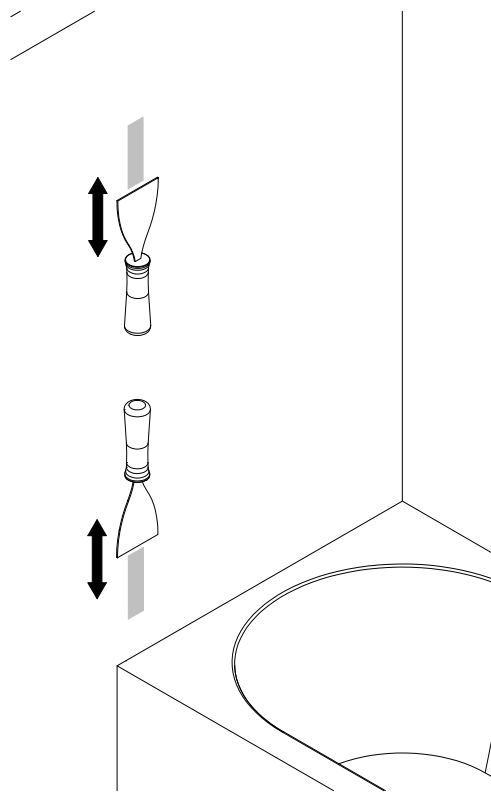

3

- Fläche reinigen
- Clean the surface
- Nettoyer la surface
- Oppervlak reinigen

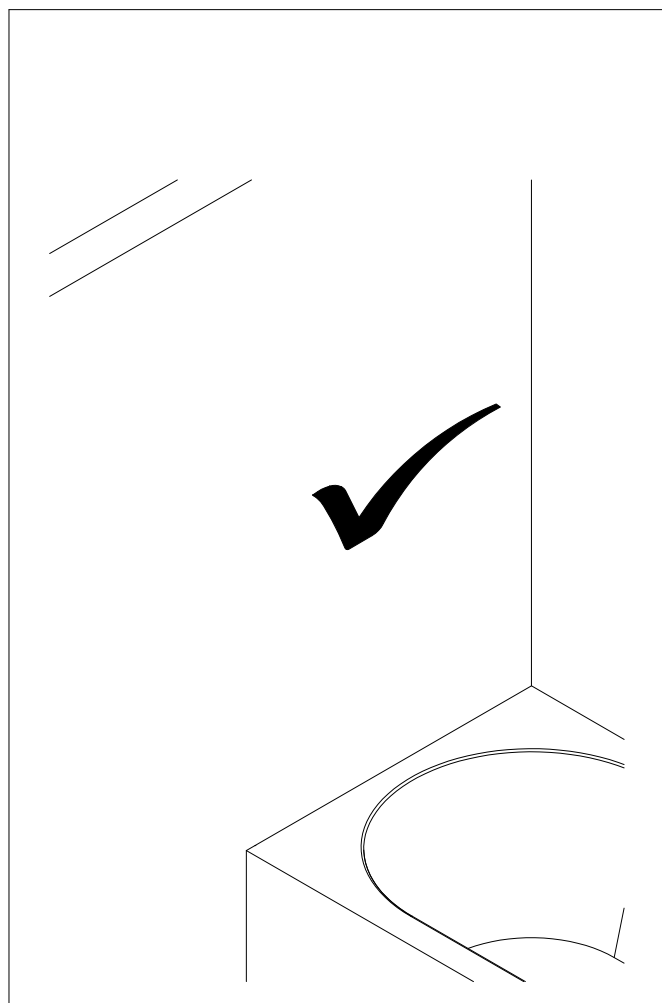
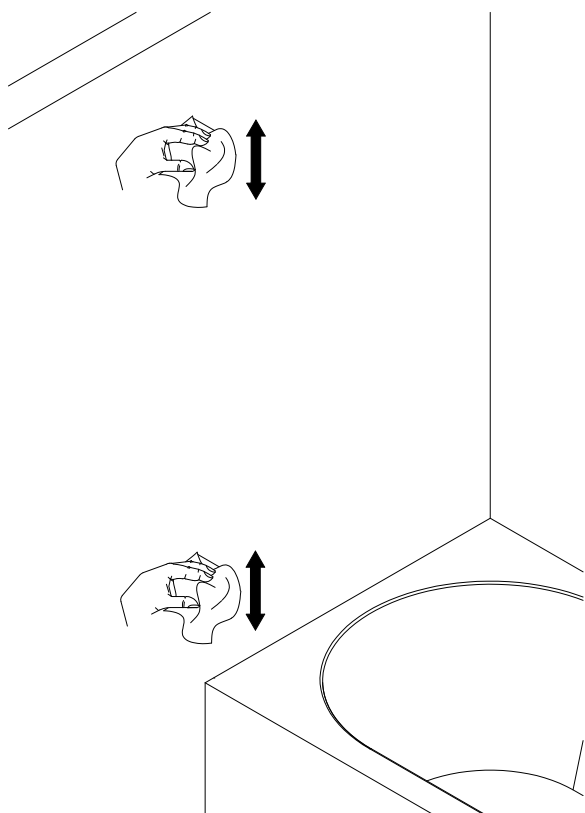

Prüfnummer / Inspection number / Numéro d'essai / Testnummer



Ersatzteilbestellung / spare parts order
commande de pièces de rechange / Bestellung van reserveonderdelen:
Fax 02962 / 972-4260



Technische Hilfe / technical help / l'aide technique / technologische ondersteuning
Telefon 02962 / 972-40



E-Mail:
ersatzteile@duschservice.de



Duschservice
Zum Hohlen Morgen 22
59939 Olsberg
Deutschland / Germany / Allemagne / Duitsland



000059858000000000000000000000